

Robert Bosch GmbH

Power Tools Division
70745 Leinfelden-Echterdingen
Germany

www.bosch-pt.com

2 609 007 771 (2014.02) PS / 275 EURO



2 609 007 771

PFS 3000-2

 **BOSCH**

de Originalbetriebsanleitung
en Original instructions
fr Notice originale
es Manual original
pt Manual original
it Istruzioni originali
nl Oorspronkelijke
gebruiksaanwijzing
da Original brugsanvisning
sv Bruksanvisning i original
no Original driftsinstruks
fi Alkuperäiset ohjeet
el Πρωτότυπο οδηγιών χρήσης

tr Orijinal işletme talimatı
pl Instrukcja oryginalna
cs Původní návod k používání
sk Pôvodný návod na použitie
hu Eredeti használati utasítás
ru Оригинальное руководство
по эксплуатации
uk Оригінальна інструкція з
експлуатації
kk Пайдалану нұсқаулығының
түпнұсқасы
ro Instrucțiuni originale
bg Оригинална инструкция

mk Оригинално упатство за работа
sr Originalno uputstvo za rad
sl Izvirna navodila
hr Originalne upute za rad
et Algupärane kasutusjuhend
lv Instrukcijas oriģinālvalodā
lt Originali instrukcija



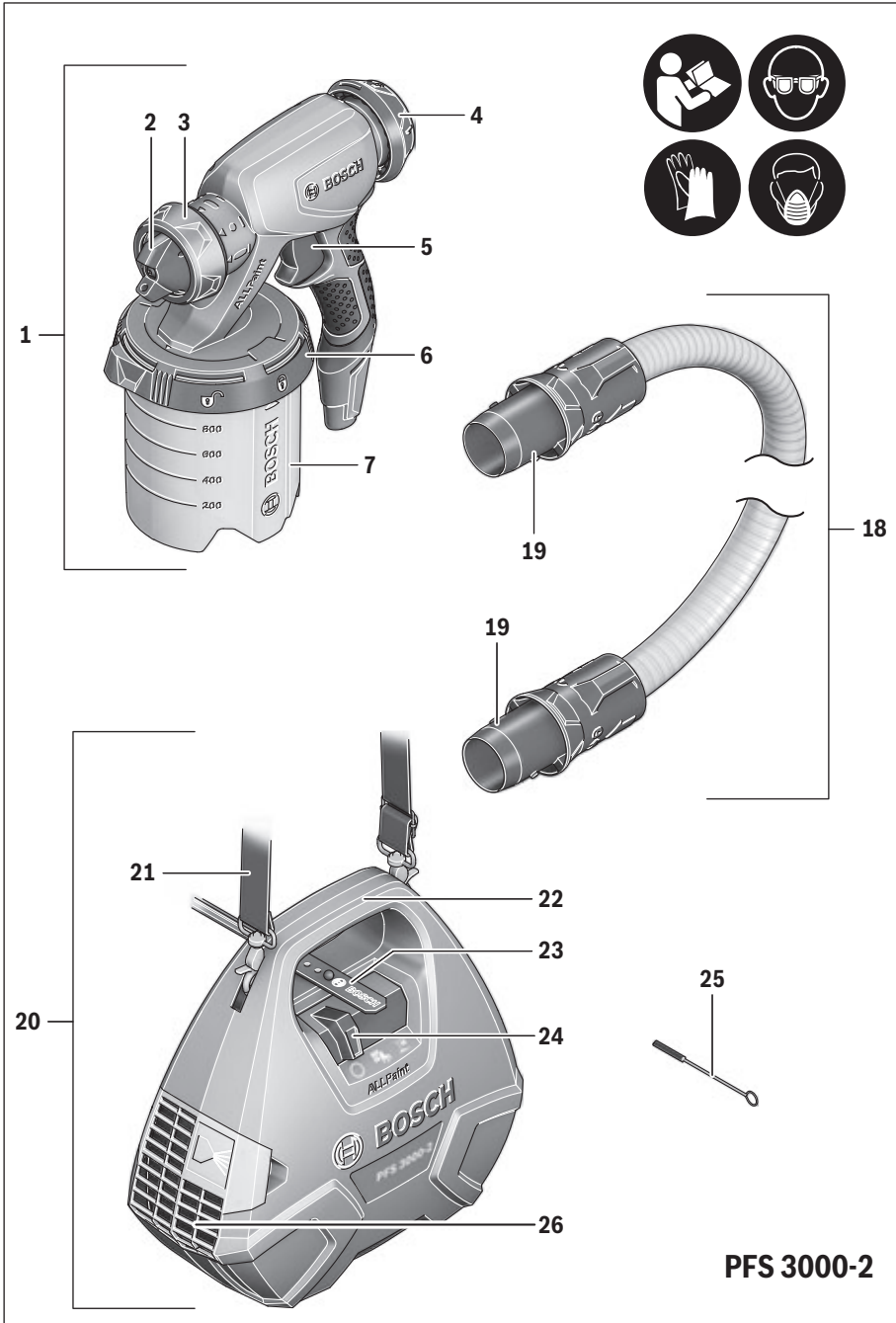

4 |

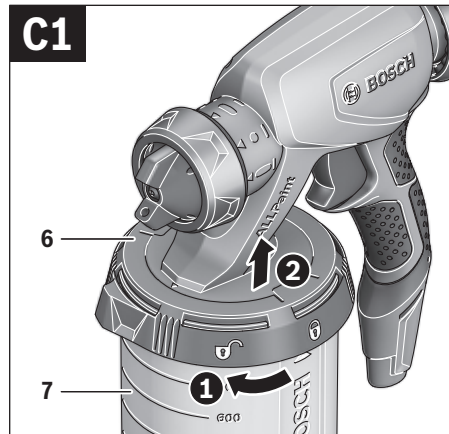
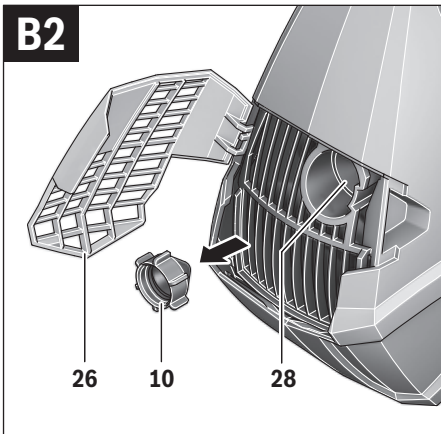
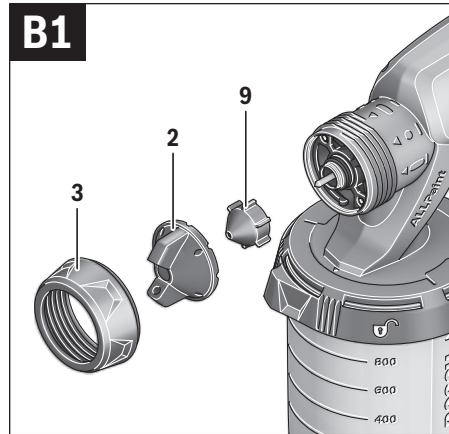
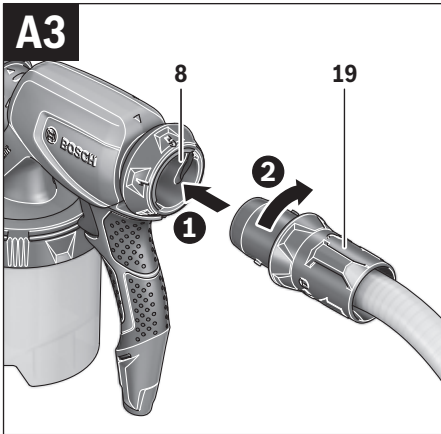
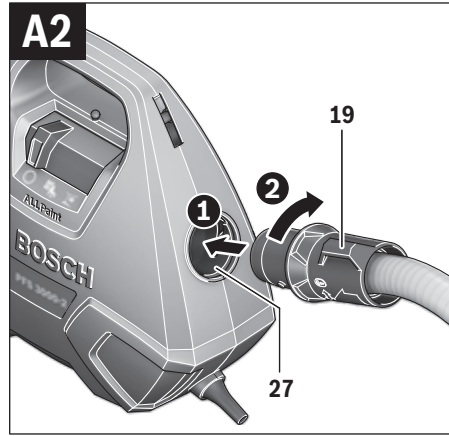
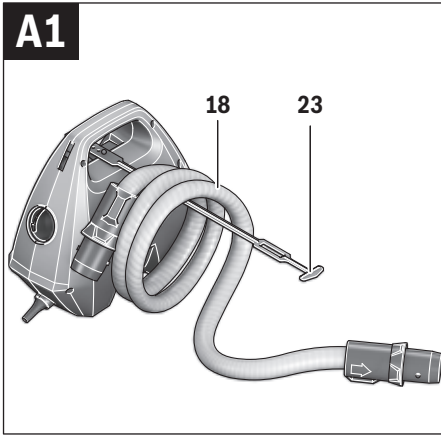

5 |

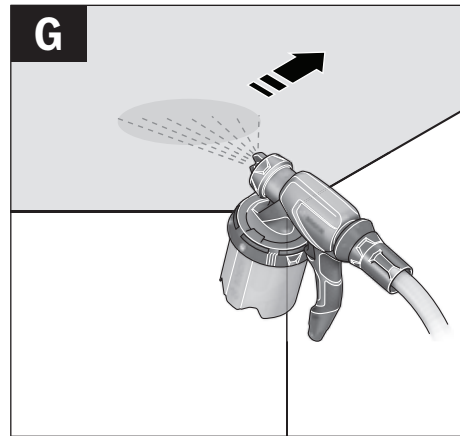
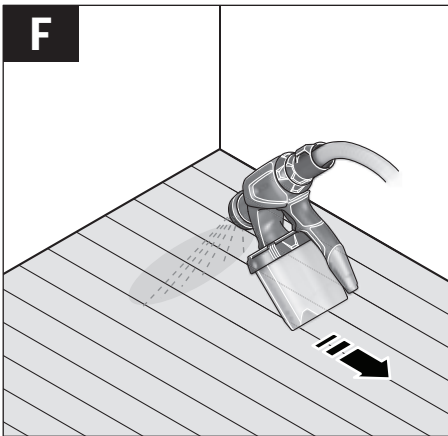
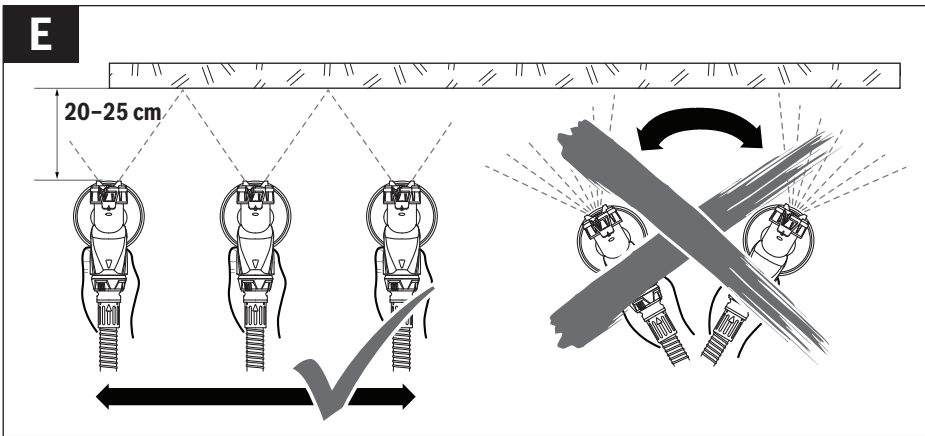
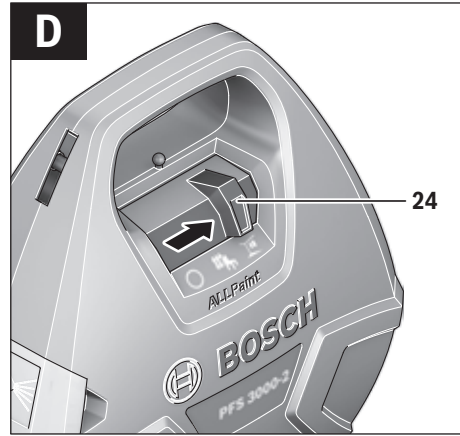
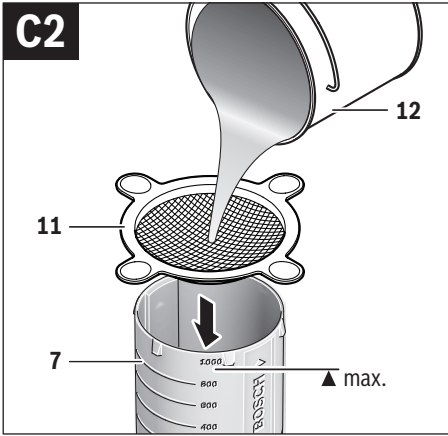

6 |

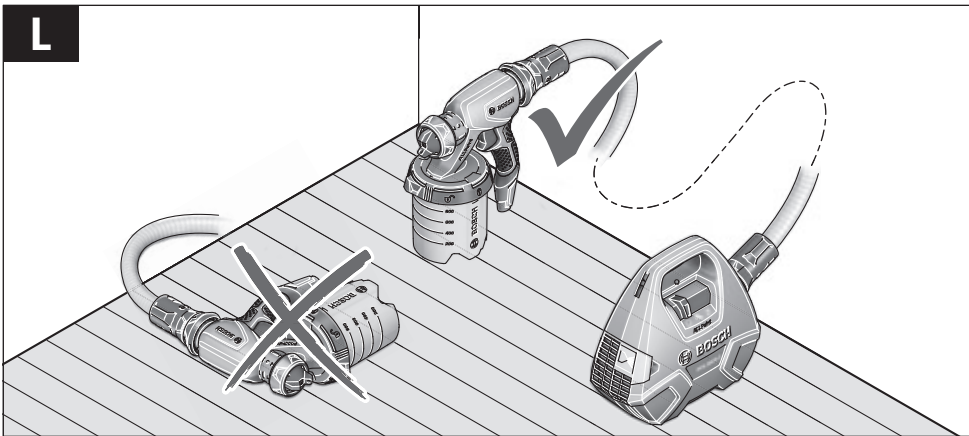
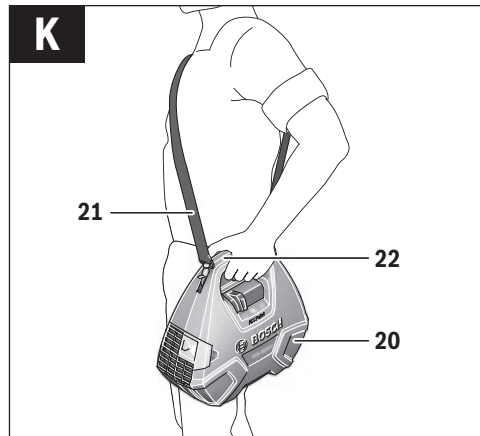
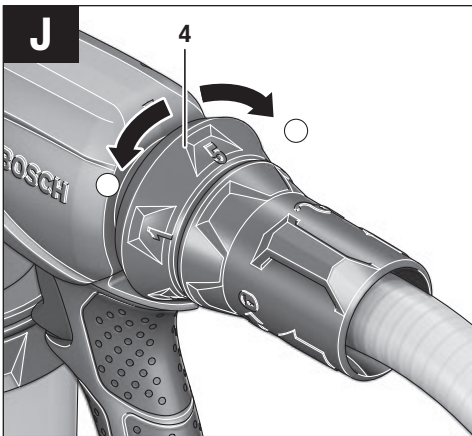
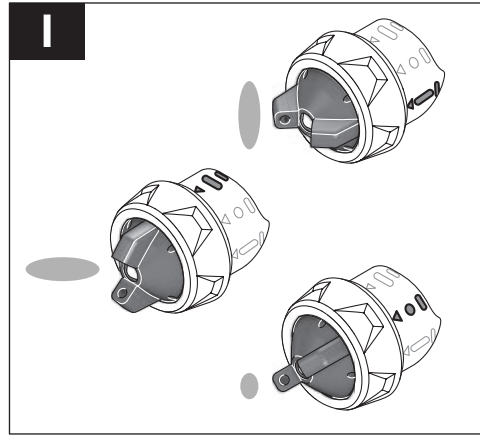
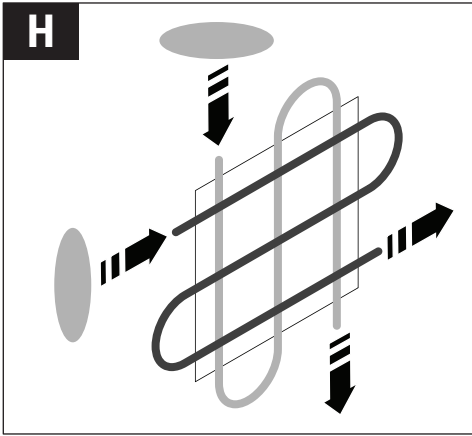

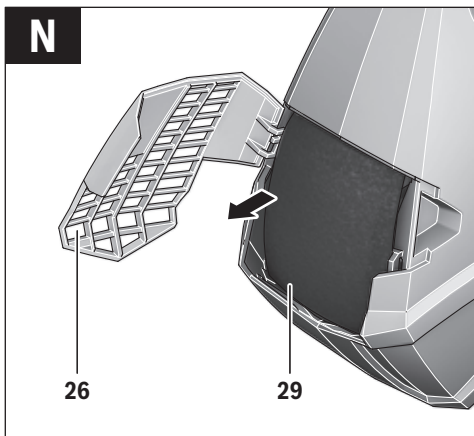
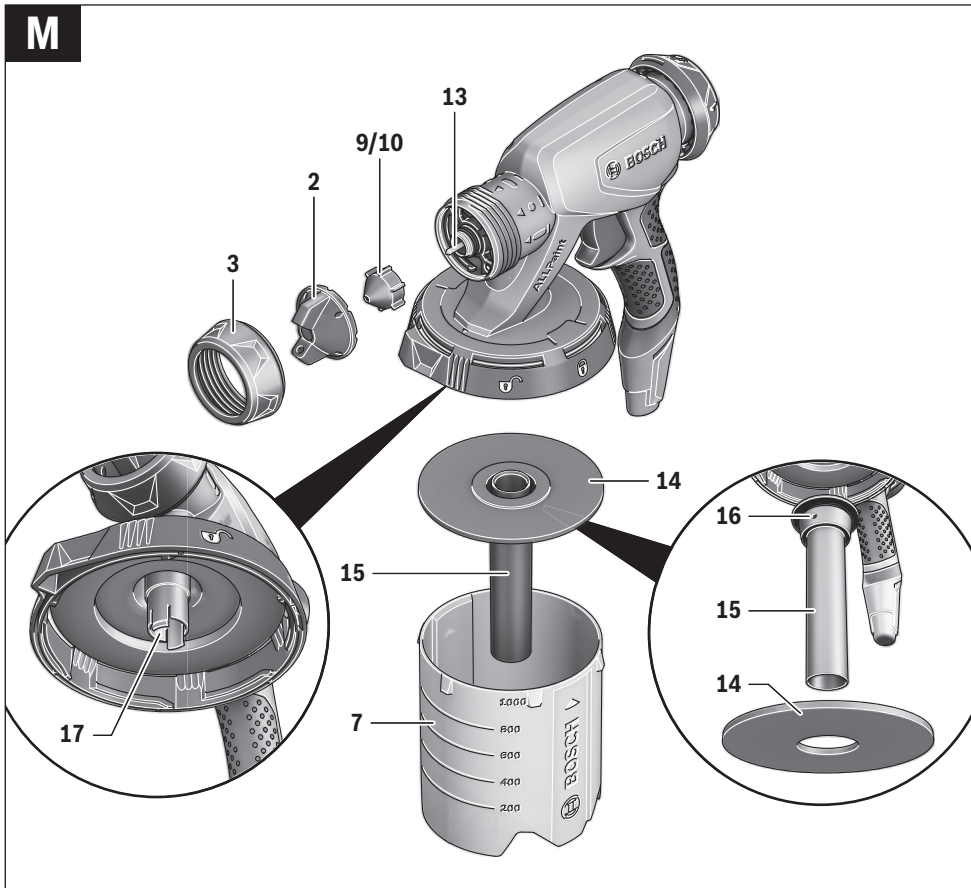

Schweiz

Tel.: (044) 8471511

Fax: (044) 8471551

E-Mail: Aftersales.Service de.bosch.com

Luxemburg

Tel.: 32 2 588 0589

Fax: 32 2 588 0595

E-Mail: outillage.gereedschap be.bosch.com

Entsorgung

Sprühpistole, Elektroeinheit, Zubehör und Verpackungen sollen einer umweltgerechten Wiederverwertung zugeführt werden.

Werfen Sie Elektrowerkzeuge nicht in den Hausmüll

Nur für EU-Länder:

Gemäß der Europäischen Richtlinie 2012/19/EU über Elektro- und Elektronik-Altgeräte und ihrer Umsetzung in nationales Recht müssen nicht mehr gebrauchsfähige Elektrowerkzeuge getrennt gesammelt und einer umweltgerechten Wiederverwertung zugeführt werden.

Änderungen vorbehalten.

English**Safety Notes****General Power Tool Safety Warnings**

⚠ WARNING Read all safety warnings and all instructions. Failure to follow the warnings and instructions may result in electric shock, fire and/or serious injury.

Save all warnings and instructions for future reference.

The term **power tool** in the warnings refers to your mains-operated (corded) power tool or battery-operated (cordless) power tool.

Work area safety

- ▶ **Keep work area clean and well lit.** Cluttered or dark areas invite accidents.
- ▶ **Do not operate power tools in explosive atmospheres, such as in the presence of flammable liquids, gases or dust.** Power tools create sparks which may ignite the dust or fumes.
- ▶ **Keep children and bystanders away while operating a power tool.** Distractions can cause you to lose control.

Electrical safety

- ▶ **Power tool plugs must match the outlet. Never modify the plug in any way. Do not use any adapter plugs with earthed (grounded) power tools.** Unmodified plugs and matching outlets will reduce risk of electric shock.

- ▶ **Avoid body contact with earthed or grounded surfaces, such as pipes, radiators, ranges and refrigerators.**

There is an increased risk of electric shock if your body is earthed or grounded.

- ▶ **Do not expose power tools to rain or wet conditions.** Water entering a power tool will increase the risk of electric shock.
- ▶ **Do not abuse the cord. Never use the cord for carrying, pulling or unplugging the power tool. Keep cord away from heat, oil, sharp edges and moving parts.** Damaged or entangled cords increase the risk of electric shock.
- ▶ **When operating a power tool outdoors, use an extension cord suitable for outdoor use.** Use of a cord suitable for outdoor use reduces the risk of electric shock.
- ▶ **If operating a power tool in a damp location is unavoidable, use a residual current device (RCD) protected supply.** Use of an RCD reduces the risk of electric shock.

Personal safety

- ▶ **Stay alert, watch what you are doing and use common sense when operating a power tool. Do not use a power tool while you are tired or under the influence of drugs, alcohol or medication.** A moment of inattention while operating power tools may result in serious personal injury.
 - ▶ **Use personal protective equipment. Always wear eye protection.** Protective equipment such as dust mask, non-skid safety shoes, hard hat, or hearing protection used for appropriate conditions will reduce personal injuries.
 - ▶ **Prevent unintentional starting. Ensure the switch is in the off-position before connecting to power source and/or battery pack, picking up or carrying the tool.** Carrying power tools with your finger on the switch or engaging power tools that have the switch on invites accidents.
 - ▶ **Remove any adjusting key or wrench before turning the power tool on.** A wrench or a key left attached to a rotating part of the power tool may result in personal injury.
 - ▶ **Do not overreach. Keep proper footing and balance at all times.** This enables better control of the power tool in unexpected situations.
 - ▶ **Dress properly. Do not wear loose clothing or jewelry. Keep your hair, clothing and gloves away from moving parts.** Loose clothes, jewellery or long hair can be caught in moving parts.
 - ▶ **If devices are provided for the connection of dust extraction and collection facilities, ensure these are connected and properly used.** Use of dust collection can reduce dust-related hazards.
- Power tool use and care**
- ▶ **Do not force the power tool. Use the correct power tool for your application.** The correct power tool will do the job better and safer at the rate for which it was designed.
 - ▶ **Do not use the power tool if the switch does not turn it on and off.** Any power tool that cannot be controlled with the switch is dangerous and must be repaired.

18 | English

- ▶ **Disconnect the plug from the power source and/or the battery pack from the power tool before making any adjustments, changing accessories, or storing power tools.** Such preventive safety measures reduce the risk of starting the power tool accidentally.
- ▶ **Store idle power tools out of the reach of children and do not allow persons unfamiliar with the power tool or these instructions to operate the power tool.** Power tools are dangerous in the hands of untrained users.
- ▶ **Maintain power tools. Check for misalignment or binding of moving parts, breakage of parts and any other condition that may affect the power tool's operation. If damaged, have the power tool repaired before use.** Many accidents are caused by poorly maintained power tools.
- ▶ **Keep cutting tools sharp and clean.** Properly maintained cutting tools with sharp cutting edges are less likely to bind and are easier to control.
- ▶ **Use the power tool, accessories and tool bits etc. in accordance with these instructions, taking into account the working conditions and the work to be performed.** Use of the power tool for operations different from those intended could result in a hazardous situation.

Service

- ▶ **Have your power tool serviced by a qualified repair person using only identical replacement parts.** This will ensure that the safety of the power tool is maintained.

Safety Warnings for Fine-spray Systems

- ▶ **Keep area clean, well lit and free of paint or solvent containers, rags, and other flammable materials.** Spontaneous combustion may occur. Fire extinguisher equipment shall be present and working at all times.
- ▶ **Provide for good ventilation in the spraying area and for sufficient fresh air in the complete room.** Evaporating inflammable solvents create an explosive environment.
- ▶ **Do not spray and clean with materials that have a flash point of less than 55 °C. Use materials based on water, non-volatile hydrocarbons or similar materials.** Volatile evaporating solvents create an explosive environment.
- ▶ **Do not spray in the vicinity of ignition sources, such as static electricity sparks, open flames, pilot lights, hot objects, engines/motors, cigarettes and sparks from plugging in or unplugging power cords or operating switches.** Such spark sources can ignite the spraying vicinity/environment.
- ▶ **Do not spray any liquid of unknown hazard potential.** Unknown materials can create hazardous conditions.

- ▶ **Wear additional protective equipment such as appropriate protective gloves and protective masks or respirators when spraying or handling chemicals.** Wearing protective equipment for the appropriate conditions reduces the exposure to hazardous substances.



- ▶ **Be aware of possible hazards from the spray material. Observe the information on drums/tanks/tins as well as manufacturer information of the spray material, including the request to wear personal protective equipment.** The manufacturer's instructions are to be observed in order to reduce the risk of fire as well as injuries caused through toxins, carcinogens, etc.
- ▶ **Keep the plug of the mains cord and the trigger switch of the spray gun clear of paint and other fluids. Never hold the cord by its connectors to support it.** Failure to follow the instruction can lead to electric shock.
- ▶ **Supervise children.** This will ensure that children do not play with the fine-spray system.

Products sold in GB only: Your product is fitted with a BS 1363/A approved electric plug with internal fuse (ASTA approved to BS 1362).

If the plug is not suitable for your socket outlets, it should be cut off and an appropriate plug fitted in its place by an authorised customer service agent. The replacement plug should have the same fuse rating as the original plug.

The severed plug must be disposed of to avoid a possible shock hazard and should never be inserted into a mains socket elsewhere.

Products sold in AUS and NZ only: Use a residual current device (RCD) with a rated residual current of 30 mA or less.

Symbols

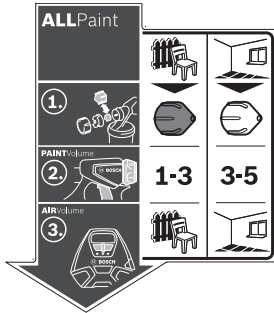

The sticker regarding operation of the fine-spray system is located on the base station. The correct interpretation of the symbols helps you operate the fine-spray system better and more safely.

| Symbols and their meaning | | Detailed description | |
|---|--|---|--|
| <p>The fine-spray system is suitable for glazes and lacquers and for wall paints.</p> | <p>Wood application: Spraying solvent-based and water-dilutable lacquers, glazes, primers, clear lacquers, wood stains and oils</p> | <p>Wall application: Spraying emulsion and latex paints</p> | See Intended Use , page 20. |
| <p>Step 1: Choose the correct nozzle cap</p> | <p>Choose the grey nozzle cap 10 for a wood application</p> | <p>Choose the white nozzle cap 9 for a wall application</p> | See Changing the Nozzle Cap , page 21. |
| <p>Step 2: Set the spraying capacity</p> | <p>1-3</p> <p>Select setting 1, 2 or 3 on the thumbwheel 4 for a wood application</p> | <p>3-5</p> <p>Select setting 3, 4 or 5 on the thumbwheel 4 for a wall application</p> | See Adjusting the Spraying Capacity , page 22. |
| <p>Step 3: Set the air flow</p> | <p>Set wood application on the sliding switch 24</p> | <p>Set wall application on the sliding switch 24</p> | See Adjusting the Air Flow , page 23. |

20 | English

Product Description and Specifications



Read all safety warnings and all instructions. Failure to follow the warnings and instructions may result in electric shock, fire and/or serious injury.

Intended Use

The power tool is only intended for spraying emulsion and latex paints, solvent-based and water-dilutable lacquers, glazes, primers, clear lacquers, wood stains and oils (**ALLPaint**). The power tool is not suitable for spraying caustic solutions, acidic coating materials and house paints.

Product Features

The numbering of the components shown refers to the representation of the power tool on the graphic pages.

- 1 **Spray gun**
- 2 Air cap
- 3 Union nut
- 4 Thumbwheel for spraying capacity
- 5 Trigger switch
- 6 Lock ring
- 7 Container for spray material
- 8 Hose port (spray gun)
- 9 Nozzle cap (white: for a wall application)
- 10 Nozzle cap (grey: for a wood application)
- 11 Filling sieve
- 12 Transfer bucket
- 13 Nozzle needle
- 14 Container seal
- 15 Suction tube
- 16 Ventilation hole
- 17 Paint channel
- 18 **Air hose**
- 19 Bayonet lock
- 20 **Base unit**
- 21 Carrying strap
- 22 Carrying handle
- 23 Elastic band (hose holder)
- 24 Sliding switch for switching on/off and for air flow control
- 25 Cleaning brush
- 26 Air filter cover
- 27 Hose connection (base unit)
- 28 Accessory compartment
- 29 Air filter

*Accessories shown or described are not part of the standard delivery scope of the product. A complete overview of accessories can be found in our accessories program.

Technical Data

| Fine-spray System | PFS 3000-2 | |
|--|---------------|------|
| Article number | 3 603 B07 1.. | |
| Rated power input | W | 650 |
| Spraying capacity | ml/min | 300 |
| Required time for application of paint on 2 m ² | min | 1 |
| Container capacity for spray material | ml | 1000 |
| Length of air hose | m | 2 |
| Weight according to EPTA-Procedure 01/2003 | kg | 3.7 |
| Protection class | □ / II | |
| The values given are valid for a nominal voltage ^U of 230 V. For different voltages and models for specific countries, these values can vary. | | |

Noise/Vibration Information

Measured sound values determined according to EN 60745 and EN 50580.

Typically the A-weighted sound pressure level of the product is 79 dB(A). Uncertainty \hat{S} : 3 dB.

The noise level when working can exceed 80 dB(A).

Wear hearing protection!

Vibration total values a_h (triax vector sum) and uncertainty \hat{S} determined according to EN 60745:
 a_h : 2.5 m/s², \hat{S} : 1.5 m/s².

The vibration level given in this information sheet has been measured in accordance with a standardised test given in EN 60745 and may be used to compare one tool with another. It may be used for a preliminary assessment of exposure. The declared vibration emission level represents the main applications of the tool. However if the tool is used for different applications, with different accessories or insertion tools or is poorly maintained, the vibration emission may differ. This may significantly increase the exposure level over the total working period.

An estimation of the level of exposure to vibration should also take into account the times when the tool is switched off or when it is running but not actually doing the job. This may significantly reduce the exposure level over the total working period.

Identify additional safety measures to protect the operator from the effects of vibration such as: maintain the tool and the accessories, keep the hands warm, organisation of work patterns.

Declaration of Conformity

We declare under our sole responsibility that the product described under Technical Data is in conformity with the following standards or standardization documents: EN 60745 and EN 50580 according to the provisions of the directives 2011/65/EU, 2006/42/EC, 2004/108/EC.

Technical file (2006/42/EC) at:
 Robert Bosch GmbH, PT/ETM9,
 D-70745 Leinfelden-Echterdingen

enk Becker
Executive Vice President
Engineering

elmut einzelmann
Head of Product Certification
PT/ETM9

Robert Bosch GmbH, Power Tools Division
D-70745 Leinfelden-Echterdingen
Leinfelden, 28.02.2014

Assembly

- ▶ **Before any work on the machine itself, pull the mains plug.**
- ▶ **Ensure that the spray gun and base unit are assembled completely and with all seals.** Only this will ensure the function and safety of the fine-spray system.

Connecting the Air Hose (see figures A1 A3)

Open the elastic band **23** and completely unwind the air hose **18**.

Connecting the base unit:

Insert a bayonet lock **19** of the air hose securely into the slots in the base unit port **27** according to the arrow marks. Turn the bayonet lock a quarter turn clockwise.

Connecting to the spray gun:

Insert the second bayonet lock **19** of the air hose securely into the slots in the spray gun port **8** according to the arrow marks.

Turn the bayonet lock a quarter turn clockwise.

Note: Remove the air hose **18** before pouring in spray material (quarter turn of the bayonet lock **19** counterclockwise—pull the bayonet lock **19** out of the port **8**).

Changing the Nozzle Cap (see figures B1 B2)

The fine-spray system is supplied with two nozzle caps:

| | Nozzle cap 9 | Nozzle cap 10 |
|---------------------------|--------------|---|
| Colour | white | grey |
| Delivery condition | Mounted | In the accessory compartment 28 under the air filter cover 26 |
| Application | Wall | Wood |

Note: Check the spray material by stirring it before selecting the nozzle cap. Thin-viscosity material (e.g. wood paint) can be sprayed better with the grey nozzle cap **10**. Thick-viscosity material (e.g. wood lacquer or wall paint) can be sprayed better with the white nozzle cap **9**.

- To change the nozzle cap, unscrew the union nut **3**. Pull off the air cap **2**.
- Unscrew the mounted nozzle cap.
- Open the air filter cover **26** and take the required nozzle cap out of the accessory compartment **28**.
- Screw the required nozzle cap onto the thread in the spray gun.
- Put the air cap **2** on the nozzle cap and tighten it with the union nut **3**.

Operation

- ▶ **Before any work on the machine itself, pull the mains plug.**

Preparing for Operation

- ▶ **Spraying on the sides of water bodies (lakes, rivers, etc.) or neighbouring surfaces in the direct catchment area is not permitted.**

When purchasing paint, varnish and spray material, pay attention to their environmental compatibility.

Preparing the Spray Surface

The spray surface must be clean, dry and grease-free.

Roughen smooth surfaces and then remove the sanding dust.

When spraying, all non-covered surfaces can be soiled by the spray mist. Therefore, thoroughly prepare the area around the surface to be sprayed:

Cover or mask off floors, furnishings, doors, windows as well as door and window frames, etc.

Preparing the Spray Material

Stir the spray material thoroughly.

Dilute the spray material if necessary.

| Spray material | Recommended dilution |
|--|----------------------|
| Wood stains, oils, glazes, impregnations, anti-rust primers | 0 |
| Solvent-dilutable or water-dilutable lacquers, primers, radiator lacquers, thick-coat glazes | 0 10 |
| Emulsion paint, latex paint | 0 10 |

- ▶ **When diluting, pay attention that the spray material and the diluting agent correspond.** When using a faulty diluting agent, lumps can develop that can lead to clogging of the spray gun.
- ▶ **When diluting the spray material, make sure that the flash point of the mixture is above 55 °C again after diluting.** Diluting e.g. solvent-based lacquers lowers the flash point.

Filling in Spray Material (see figures C1 C2)

Note: Remove the air hose **18** before pouring in spray material (quarter turn of the bayonet lock **19** counterclockwise—pull the bayonet lock **19** out of the port **8**).

When using large buckets, pour the spray material into a smaller transfer bucket **12** if necessary (e.g. 10-l wall paint into an empty 2.5 or 5.0-l bucket).

Hold the spray gun in place with one hand and use the other hand to turn the container **7** towards the open symbol.



Pull the spray gun off the container **7**.

If you are using already opened spray material, place the thoroughly cleaned filling sieve **11** on the container **7** to hold back any lumps of paint when pouring in.

22 | English

Pour the spray material into the container **7 up to no more than the 1000 mark**.

Put the spray gun on the container **7**. Turn the container **7** towards the close symbol until you hear the lock ring **6** engage. 

Carry out a test-spray run on a test surface. (see Spraying , page 22)

When the spraying pattern is perfect, start the spray job.
or

When the spraying result is not satisfactory or when no paint comes out, please continue as described under Correction of Malfunctions on page 24.

Starting Operation

- ▶ **Observe the mains voltage!** The voltage of the power source must correspond with the data on the type plate of the machine.
- ▶ **Pay attention that the base unit cannot draw in dust or other contamination during operation.**
- ▶ **Make sure never to spray on the base unit.**
- ▶ **Stop spraying if fluid escapes from places other than the intended nozzle during spraying, and restore the spray gun to its proper condition.** There is a risk of electric shock.
- ▶ **Do not direct the fine-spray system against yourself, other persons or animals.**

Switching On (see figure D)

To save energy, only switch the fine-spray system on when you are using it.

Check whether the correct nozzle cap is mounted (see Changing the Nozzle Cap , page 21).

Plug the mains plug into a socket outlet.

Grasp the spray gun by the handle and point it at the spray surface.

Set the sliding switch **24** to the required application to regulate the air flow (see also Adjusting the Air Flow , page 23).

Pull the trigger switch **5** on the spray gun.

Note: When the base unit is switched on, air always flows out at the nozzle .

Switching Off

Let go of the trigger switch **5** and slide the sliding switch **24** all the way to the left (position **○**).

Pull the mains plug from the socket outlet.

Working Advice

Spraying (see figures E H)

Note: Observe the wind direction when operating the power tool outdoors.

Firstly, carry out a test-spray run and adjust the spray pattern and the spray material quantity according to the spray material. (For adjustments, see the following sections)

Be absolutely sure to hold the spray gun at a consistent distance of 20 – 25 cm perpendicular to the spray object. Begin the spraying procedure outside the target area.

Move the spray gun evenly cross-wise or up-and-down, depending on the spray pattern setting.

An even surface quality is achieved when the paths overlap by 4 – 5 cm.

When spraying horizontal objects or spraying overhead, hold the spray gun at a slight angle and back away from the sprayed surface.

Risk of stumbling! Pay attention to possible obstacles in the room.

Avoid interruptions within the spray surface.

Guiding the spray gun evenly will provide uniform surface quality.

Non-uniform clearance and spray angle lead to heavy formation of paint mist and thus to an uneven surface.

End the spraying procedure outside the target area.







Never completely empty the container for the spray material by spraying. If the suction tube is no longer immersed in the spray material, the spray jet will be interrupted and this will result in an inconsistent surface.

If spray material settles on the air cap **2** or the nozzle cap, clean the components with the supplied cleaning brush **25**.

Adjusting the Spray Pattern (see figure I)

- ▶ **Never actuate the trigger switch 5 while adjusting the air cap 2.**

Turn the air cap **2** to the requested position.

| Air cap | Spray jet pattern | Application |
|---|---|--|
|  |  | Vertical flat jet for horizontal working direction |
|  |  | horizontal flat jet for vertical working direction |
|  |  | Round jet for corners, edges and hard to reach locations |

Adjusting the Spraying Capacity (see figure J)

(PAINT)Volume)

Turn the thumbwheel **4** to set the required spraying capacity:

Settings **1/2/3**: wood application,
settings **3/4/5**: wall application.

Spraying capacity**Adjustment**

Too much material on target area:

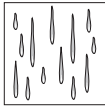

The spraying capacity must be reduced.

Turn down by one setting.

Not enough material on target area:

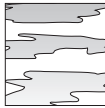

The spraying capacity must be increased.

Turn up by one setting.

Adjusting the Air Flow (see figure D)

(AIRVolume)

Set the sliding switch **24** to the appropriate application to set the correct air flow and pressure for the spray material used.

Off

Wood application

Wall application



Thin-viscosity spray material

Thick-viscosity spray material

Work Breaks and Transport (see figures K L)

A carrying handle **22** and a carrying strap **21** are fitted to the base unit to enable easy transport of the fine-spray system.

You can hang the base unit **20** across your shoulder during work using the carrying strap **21**.

The spray gun **1** can be put down on a flat work surface during breaks. No spray material can leak out.

- ▶ **Always put the spray gun upright on a flat surface when it is filled with spray material.** Spray material can leak out from a spray gun if it is lying down.

Maintenance and Service**Maintenance and Cleaning**

- ▶ **Before any work on the machine itself, pull the mains plug.**
- ▶ **Thoroughly clean the individual parts of the fine-spray system after each use, especially all paint-carrying components.** Proper cleaning is a prerequisite for faultless and safe operation of the spray gun. No warranty claims will be accepted if cleaning has not been done at all or has not been done properly.

If the replacement of the supply cord is necessary, this has to be done by Bosch or an authorized Bosch service agent in order to avoid a safety hazard.

Cleaning (see figure M)

Always clean the spray gun and the container with the respective diluting agent (paint thinner or water) for the spray material being used.

Never clean the nozzle and air holes in the spray gun with pointed objects.

Switch the base unit **20** off.

Remove the air hose **18** both from the base unit **20** and from the spray gun **1** (quarter turn of the bayonet lock **19** counterclockwise—pull the bayonet lock **19** out of the port **8/27**).

Clean the base unit if necessary with a cloth moistened with diluting agent and then remove the base unit **20** and the air hose **18** from the immediate cleaning environment. Press the trigger switch **5** on the spray gun so that the spray material can flow back into the container.

Unscrew the container **7** and empty the remaining spray material back into the original spray material.

Fill the container **7** halfway with the diluting agent (solvent or water) and fit it to the spray gun **1** again.

Shake the spray gun several times.

Unscrew the container **7** and empty the container completely into an empty material tin.

Remove the union nut **3**, the air cap **2**, the nozzle cap used **9/10** and the suction tube **15** with the container seal **14**.

Clean all paint-carrying parts in a bucket with diluting agent using the cleaning brush **25** or a standard washing-up brush.

Also clean the paint channel **17** of the spray gun **1**.

Check if the suction tube **15** and the container seal **14** are free of spray material and undamaged.

If required, clean the container seal **14** again with diluting agent.

Clean the ventilation hole **16** using the cleaning brush **25**. Clean the outside of the container and the spray gun with a cloth moistened in paint thinner.

If required, clean the filling sieve **11** thoroughly with diluting agent.

Before mounting, allow all components to dry thoroughly. Reassemble the fine-spray system in reverse order.

Cleaning the Air Filter (see figure N)

The air filter **29** must be cleaned occasionally. The air filter must be replaced if it is heavily soiled.

Open the air filter cover **26**.

Remove the air filter **29**.

Light soiling:

Tap the air filter **29** to empty it.

or

heavy soiling:

Clean the air filter **29** under running water and then leave it dry thoroughly to prevent mould from forming.

or

Replace the air filter **29**.

Reinsert the air filter.

Close the air filter cover **26** again.

24 | English

Material Disposal

Diluting agent and remainders of spray material must be disposed of in an environmentally-friendly manner. Observe the manufacturer's disposal information and the local regulations for disposal of hazardous waste.



Chemicals harmful to the environment may not be disposed of into soil, groundwater or bodies of water. Never pour chemicals harmful to the environment into the sewerage system

Storage

Thoroughly clean the fine-spray system before you put it into storage and remove the container **7** from the spray gun **1**.

Correction of Malfunctions

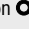
| Problem | Cause | Corrective Measure |
|--|---|---|
| Spray material does not cover properly | Spraying capacity too low | Turn the thumbwheel 4 towards setting 5 |
| | Clearance to target area too large | Reduce spray distance |
| | Not enough spray material on target area, too few spray paths sprayed over target area | Apply more spray paths over target area |
| | Spray material too viscous | Dilute the spray material again and carry out a test-spray run |
| Spray material runs off after coating | Too much spray material applied | Turn the thumbwheel 4 towards setting 1 |
| | Clearance to target area too close | Increase spray distance |
| | Viscosity of spray material too low | Add original spray material |
| | Spray material applied too often over same spot | Remove spray material—reduce number of spray paths over same spot |
| Atomisation too coarse | Spraying capacity too high | Turn the thumbwheel 4 towards setting 1 |
| | Air flow too low | Slide the sliding switch 24 to the right |
| | White nozzle cap 9 mounted (nozzle diameter too large) | Mount the grey nozzle cap 10 |
| | Nozzle needle 13 soiled | Clean nozzle needle |
| | Spray material too viscous | Dilute the spray material again and carry out a test-spray run |
| | Air filter 29 heavily soiled | Changing the Air Filter |
| Excessive paint mist | Too much spray material applied | Turn the thumbwheel 4 towards setting 1 |
| | Air flow too high | Slide the sliding switch 24 to the left |
| | Clearance to spray surface too large | Reduce spray distance |
| Spray jet pulsates | Not enough spray material in container | Refill spray material |
| | Ventilation hole 16 on suction tube 15 clogged | Clean the suction tube and the ventilation hole |
| | Suction tube 15 loose | Insert suction tube properly |
| | Nozzle cap 9/10 loose | Tighten the nozzle cap 9/10 |
| | Air filter 29 heavily soiled | Change the air filter |
| | Spray material too viscous | Dilute the spray material again and carry out a test-spray run |
| Spray material drips from the nozzle | Deposit of spray material on the nozzle, the nozzle needle 13 and the air cap 2 | Clean the nozzle, nozzle needle and air cap |
| | Nozzle loose | Tighten the nozzle cap 9/10 |

| Problem | Cause | Corrective Measure |
|---|---|--|
| No spray material emerges from the nozzle | Sliding switch 24 is in position  | Set the sliding switch 24 to wood or wall application |
| | No pressure build-up in container 7 | Turn the container 7 towards the close symbol until you hear the lock ring 6 engage   |
| | Suction tube 15 loose | Insert suction tube properly |
| | Nozzle needle 13 clogged | Clean nozzle needle |
| | Suction tube 15 clogged | Clean suction tube |
| | Ventilation hole 16 on suction tube 15 clogged | Clean the suction tube and the ventilation hole |
| | Container seal 14 missing or damaged | Slide a (new) container seal over the suction tube into the groove |
| | Spray material too viscous | Dilute the spray material again and carry out a test-spray run |
| | Spray material dirty (lumps of paint) | Completely empty and clean the spray gun-pour the spray material through the filling sieve when filling |

After-sales Service and Application Service

In all correspondence and spare parts orders, please always include the 10-digit article number given on the type plate of the fine-spray system.

Our after-sales service responds to your questions concerning maintenance and repair of your product as well as spare parts. Exploded views and information on spare parts can also be found under:

www.bosch-pt.com

Bosch's application service team will gladly answer questions concerning our products and their accessories.

Great Britain

Robert Bosch Ltd. (B.S.C.)

P.O. Box 98

Broadwater Park

North Orbital Road

Denham

Uxbridge

UB 9 5

At www.bosch-pt.co.uk you can order spare parts or arrange the collection of a product in need of servicing or repair.

Tel. Service: (0844) 7360109

E-Mail: boschservicecentre@bosch.com

Ireland

Origo Ltd.

Unit 23 Magna Drive

Magna Business Park

City West

Dublin 24

Tel. Service: (01) 4666700

Fax: (01) 4666888

Australia, New Zealand and Pacific Islands

Robert Bosch Australia Pty. Ltd.

Power Tools

Locked Bag 66

Clayton South VIC 3169

Customer Contact Center

Inside Australia:

Phone: (01300) 307044

Fax: (01300) 307045

Inside New Zealand:

Phone: (0800) 543353

Fax: (0800) 428570

Outside AU and NZ:

Phone: 61 3 95415555

www.bosch.com.au

Republic of South Africa

Customer service

otline: (011) 6519600

Gauteng BSC Service Centre

35 Roper Street, New Centre

Johannesburg

Tel.: (011) 4939375

Fax: (011) 4930126

E-Mail: bsctools@icon.co.za

KZN BSC Service Centre

Unit E, Almar Centre

143 Crompton Street

Pinetown

Tel.: (031) 7012120

Fax: (031) 7012446

E-Mail: bsc.dur@za.bosch.com