

# Datasheet

## Full face mask

Protection against Gas, Vapour & Dust



### Series 9000

#### size S



**9001** EasyLock® connector

**9004** EN 148-1 connector

#### size M



**9002** EasyLock® connector

**9005** EN 148-1 connector

#### size L



**9003** EasyLock® connector

**9006** EN 148-1 connector

#### CHARACTERISTICS

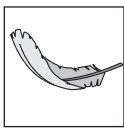

**Extremely lightweight**  
due to frameless construction technology.



**Panoramic lens**  
Made of polycarbonate.

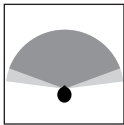

**Periphery vision side panels**  
Gives unimpeded perception of surrounding environment and movements.

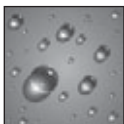

**Special hydrophobic coating for easy cleaning**  
The face shield is liquid-repellent, easy to wipe and resistant to solvents.



**Easy to clean. Easy maintenance.**  
Due to easily accessible components and a clear design and surfaces. No tools needed.



**EasyLock® Filtersystem**  
No additional parts needed.



**100% PVC-FREE**  
All Moldex products and packaging are 100% PVC-free.

#### CERTIFICATION

The Moldex 9000 Series meet the requirements of EN 136:1998 CL2 and are CE-marked in accordance with the requirements of European Directive 89/686/EEC. The Institut für Arbeitsschutz IFA (BGIA) in St. Augustin (0121) in Germany is the body responsible for both type examination (article 10) and monitoring of production (article 11). The products are manufactured in an ISO 9001:2000 certified plant.

#### MATERIAL

**Face shield:** Polycarbonate  
**Mask body:** Thermoplastic Elastomere (TPE)  
**Head Harness:** Thermoplastic Elastomere (TPE)  
**Valve cover:** Polypropylene (PP)  
**Inhalation valve:** Natural rubber  
**Exhalation valve:** Silicone rubber

#### WEIGHT

**9001:** 370 g      **9002:** 360 g      **9003:** 355 g  
**9004:** 375 g      **9005:** 365 g      **9006:** 360 g

#### EASYLOCK®

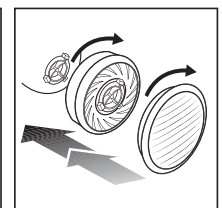
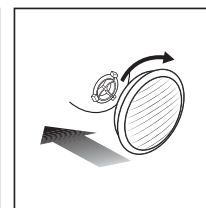
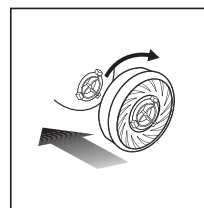

#### Gas filters

Article	Type of filter
9100	A1
9200	A2
9300	ABE1
9400	ABEK1
9500	A2B2E1
9600	AX

#### Particulate filters

Article	Type of filter
9010	P1 R
9020	P2 R
9030	P3 R

#### Pre-assembled filter combinations

Article	Type of filter
9120	A1P2 R
9230	A2P3 R
9430	ABEK1P3 R

# Datasheet

## Full face mask

Protection against Gas, Vapour & Dust



### TESTING

The respirators of the Moldex 9000 Series have been tested to EN 136:1998 Cl2 and fulfill all requirements of the relevant categories.

#### Inward leakage of face piece

Ten test subjects wearing respirators perform a variety of exercises on a treadmill. During the exercises the amount of test aerosol that penetrates the face seal and exhalation valve are sampled. The inward leakage of the test contaminant must not exceed a value of 0,05% with any of the test subjects during all exercises performed.

#### Flammability

Face pieces are passed through a 950°C (+50°C) for 5 seconds at a distance of 250 mm from 6 burner nozzles. After passing through the flame the facepieces have to self-extinguish.

#### Tensile strength

The connection between mask body and filter has to withstand a maximum tensile force of 500 N.

#### Mechanical strength

The lens has to withstand the impact of a steel ball that has a diameter of 22 mm and falls on the lens from a height of 1,3 m. After the impact on the lens, the seal of the full face mask has to be maintained.

### SPARE PARTS

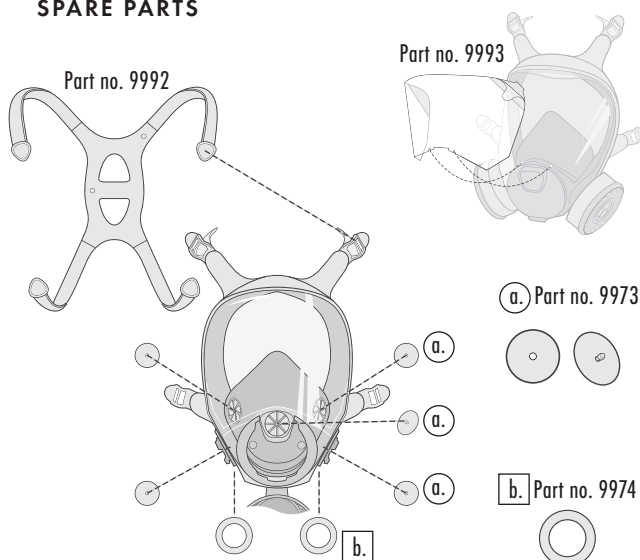

Part no.	Description	Part no.	Description
9973	Diaphragm kit	9993	Faceshield protector
9974	Gaskets for EasyLock® connectors	9992	Head Harness
9975	Gaskets for EN 148-1 connectors	9998	Spectacle kit

### INSTRUCTIONS FOR FITTING

#### Easy On and Off

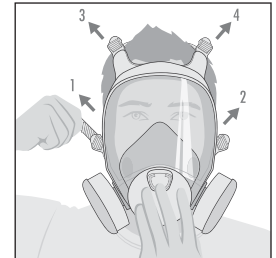
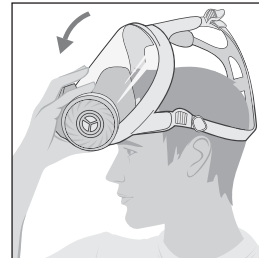

#### CHECK OF FACESEAL

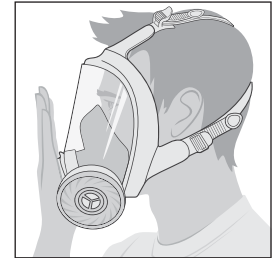

### IMPORTANT INFORMATION FOR USERS

- This breathing apparatus does not supply oxygen (O<sub>2</sub>)
- The product does not contain any metallic parts that could cause ignition in potentially explosive atmospheres.
- If you have any questions about how to use the product, please contact MOLDEX-METRIC.
- You must also observe the relevant rules and regulations when using respiratory equipment.
- Under certain circumstances, individuals with beards, long sideburns or other anomalies in the area around the sealing lines, may be unable to achieve a properly sealing fit.
- The masks must not be modified in anyway.
- Read the instruction manual before using the mask. Failure to comply with these instructions on how to use the product and failure to wear the respiratory protection in the polluted area may negatively impact on the health of the user and lead to permanent injury.
- **Caution: Do not use filter equipment in unventilated containers and confined spaces.**

### INFO

For help on selection and training please contact us. We offer a wide range of training packages and support material.

MOLDEX-METRIC AG & Co. KG  
Unit 9, Glaisdale Point  
Off Glaisdale Drive, Bilborough  
Nottingham. NG8 4GP

Tel.: +44 (0)115 985 4288  
Fax: +44 (0)115 985 4211  
info@uk.moldex-europe.com  
www.moldex-europe.com