

Bei Fragen zu unseren Symbolen, besuchen sie folgende Webseite:  
 If you have any questions about our signs, visit the following website:  
[www.rzb.de/fileadmin/assets/downloads/PDF/RZB\\_Symbolklaerung.pdf](http://www.rzb.de/fileadmin/assets/downloads/PDF/RZB_Symbolklaerung.pdf)

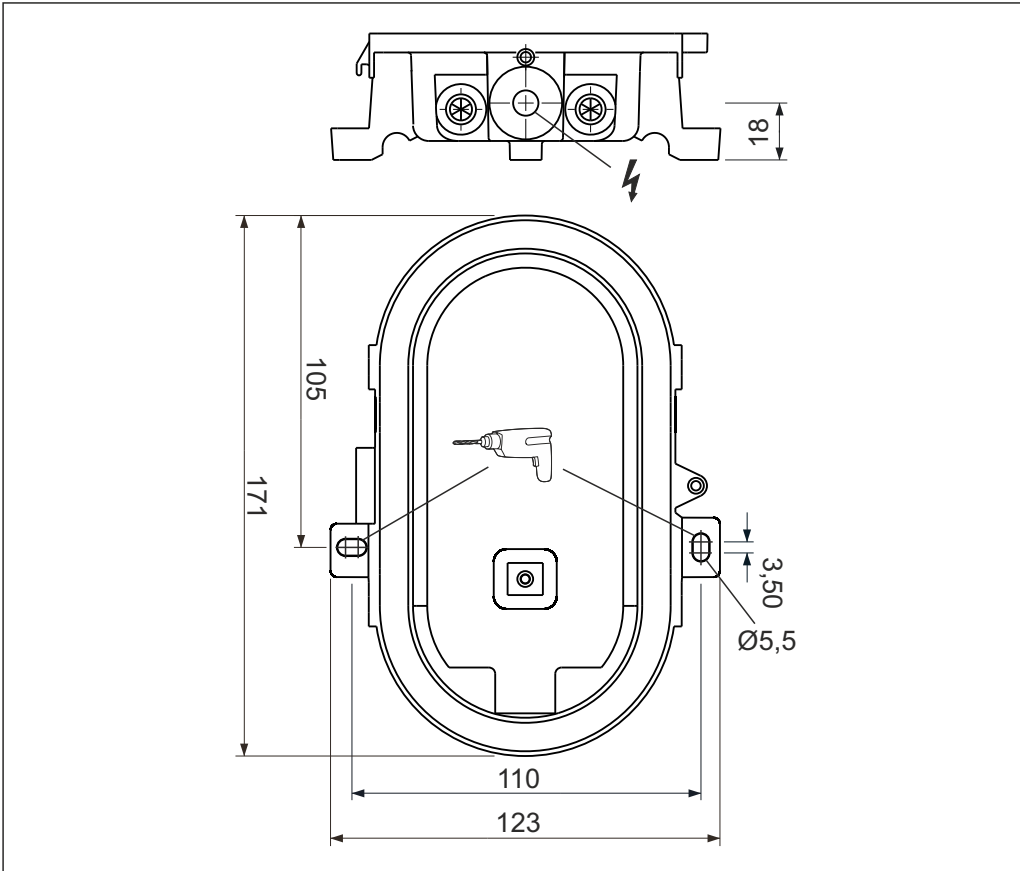

RZB - Rudolf Zimmermann, Bamberg GmbH

Rheinstraße 16  
 96052 Bamberg

Telefon: 0951/7909-0  
 Telefax: 0951/7909-198

E-mail: [info@rzb-leuchten.de](mailto:info@rzb-leuchten.de)

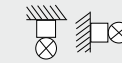

≈ 220 - 240 V

50/60 Hz

IP 43 /44

IK 04



3 x 1,5 mm<sup>2</sup>



2,50 mm<sup>2</sup>

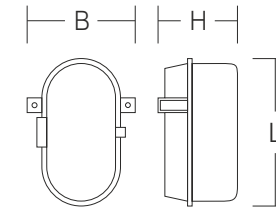
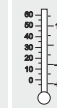

501044.009

L 171, B 123, H 70

450 g



LED



8,5 W



8,5 W



740lm

CCT 4000 K

CRI 80



A+



A+



27



43



45



73



INSTRUCTION  
 WARTUNGSPLAN/  
 MAINTENANCE  
 SCHEDULE



DIN EN 61340-5-1



EN 12464  
 EN 13201

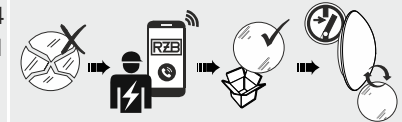

EN 12464

EN 13201



<100%

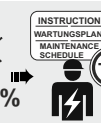

100%

EN 12464

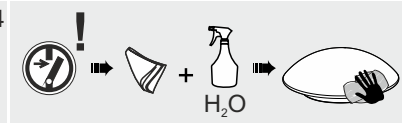

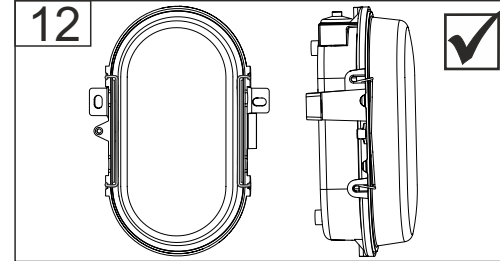
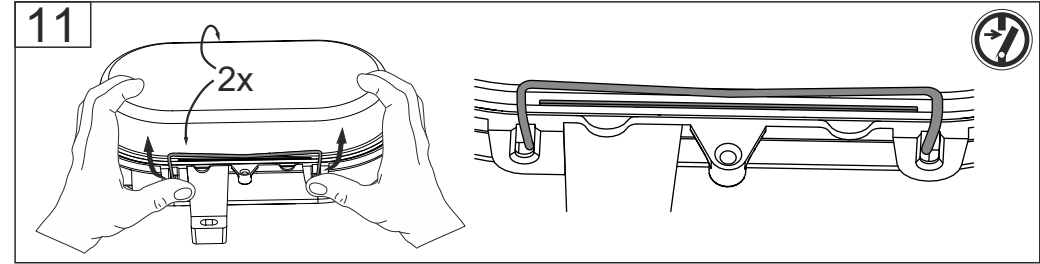
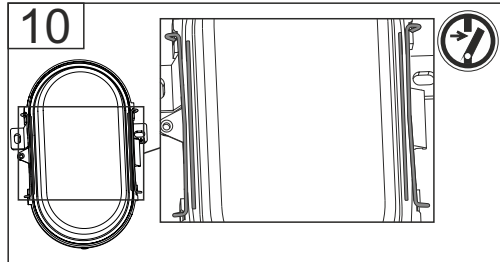
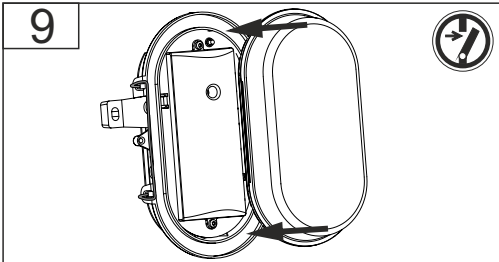
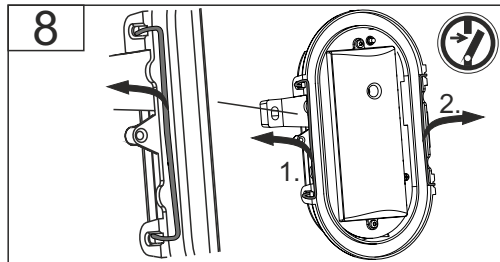
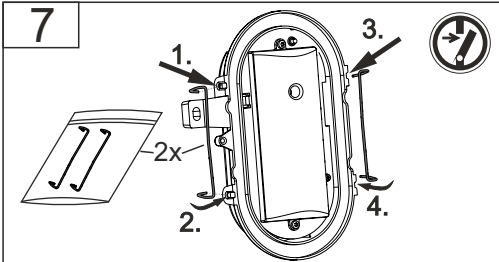
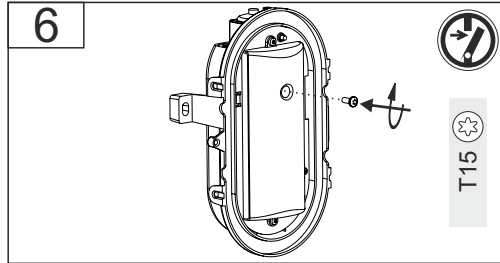
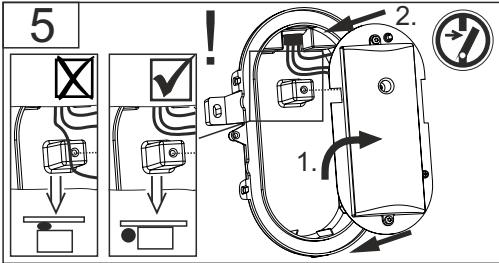
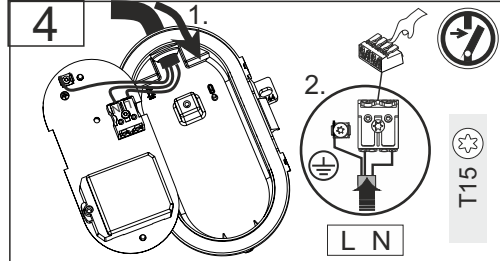
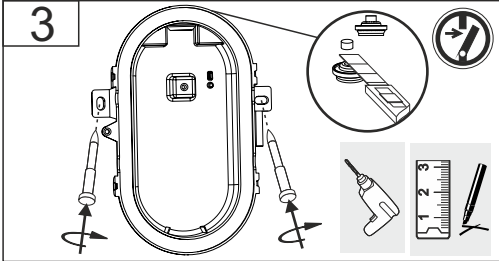
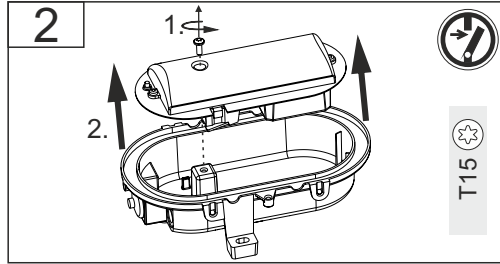
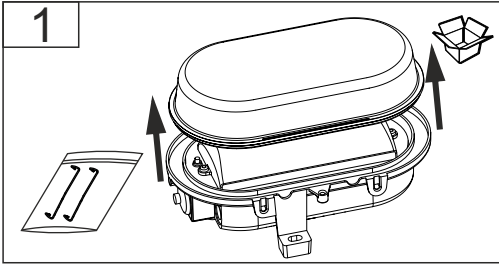
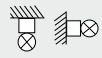

		1 2 3 [mm]	
	05-501044.000	165x90x34,5	208 g