



DIGITAL ANGLE FINDER

74307 INSTRUCTION MANUAL



IMPORTANT: PLEASE READ THESE INSTRUCTIONS CAREFULLY TO ENSURE THE SAFE AND EFFECTIVE USE OF THIS PRODUCT.



Technical Specifications	
Accuracy	0.15°
Resolution	0.05°
Working Range	0° - 360°
Power Supply	CR2032 3V lithium battery
Working temperature	32°F to 122°F (0°C to 50°C)
Working humidity	≤85%

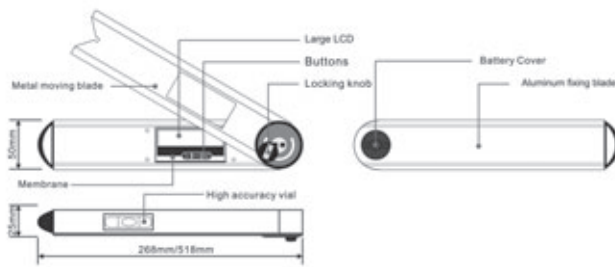

INSTRUCTION OF BUTTON AND LCD

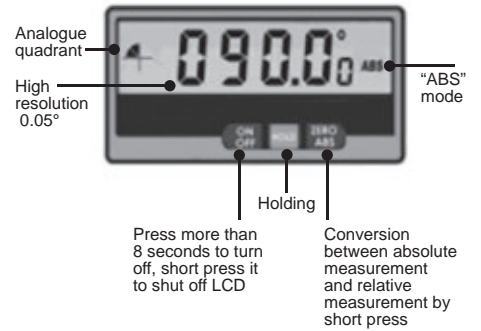

LOCKING POSITION RELATING WITH MEASURING RANGE

Making different measuring range by locking at four different locking holes

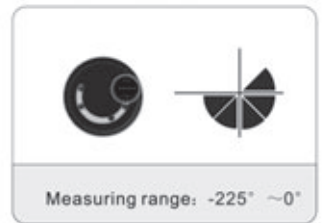
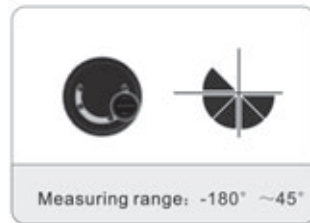
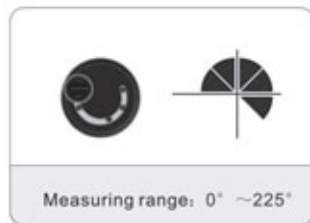

INSTRUCTION OF ANALOGUE QUADRANT FOR MOVING BLADE



Analogue quadrant resolution: 45°
Display range of analogue quadrant: 360°

ABS SETTING

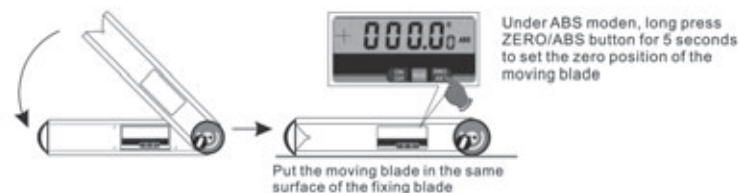

Under "ABS" mode:
(1) automatic record the original ZERO position after power off
(2) display always reads upright

APPLICATION OF HIGH QUALITY LEVEL VIAL



Notices

- Clean the angle finder with mild liquid soap and a damp cloth, never immerse in water.
- Always use 3v Lithium battery
- Don't mark the bar with an electric engraver and scratch it.

Note: The measuring range could reach 360° after screw off the locking knob

Helpline: +44 (0) 23 8049 4344 Sales Desk: +44 (0) 23 8049 4333 General Enquiries: +44 (0) 23 8026 6355
drapertools.com email: sales@drapertools.com