

CONTACTS

Draper Tools Limited, Hursley Road,
Chandler's Ford, Eastleigh, Hampshire. SO53 1YF. U.K.

Help line: (023) 8049 4344

Sales Desk: (023) 8049 4333

Internet: drapertools.com

E-mail: sales@drapertools.com

General Enquiries: (023) 8026 6355

Service/Warranty Repair Agent:

For aftersales servicing or warranty repairs, please contact the
Draper Tools Help line for details of an agent in your local area.

YOUR DRAPER STOCKIST

TAKC0419

©Published by Draper Tools Limited.

No part of this publication may be reproduced, stored in a retrieval system or transmitted in any form or by any means, electronic, mechanical photocopying, recording or otherwise without prior permission in writing from Draper Tools Ltd.



230V

ROUTER

83612



These instructions accompanying the product are the original instructions. This document is part of the product, keep it for the life of the product passing it on to any subsequent holder of the product. Read all these instructions before assembling, operating or maintaining this product.

This manual has been compiled by Draper Tools describing the purpose for which the product has been designed, and contains all the necessary information to ensure its correct and safe use. By following all the general safety instructions contained in this manual, it will ensure both product and operator safety, together with longer life of the product itself.

All photographs and drawings in this manual are supplied by Draper Tools to help illustrate the operation of the product.

Whilst every effort has been made to ensure the accuracy of information contained in this manual, the Draper Tools policy of continuous improvement determines the right to make modifications without prior warning.

1. TITLE PAGE

1.1 INTRODUCTION:

USER MANUAL FOR: 230V Router

Stock No: 83612

Part No: R1200D

1.2 REVISIONS:

Date first published April 2019.

As our user manuals are continually updated, users should make sure that they use the very latest version.

Downloads are available from: <http://drapertools.com/manuals>

Draper Tools Limited
Hursley Road
Chandler's Ford
Eastleigh
Hampshire
SO53 1YF
UK

Website: drapertools.com

Product help line: +44 (0) 23 8049 4344

General Fax: +44 (0) 23 8026 0784

1.3 UNDERSTANDING THIS MANUALS SAFETY CONTENT:

WARNING! – Information that draws attention to the risk of injury or death.

CAUTION! – Information that draws attention to the risk of damage to the product or surroundings.

1.4 COPYRIGHT © NOTICE:

Copyright © Draper Tools Limited.

Permission is granted to reproduce this publication for personal and educational use only. Commercial copying, redistribution, hiring or lending is prohibited.

No part of this publication may be stored in a retrieval system or transmitted in any other form or means without written permission from Draper Tools Limited.

In all cases this copyright notice must remain intact.

13. EXPLANATION OF SYMBOLS

13.1 EXPLANATION OF SYMBOLS



Read the instruction manual.



Wear face mask and safety glasses.



Wear ear defenders.



Wear protective gloves.



Do not abandon into the environment.



Keep out of the reach of children.



Warning!



Single value noise marking.
(Maximum declared A-Weighted sound power level in decibels).



Class II construction
(Double insulated).



WEEE –
Waste Electrical & Electronic Equipment.
Do not dispose of Waste Electrical & Electronic Equipment in with domestic rubbish.



Lithium-ion product.

Li-ion



Do not incinerate or throw onto fire.



For indoor use only.
Do not expose to rain.



Short-circuit-proof safety isolating transformer.



Fuse.



Polarity indication.



Rated voltage.

12. DISPOSAL

12.1 DISPOSAL

- At the end of the machine's working life, or when it can no longer be repaired, ensure that it is disposed of according to national regulations.
- Contact your local authority for details of collection schemes in your area.

In all circumstances:

- Do not dispose of power tools with domestic waste.
- Do not incinerate.
- Do not dispose of WEEE* as unsorted municipal waste.



* *Waste Electrical & Electronic Equipment.*

2. CONTENTS

- 1. TITLE PAGE
 - 1.1 INTRODUCTION 2
 - 1.2 REVISION HISTORY 2
 - 1.3 UNDERSTANDING THIS MANUAL 2
 - 1.4 COPYRIGHT NOTICE 2
- 2. CONTENTS
 - 2.1 CONTENTS 3
- 3. WARRANTY
 - 3.1 WARRANTY 4
- 4. INTRODUCTION
 - 4.1 SCOPE 5
 - 4.2 SPECIFICATION 5
 - 4.3 HANDLING & STORAGE 5
- 5. HEALTH AND SAFETY INFORMATION
 - 5.1 GENERAL POWER TOOL SAFETY WARNINGS 6-7
 - 5.2 SPECIFIC SAFETY INSTRUCTIONS FOR ROUTER USE 7
 - 5.3 RESIDUAL RISK 7
 - 5.4 CONNECTION TO THE POWER SUPPLY 8
- 6. TECHNICAL DESCRIPTION
 - 6.1 IDENTIFICATION 9
- 7. UNPACKING AND CHECKING
 - 7.1 PACKAGING 10
 - 7.2 WHAT'S IN THE BOX 10
- 8. PREPARING THE ROUTER
 - 8.1 PARALLEL GUIDE FENCE 11
 - 8.2 DUST EXTRACTION PORT 11
 - 8.3 DUST EXTRACTION 11
 - 8.4 FACE SHIELD 11
 - 8.5 FITTING & REPLACING ROUTER BITS 12
- 9. BASIC ROUTER OPERATIONS
 - 9.1 TRIGGER SWITCH 13
 - 9.2 VARIABLE SPEED DIAL 13
 - 9.3 SETTING THE CUTTING DEPTH 13-14
 - 9.4 PARALLEL GUIDE ROUTING 14
 - 9.5 28MM INNER - 30MM OUTER DIAMETER TEMPLATE FOLLOWER 14
 - 9.6 PIVOT ROD TRAMMEL 15
- 10. MAINTENANCE AND TROUBLESHOOTING
 - 10.1 TROUBLESHOOTING 16
 - 10.2 TROUBLESHOOTING 16
- 11. OPTIONAL ACCESSORIES
 - 11.1 OPTIONAL ACCESSORIES 17
- 12. DISPOSAL
 - 12.1 DISPOSAL 18
- 13. EXPLANATION OF SYMBOLS
 - 13.1 EXPLANATION OF SYMBOLS 19

DECLARATION OF CONFORMITY ENCLOSED

3. WARRANTY

3.1 WARRANTY

Draper tools have been carefully tested and inspected before shipment and are guaranteed to be free from defective materials and workmanship.

Should the tool develop a fault, please return the complete tool to your nearest distributor or contact

Draper Tools Limited, Chandler's Ford, Eastleigh, Hampshire, SO53 1YF. England.

Telephone Sales Desk: (023) 8049 4333 or Product Help Line (023) 8049 4344.

A proof of purchase **must** be provided with the tool.

If upon inspection it is found that the fault occurring is due to defective materials or workmanship, repairs will be carried out free of charge. This warranty period covering labour is 12 months from the date of purchase except where tools are hired out when the warranty period is 90 days from the date of purchase. The warranty is extended to 24 months for parts only. This warranty does not apply to any consumable parts, any type of battery or normal wear and tear, nor does it cover any damage caused by misuse, careless or unsafe handling, alterations, accidents, or repairs attempted or made by any personnel other than the authorised Draper warranty repair agent.

Note: If the tool is found not to be within the terms of warranty, repairs and carriage charges will be quoted and made accordingly.

This warranty applies in lieu of any other warranty expressed or implied and variations of its terms are not authorised.

Your Draper warranty is not effective unless you can produce upon request a dated receipt or invoice to verify your proof of purchase within the warranty period.

Please note that this warranty is an additional benefit and does not affect your statutory rights.

Draper Tools Limited.

11. OPTIONAL ACCESSORIES

11.1 OPTIONAL ACCESSORIES

A full range of accessories are available from Draper Tools.

Please visit our website for details: **www.drapertools.com**

10. MAINTENANCE AND TROUBLESHOOTING

10.1 TROUBLESHOOTING

Regular inspection and cleaning reduces the necessity for maintenance operations and will keep your tool in good working condition.

The motor must be correctly ventilated during tool operation. For this reason avoid blocking the air inlets. After use disconnect the tool from the power supply and vacuum the ventilation slots.

If the replacement of the supply cord is necessary, this has to be done by the manufacturer or his agent in order to avoid a safety hazard.

Remove the plug from the socket before carrying out adjustment, servicing or maintenance.

10.2 TROUBLESHOOTING

Note: Remove the plug from the socket before carrying out adjustment, servicing or maintenance.

Problem	Cause	Remedy
Machine does not start.	<ol style="list-style-type: none">1. Blown fuse.2. Brushes worn.3. Other.	<ol style="list-style-type: none">1. Replace time delay fuse or reset circuit breaker.2. Have brushes replaced by an authorised service centre.3. Contact an authorised service centre.
Machine vibrates.	<ol style="list-style-type: none">1. Router bit not suitable for application.2. Router bit blunt.3. Incorrect direction of travel.	<ol style="list-style-type: none">1. Seek guidance on bit selection.2. Stop machine. When stopped, replace with a sharp bit.3. Change direction of travel.
Bit will not cut.	<ol style="list-style-type: none">1. Attempting to remove excess material.2. Router bit blunt3. Incorrect direction of travel	<ol style="list-style-type: none">1. Reduce plunge depth.2. Stop machine. When stopped, replace with a sharp bit3. Change direction of travel

4. INTRODUCTION

4.1 SCOPE

This hand held power tool is ideal for shaping woodwork, cabinetry, architrave, mortising and other associated routing work.

As part of our core range, this product is suitable for enthusiasts and tradespeople alike. Any application other than that it was intended for, is considered misuse.

4.2 SPECIFICATION

Stock No.	83612
Part No.	R1200D
Rated voltage	230V~50Hz
Rated input	1200W
Collets	1/4" & 5/16"
Cutter Capacity	30mm
Plunge Stroke:	
with Dust Extraction	0-38mm
without Dust Extraction	0-50mm
Speed (no load)	10,000-30,000r/min
Sound pressure level (LpA)*:	84dB(A)
Sound power level (LWA)**:	95dB(A)
Uncertainty (K):	3dB(A)
Vibration level Main handle†:	3.61m/s ² , K=1.5m/s ²
Weight (machine only):.....	3.63kg

†When sawing in wood.

* Continuous A-Weighted Sound Pressure Level at the workstation in accordance to and declared according to EN60745.

** The typical A-weighted noise level determined according to EN60745

4.3 HANDLING & STORAGE

- Care must be taken when handling this product.
 - Dropping this power tool could have an effect on its accuracy and could also result in personal injury. This product is not a toy and must be respected.
- Environmental conditions can have a detrimental effect on this product if neglected.
 - Exposure to damp air can gradually corrode components.
 - If the product is unprotected from dust and debris, components will become clogged.
 - If not cleaned and maintained correctly or regularly, the machine will not perform at its best..

5. HEALTH AND SAFETY INFORMATION

5.1 GENERAL POWER TOOL SAFETY WARNINGS

WARNING Read all safety warnings, instructions, illustrations and specifications provided with this power tool. *Failure to follow all instructions listed below may result in electric shock, fire and/or serious injury.*

Save all warnings and instructions for future reference.

The term "power tool" in the warnings refers to your mains-operated (corded) power tool or battery-operated (cordless) power tool.

Work area safety

Keep work area clean and well lit. *Cluttered or dark areas invite accidents.*

Do not operate power tools in explosive atmospheres, such as in the presence of flammable liquids, gases or dust. *Power tools create sparks which may ignite the dust or fumes.*
Keep children and bystanders away while operating a power tool. *Distractions can cause you to lose control.*

Electrical safety

Power tool plugs must match the outlet. Never modify the plug in any way. Do not use any adapter plugs with earthed (grounded) power tools. *Unmodified plugs and matching outlets will reduce risk of electric shock.*

Avoid body contact with earthed or grounded surfaces, such as pipes, radiators, ranges and refrigerators. *There is an increased risk of electric shock if your body is earthed or grounded.*
Do not expose power tools to rain or wet conditions. *Water entering a power tool will increase the risk of electric shock.*

Do not abuse the cord. Never use the cord for carrying, pulling or unplugging the power tool. Keep cord away from heat, oil, sharp edges or moving parts. *Damaged or entangled cords increase the risk of electric shock.*

When operating a power tool outdoors, use an extension cord suitable for outdoor use. *Use of a cord suitable for outdoor use reduces the risk of electric shock.*

If operating a power tool in a damp location is unavoidable, use a residual current device (RCD) protected supply. *Use of an RCD reduces the risk of electric shock.*

Personal safety

Stay alert, watch what you are doing and use common sense when operating a power tool. Do not use a power tool while you are tired or under the influence of drugs, alcohol or medication. *A moment of inattention while operating power tools may result in serious personal injury.*

Use personal protective equipment. Always wear eye protection. *Protective equipment such as a dust mask, non-skid safety shoes, hard hat or hearing protection used for appropriate conditions will reduce personal injuries.*

Prevent unintentional starting. Ensure the switch is in the off-position before connecting to power source and/or battery pack, picking up or carrying the tool. *Carrying power tools with your finger on the switch or energising power tools that have the switch on invites accidents.*

Remove any adjusting key or wrench before turning the power tool on. *A wrench or a key left attached to a rotating part of the power tool may result in personal injury.*

Do not overreach. Keep proper footing and balance at all times. *This enables better control of the power tool in unexpected situations.*

Dress properly. Do not wear loose clothing or jewellery. Keep your hair and clothing away from moving parts. *Loose clothes, jewellery or long hair can be caught in moving parts.*

If devices are provided for the connection of dust extraction and collection facilities, ensure these are connected and properly used. *Use of dust collection can reduce dust-related hazards.*
Do not let familiarity gained from frequent use of tools allow you to become complacent and ignore tool safety principles. *A careless action can cause severe injury within a fraction of a second.*

Power tool use and care

9. BASIC ROUTER OPERATIONS

Note: Remove the plug from the socket before carrying out adjustment, servicing or maintenance.

9.6 PIVOT ROD TRAMMEL

Secure one of the parallel guide rods into the rear channel. Remove the rod locking knob (13) from the front channel and secure it into the additional rod locking point. Loosen the wing nut and slide the trammel (24) on to the rod end. Adjust the point height to suit before locking the wing nut. Adjust the distance between the router bit and pivot point.

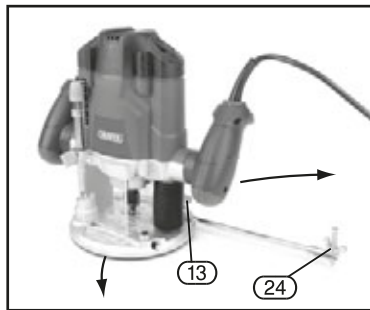

FIG.11

9. BASIC ROUTER OPERATIONS

lower section is under the adjustment rod and repeat previous step. Continue with this pattern until the lowest part of the turret has been used in the same fashion and your cut should be complete and have a good finish. If further material needs to be removed, lock the router in the downward position and using the fine adjustment control to add to the cut depth (one turn equals 1mm) unlock plunge and push down to new adjusted level and cut again, until your cut is at the required depth.

Note: Ensure you travel in the correct direction, this is marked on the casting above the spindle stop mechanism, if in doubt when going around the outside of a shape you should travel in an anticlockwise direction, if going around the inside of a shape you should travel in a clockwise direction.

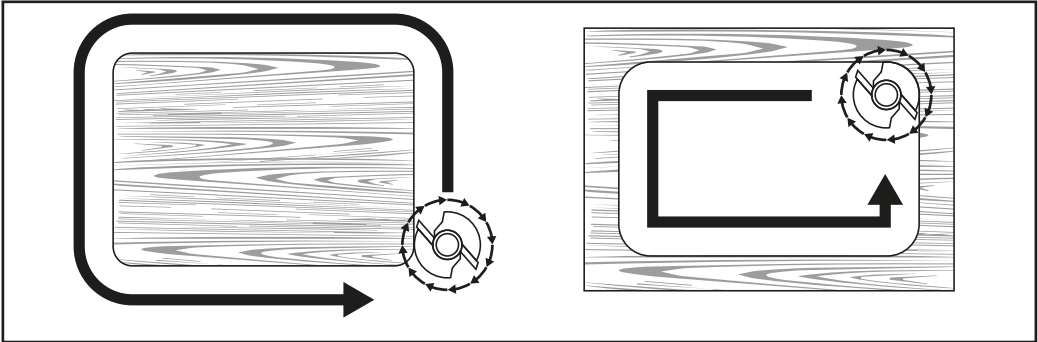

FIG.8

9.4 PARALLEL GUIDE ROUTING

Ensure the edge along which the guide is going to travel is smooth and true as any inconsistencies will translate into the cut.

Pass the parallel guide rods through the four points in the router's base and secure in place with lock knobs (13).

When using the parallel guide an even pressure should be applied to each face except on a leading/trailing edge of a workpiece. When leading on to a workpiece apply the pressure to the forward face until both faces are on. When trailing off a workpiece apply the pressure to the rear face until the cut is complete.

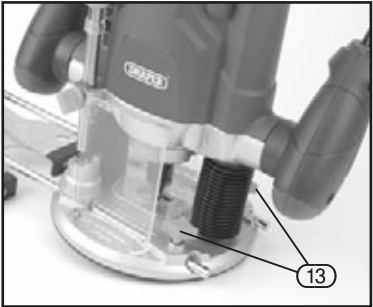

FIG.9

9.5 28MM INNER - 30MM OUTER DIAMETER TEMPLATE FOLLOWER

For detailed information on templates refer to a routing/woodworking book.

Lay the template follower (19) into the recess. Ensure the template follower faces downward and secure with the two countersunk screws (12).

Warning: Whilst this router is capable of cutting kitchen worktops, it should be noted that this is not a professional machine and therefore its tolerances and performance are not as accurate as a professional machine.

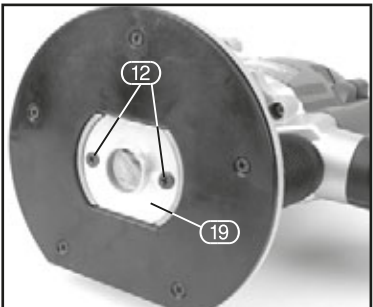

FIG.10

5. HEALTH AND SAFETY INFORMATION

Do not force the power tool. Use the correct power tool for your application. *The correct power tool will do the job better and safer at the rate for which it was designed.*

Do not use the power tool if the switch does not turn it on and off. *Any power tool that cannot be controlled with the switch is dangerous and must be repaired.*

Disconnect the plug from the power source and/or remove the battery pack, if detachable, from the power tool before making any adjustments, changing accessories, or storing power tools. *Such preventive safety measures reduce the risk of starting the power tool accidentally.*

Store idle power tools out of the reach of children and do not allow persons unfamiliar with the power tool or these instructions to operate the power tool. *Power tools are dangerous in the hands of untrained users.*

Maintain power tools and accessories. Check for misalignment or binding of moving parts, breakage of parts and any other condition that may affect the power tool's operation. If damaged, have the power tool repaired before use. *Many accidents are caused by poorly maintained power tools.*

Keep cutting tools sharp and clean. *Properly maintained cutting tools with sharp cutting edges are less likely to bind and are easier to control.*

Use the power tool, accessories and tool bits etc. in accordance with these instructions, taking into account the working conditions and the work to be performed. *Use of the power tool for operations different from those intended could result in a hazardous situation.*

Keep handles and grasping surfaces dry, clean and free from oil and grease. *Slippery handles and grasping surfaces do not allow for safe handling and control of the tool in unexpected situations.*

Service

Have your power tool serviced by a qualified repair person using only identical replacement parts. *This will ensure that the safety of the power tool is maintained.*

5.2 SPECIFIC SAFETY INSTRUCTIONS FOR ROUTER USE

Hold the power tool by insulated gripping surfaces only, because the cutter may contact its own cord.

Cutting a "live" wire may make exposed metal parts of the power tool "live" and could give the operator an electric shock.

Use clamps or another practical way to secure and support the workpiece to a stable platform.

Holding the work by your hand or against the body leaves it unstable and may lead to loss of control.

Ensure you use the correct router bits with this machine

Correct router bit selection includes making sure the speed rating of the bit matches or exceeds that of the machine,

The router bit is the correct shank size for the collet (do not attempt to use 6mm router bits in the 6.35mm / 1/4" collet)

The router bit itself is sharp, free from chips or damage and designed for cutting the intended material which for this machine is wood or wood products.

5.3 RESIDUAL RISK

Important note: Although the safety instructions and operating manuals for our tools contain extensive instructions for safe working with power tools, every power tool involves a certain residual risk which can not be completely excluded by safety mechanisms. Power tools must therefore always be operated with caution!

5. HEALTH AND SAFETY INFORMATION

5.4 CONNECTION TO THE POWER SUPPLY

Caution: Risk of electric shock. Do not open.

This appliance is supplied with a moulded 3 pin mains plug for your safety. The value of the fuse fitted is marked on the pin face of the plug. Should the fuse need replacing, ensure the substitute is of the correct rating, approved to BS1362 and ASTA or BSI Kite marked.

ASTA 

BSI 

The fuse cover is removable with a small plain slot screwdriver. Ensure the fuse cover is replaced before attempting to connect the plug to an electrical outlet. If the cover is missing, a replacement must be obtained or the plug replaced with a suitable type.

If a replacement plug is to be fitted this must be carried out by a qualified electrician.

The damaged or incomplete plug, when cut from the cable should be disabled to prevent connection to a live electrical outlet.

This appliance is Class II[†] and is designed for connection to a power supply matching that detailed on the rating label and compatible with the plug fitted.

If an extension lead is required, use an approved and compatible lead rated for this appliance. Follow all the instructions supplied with the extension lead.

[†]*Double insulated : This product requires no earth connection as supplementary insulation is applied to the basic insulation to protect against electric shock in the event of failure of the basic insulation.*

IMPORTANT

If using an extension lead, follow the instructions that came with your lead regarding maximum load while cable is wound. If in doubt, ensure that the entire cable is unwound. Using a coiled extension lead will generate heat which could melt the lead and cause a fire.

9. BASIC ROUTER OPERATIONS

Note: Remove the plug from the socket before carrying out adjustment, servicing or maintenance.

9.1 TRIGGER SWITCH

The router is fitted with a safety lock off switch to prevent accidental starting. Press and hold lock button (3). Pull trigger (2) and the router will start.

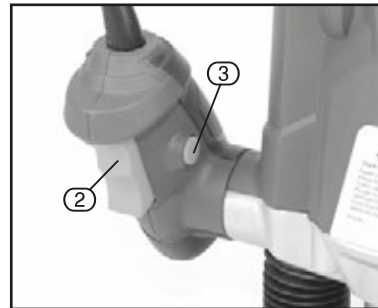

FIG.5

9.2 VARIABLE SPEED DIAL

The variable speed dial is marked 1 to 7 and correspond:

SETTING	APPROX.SPEED (r/min)
1	10,000
2	14,000
3	18,000
4	22,500
5	24,500
6	28,000
7	30,000

Note: Cutting speed depends on material, cutter size, cutting depth etc. Larger router bits will require a slower speed. For more detailed information refer to a routing/woodworking book.

9.3 SETTING THE CUTTING DEPTH

When you want to use the depth stop mechanism, first you need to install the router bit you will be using. Rotate the turret until the lowest setting is underneath the height adjustment rod (9). (Fig 7)

Rotate the plunge lock lever to release the plunge mechanism and with the router off, gradually push the machine downwards until the cutter just contacts the workpiece then lock the plunge mechanism again.

Ensuring height adjustment rod is unlocked (10), lower rod until it contacts the lowest point on the turret (11).

Take note of the value on the scale, if the scale reads 20mm and you want a 10mm deep cut, then raise the rod up until the scale reads 30mm (30-20=10) You can use the knob on the top of the height adjustment rod for fine adjustment (7), one turn equals 1mm of travel.

Then rotate the turret so the higher sections of the turret are under the rod. Switch the machine on and once up to full speed plunge the router down slowly until the height adjustment rod is in contact with the turret, perform your cut and switch machine off. Now rotate turret until the next



FIG.6

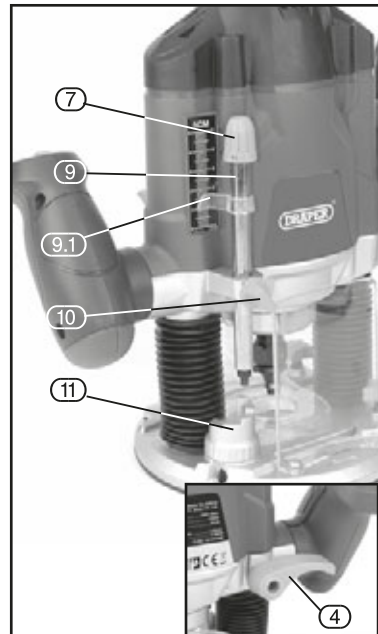

FIG.7

8. PREPARING THE ROUTER

8.5 FITTING & REPLACING ROUTER BITS

This router is designed for use with 6.35mm (1/4") and 8mm (5/16") shank router bits only.

Warning: Use bits of the correct shank diameter suitable for the speed of the tool.

Selection of the correct router bit, suitable for the intended application is vital. Seek guidance if uncertain of selection.

Press the spindle lock button (15) and unscrew the collet nut (14) using the spanner supplied.

Note: Take care not to loose the spring behind the collet.

Choose from the collets provided, the appropriate size for the cutters shank (1/4") 6.35mm or 8mm (5/16"). If the size is not known insert the bit into the collet. The collet which offers a machine fit to the shank is the correct one to use. Do not force the bit into a collet.

Replace the spring and place the collet into the spindle before loosely replacing the nut (14).

Slide in the bit allowing approx. 5-10mm overhang before tighten the collet nut (observe the router bit's manufacturers instructions for more specific information).

Note: Ensure at least 75% of the shank is inside the collet. Do not tighten the collet with no bit fitted as this will cause damage.

Do not overtighten the collet nut.

Warning: Take care when handling the cutter bits as they are extremely sharp.

When cutting is complete remove the bit before cleaning and storing it in a safe place.

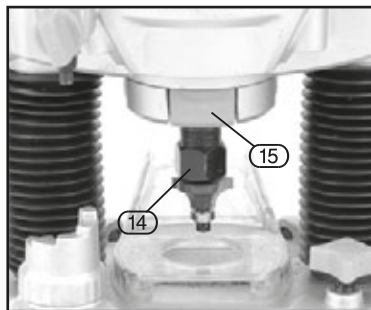
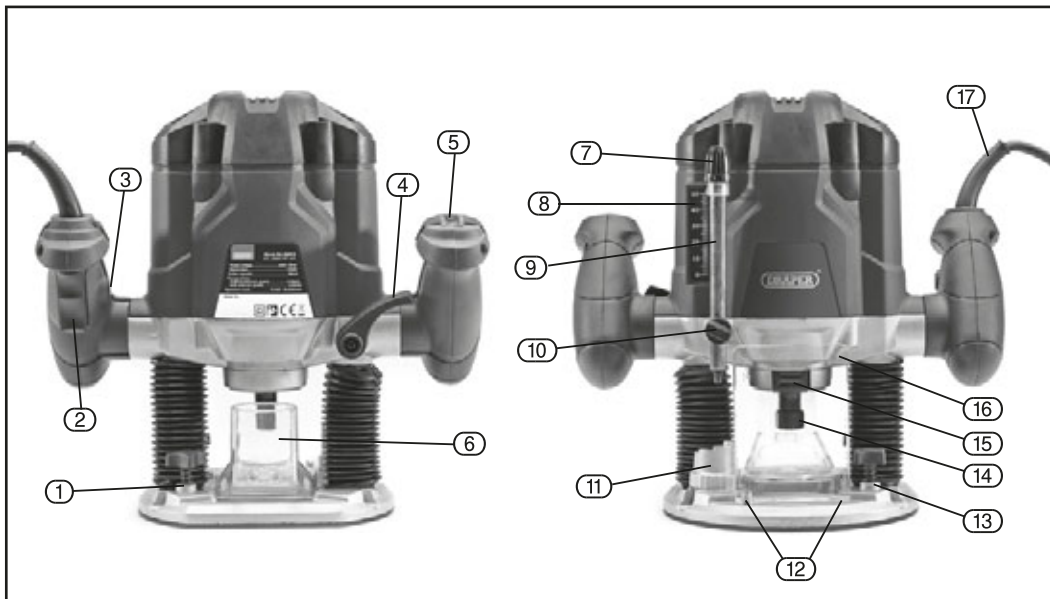

FIG.4

6. TECHNICAL DESCRIPTION

6.1 IDENTIFICATION



- | | |
|----------------------------------|--|
| ① Rod Locking point | ⑩ Height adjustment lock |
| ② On/off trigger switch | ⑪ Turret |
| ③ Trigger safety button | ⑫ Face shield anchor points |
| ④ Plunge lock lever | ⑬ Additional rod locking point (used in conjunction with 16) |
| ⑤ Variable speed dial | ⑭ Collet nut |
| ⑥ Dust extraction port | ⑮ Spindle lock button |
| ⑦ Fine height adjustment control | ⑯ Face shield |
| ⑧ Height adjustment scale | ⑰ Moulded plug & cable |
| ⑨ Height adjustment rod | |

7. UNPACKING AND CHECKING

7.1 PACKAGING

Carefully remove the product from the packaging and examine it for any sign of damage that may have happened during shipping. Lay the contents out and check them against the parts shown below. If any part is damaged or missing, please contact the Draper Help Line (the telephone number appears on the Title page) and do not attempt to use the product.

The packaging material should be retained at least during the guarantee period: in case the machine needs to be returned for repair.

Warning!

- Some of the packaging materials used may be harmful to children. Do not leave any of these materials in the reach of children.
- If any of the packaging is to be thrown away, make sure they are disposed of correctly, according to local regulations.

7.2 WHAT'S IN THE BOX

As well as the main product, there are also several other parts not fitted or attached to it:

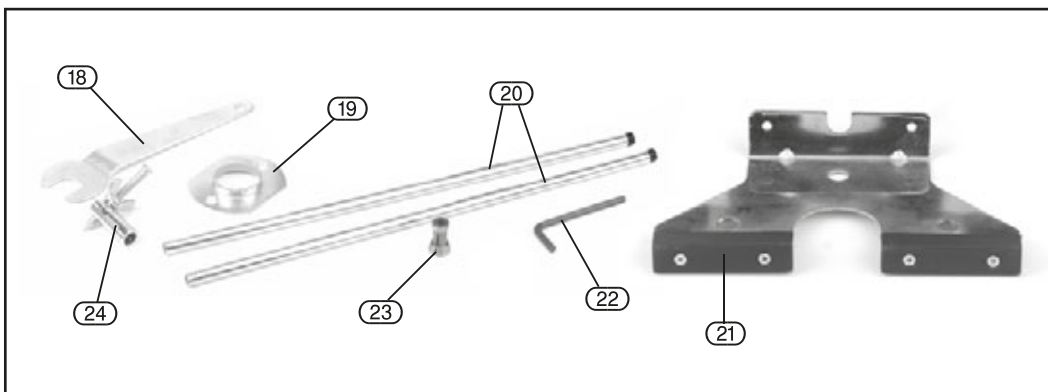

(18) Spanner

(19) 30mm template follower

(20) Rods

(21) Parallel guide fence

(22) 4mm hex. key

(23) Collets 1 x 6.35mm (1/4"), 1 x 8mm (5/16") (1 in the box, 1 in the machine)

(24) Pivot rod trammel

8. PREPARING THE ROUTER

Note: Remove the plug from the socket before carrying out adjustment, servicing or maintenance.

8.1 PARALLEL GUIDE FENCE

Insert screw (20.2) through washer (20.1). Secure the rods onto the guide fence (21) with the screw assembly.

8.2 DUST EXTRACTION PORT

The majority of operations will require the dust extraction to be fitted, however some operations will be impossible with the port fitted. These require appropriate safety equipment to be worn.

The dust extraction port comes fitted to the machine. To remove, ensure the power supply is isolated by either removing the battery or disconnecting the plug from the mains socket. Turn machine over exposing the bottom of the router, locate and undo the two screws holding the dust extraction adaptor to the machine.

Note: With the dust extraction port (6) fitted, the plunger stroke is slightly reduced.

8.3 DUST EXTRACTION

Inhalation of dust particles can be detrimental to health. The dust outlet (6) must be connected with a dust extraction machine (12).

Note: Due to the outlet diameter, a size adaptation may be necessary.

All wood dust (including dust from composites like chipboards and fibre boards etc) is hazardous to health; it can affect the nose, the respiratory system and the skin. For example MDF (medium density fibreboard) which contains formaldehyde is a known carcinogen. In addition to the above measures a correctly fitted dust mask, suitable for the activity and in accordance to the relevant standard, must be worn.

8.4 FACE SHIELD

The face shield (16) helps to protect the user from chips being ejected from the machine, it comes fitted to the router. If for any reason you need to remove it, undo the screw (12) on the left-hand side of the shield and lift the guard away from the machine. Ensure you use appropriate personal protection equipment to protect against debris that may be thrown from the machine.

To refit locate the peg on the right-hand side into the hole and replace the screw, making sure the screw is on the outside of the shield.

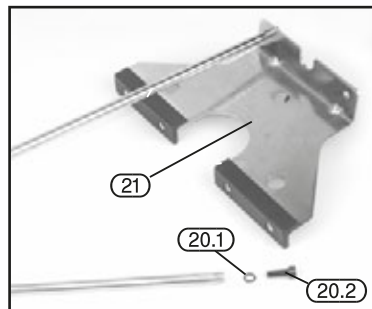

FIG.1

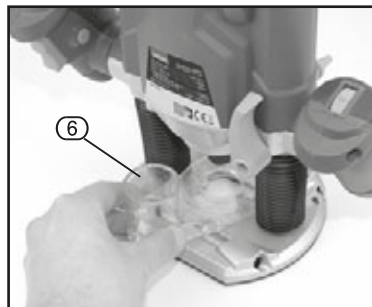

FIG.2

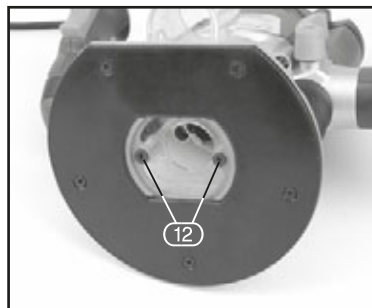

FIG.3

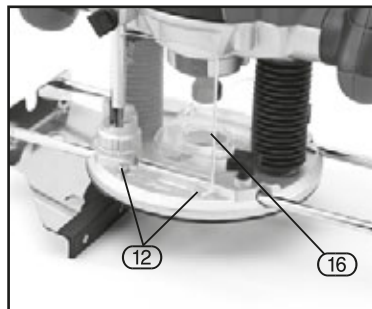

FIG.3b