

Mira Activate

Remote Controller Accessory

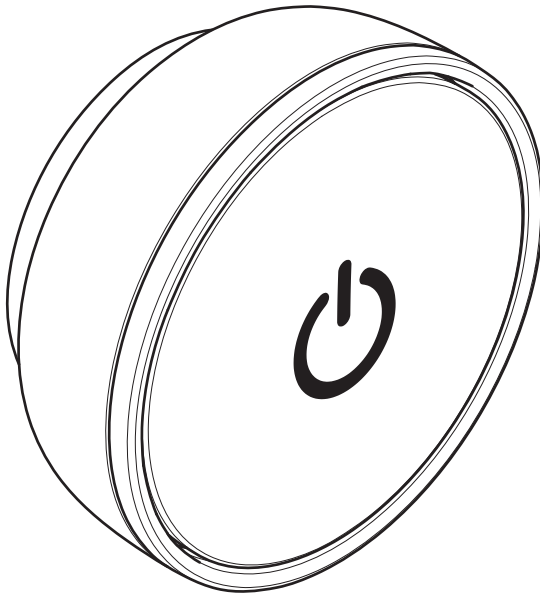

Installation and User Guide
Please leave these instructions with the user

mira
SHOWERS

Important Safety Information

Products manufactured by Kohler Mira Ltd. are designed to be safe, provided that they are installed, used and maintained in good working order, in accordance with our instructions and recommendations. Follow all warnings, cautions and instructions contained in this guide, and on, or inside the product. Failure to follow the instructions provided with this product will invalidate the guarantee.

WARNING! To reduce the risk of fire, electric shock or injury please read the important information listed below.

1. Installation of this product must be carried out in accordance with these instructions by qualified, competent personnel. Read all instructions before commencing installation.
2. Failure to install the product in accordance with these instructions may adversely affect the warranty terms and conditions
3. **DO NOT** install the remote in areas with high humidity and temperature (e.g. steam rooms and saunas).
4. **DO NOT** perform any unspecified modifications, drill or cut holes in the product other than instructed by this guide. When servicing only use genuine Kohler Mira replacement parts.
5. Make sure that you fully understand how to operate this remote and make sure that it is properly maintained in accordance with the instructions given in this manual.
6. This product can be used by children aged from 8 years and above and persons with reduced physical, sensory or mental capabilities or lack of experience and knowledge if they have been given supervision or instruction concerning the use of the appliance in a safe way and understand the hazards involved.
7. **DO NOT** allow children to play with the product.
8. **DO NOT** allow children to clean or perform any user maintenance without supervision.
9. **DO NOT** remotely operate or alter any of this product's shower and bathing settings if it is already occupied and / or being used by another person.

Disposal and Recycling

When this appliance has reached the end of its serviceable life it should be disposed of in a safe manner, in accordance with current local authority recycling or waste disposal policy. For more information about recycling, please contact your local council office.

Decommissioning and Recycling for WEEE



Electrical and electronic devices contain a range of materials that can be separated for recycling and used in new products. This product should not be disposed of with your general household waste. When this product has reached the end of its serviceable life please take it to a recognised WEEE (Waste Electrical and Electronic Equipment) collection facility such as your local civic amenity site for recycling. Your local authority or retailer will be able to advise you of your nearest recycling facility.

Frequency Bands and Maximum Radio

Frequency Power

Hereby, Kohler Mira Ltd. declares that the radio equipment type Mira Activate Remote Controller accessory is in compliance with Directive 2014/53/EU. The full text of the EU declaration of conformity is available at the following internet address: www.mirashowers.co.uk

The Mira Activate operates in the 2.4 GHz frequency band at a maximum radio frequency power of 0 dBm.

Product Function

Pressing the Activate Remote Controller accessory will turn on the shower at the default pre-set of the valve. The default pre-set is set to turn the hand shower on at 38°C at 50% flow.

This pre-set can be customised using your Apple iPhone or Android Phone with the companion Mira Showers app. Refer to the main product installation guide, section 'Set Up: Mobile App'.

Warning! Never remotely operate the Mira Activate shower if it is already occupied and / or being used by another person. This could result in flooding of the shower cubical or scalding of the user.

Recommended Usage

Domestic	✓
Light Commercial	✗
Heavy Commercial	✗
Healthcare	✗

Products Covered

Product Name	Product No.
Mira Activate Remote Assembly	2.1903.098

Pack Contents

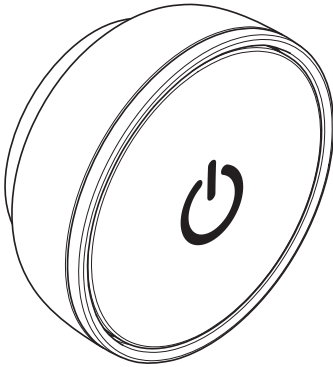

1 x Remote Assembly



1 x Wall Plate



1 x Cap



1 x CR2032 3V
Lithium Battery

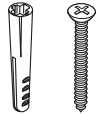

1 x Wall Plug
1 x Screw

Pair the Remote:

1

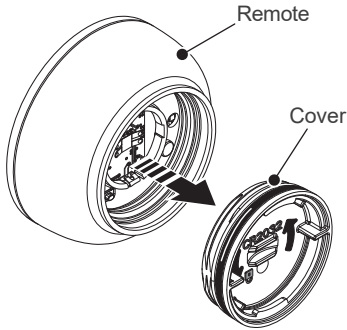

Rotate the cover anti-clockwise to remove from the remote assembly.

2

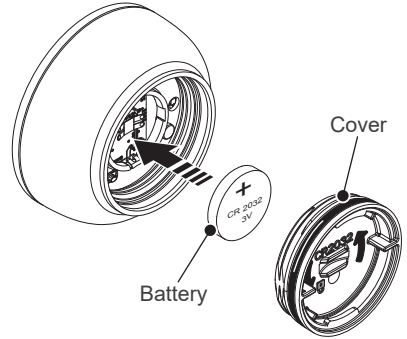

Insert the battery and refit the cover into remote assembly.

Note: The positive symbol on the battery MUST be facing outside.

3

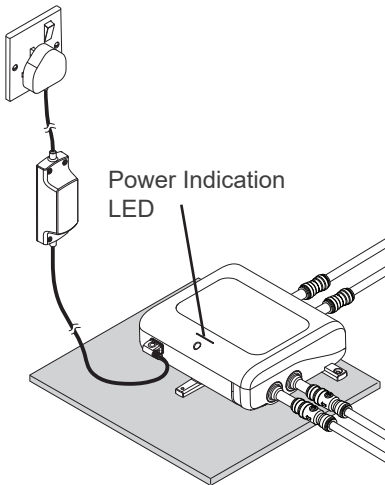

Turn OFF the electrical supply to digital mixing valve. Wait for 10 seconds, and turn ON again.

4

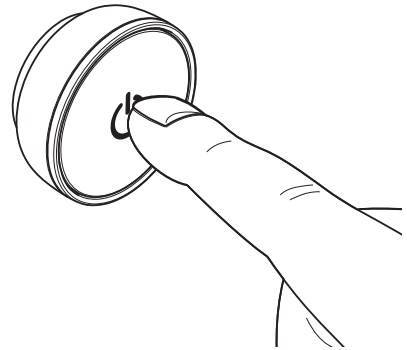

Within 30 seconds of powering ON the valve, press and hold the remote button for 6 seconds – a light on the rear of the remote will flash yellow then change to a green pulse to confirm pairing is successful.

Once paired, the remote button will now be able to turn on the product.

If no digital mixing valve is found, the light will continue to flash yellow. Move the remote button closer to the digital mixing valve and repeat step 3-4 until pairing is successful.

Installation

Note: The remote operates wirelessly. Its range is impacted by walls, ceiling and different building materials. Test that the remote button operates at the desired location before installing.

1 Once the desired location has been tested, mark the centre position and draw a vertical line using a spirit level to assist in the alignment of the remote button.

Drill a 6mm hole into the wall and insert the wall plug.

Apply silicone sealant around the hole before inserting the wall plug.

Note: The remote button must be installed on a flat and even wall surface avoiding any grout lines.

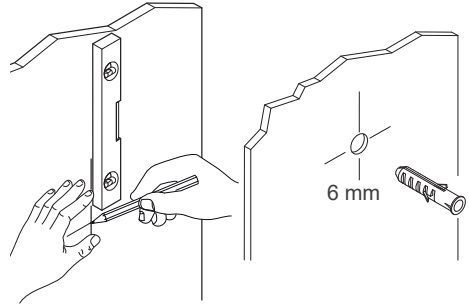

2 Locate the wall plate so that the two notches are aligned to the vertical line on the wall and secure using supplied screw. Tighten the supplied screw by hand.

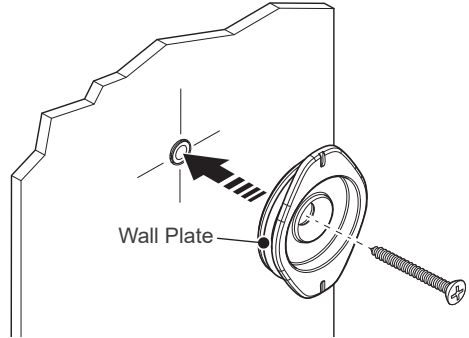

3 Push the screw cap in to the wall plate.

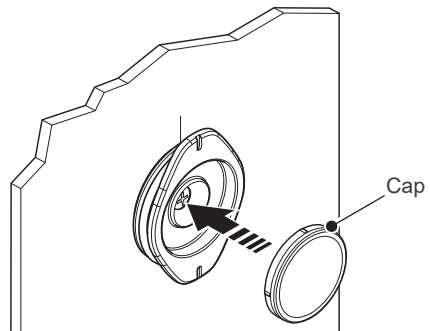

4

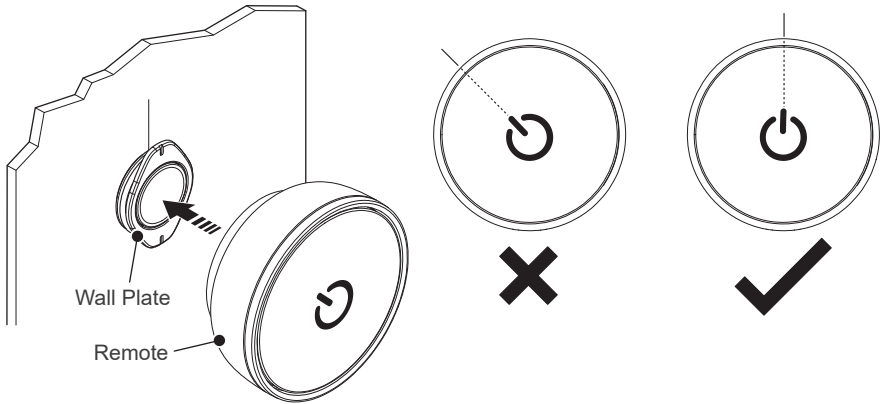

Locate the remote assembly on to the wall plate and twist until the symbol is aligned to the vertical line on the wall.

Clean off the vertical line once the on/off remote is correctly installed.

If required, the ON/OFF remote button can be removed from the backplate by rotating anticlockwise.

Maintenance

Changing the Battery

When the battery power is getting low, a red light will precede normal operational light sequences.

Once the battery is completely discharged, the red light will flash three times and the remote will no longer work indicating the battery must be replaced.

To replace the battery, remove the remote from the wall plate by rotating anticlockwise from the wall plate.

Un-screw the battery cover and replace the battery with a new CR2032 3V lithium battery.

Ensure the battery cover is replaced and fully tightened.

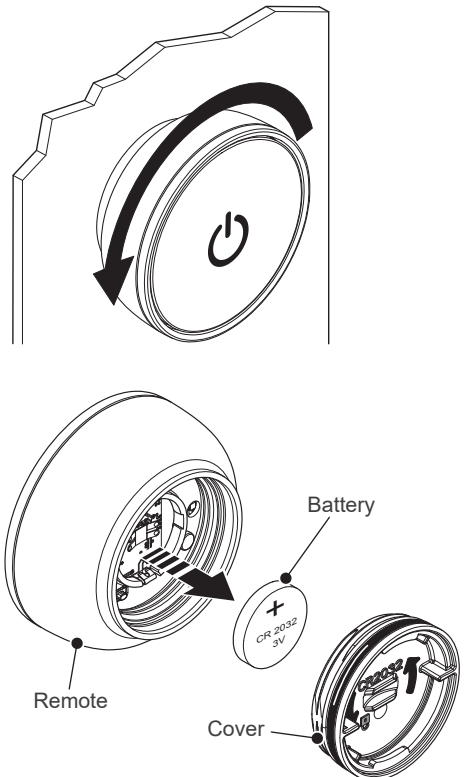

Your Product Guarantee

This product has been designed for domestic use only, it is not recommended for Commercial or Healthcare use.

For Domestic installations, Kohler Mira guarantee this product against any defect in materials or workmanship for a period of one year from the date of purchase. Within the guarantee period we will resolve defects in materials or workmanship, free of charge, by repairing or replacing parts or product as we may choose.

This guarantee only applies in the United Kingdom and the Republic of Ireland.

Activating Your Guarantee

Registering your guarantee is quick and simple. To ensure your product is covered, please register online www.mirashowers.co.uk/support/guarantee-registration.

What is Covered

This guarantee is in addition to your statutory rights and is subject to the following conditions

- The guarantee applies solely to the original installation under normal use and to the original purchaser only. The product must be installed and maintained in accordance with the instructions given in this guide.
- Servicing must only be undertaken by us or our appointed representative.

Note: If a service visit is required the product must be fully installed and connected to services.

- Repair under this guarantee does not extend the original expiry date. The guarantee on any replacement parts or product ends at the original expiry date.
- For shower fittings or consumable items we reserve the right to supply replacement parts only.

What is Not Covered

- Call out charges for non product faults (such as damage or performance issues arising from incorrect installation, improper use, inappropriate cleaning, lack of maintenance, build up of limescale, frost damage, chemical attack, where no fault has been found with the product.
- Water or electrical supply, waste and isolation issues.
- Compensation for loss of use of the product or consequential or indirect loss of any kind.
- Damage or defects caused if the product is repaired or modified by persons not authorised by us or our appointed representative.
- Accidental or wilful damage.
- Products purchased ex-showroom display.



Any questions regarding your guarantee? Give us a call on 0800 001 4040.

UK

T: 0800 001 4040
E: askus@mirashowers.com
www.mirashowers.co.uk

Eire

T: 01 531 9337
E: customerserviceire@mirashowers.com
www.mirashowers.ie



© Kohler Mira Limited, October 2020
Mira is a registered trade mark of Kohler Mira Limited.
The company reserves the right to alter product specifications without notice.

1458170-W2-A

© Kohler Mira Limited, October 2020