

**90°**

**trend**<sup>®</sup>  
*routing technology*

# Angle Attachment MK2

**For Direct  
Drive and  
Insert Bits.**

# Snappy



**Max  
Torque  
60Nm**

## IMPROVED FEATURES

- High load gears.
- Improved handle.
- For use with impact screwdriver.\*



**SNAP/ASA/2**

# Snappy

## Angle Screwdriver Attachment 90° MK2

### How to Fix the Handle

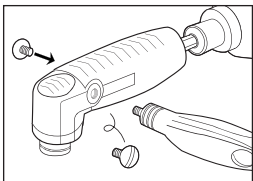

### **⚠ WARNING**

Fix the handle securely to one of the tapped holes.

1. Two location holes are covered with cap screws.
2. Remove cap screw of chosen location hole using a flat head screwdriver, then fix the handle securely.
3. Leave unused location hole covered with cap screw so that it cannot become clogged with dust.

### How to Hold the Angle Screwdriver Attachment

The Angle Screwdriver Attachment can be used with or without the side handle, however for best performance we advise the side handle is used.

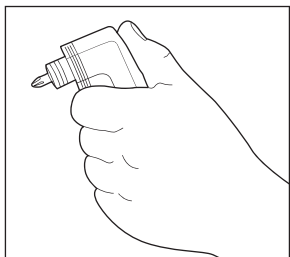

**Without handle**

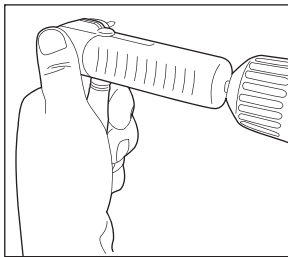

**With handle**

Hold body and handle of Angle Screwdriver Attachment tightly. Handle is merely auxiliary. Do not hold handle only. The thumb depression on the top of the tool allows more pressure to be applied.

## How to use the Angle Screwdriver Attachment

### **WARNING**

Never switch on the drill without holding the Angle Screwdriver Attachment, otherwise the attachment body rotates dangerously.

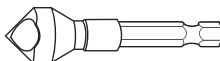

Place the bit securely in the screw head groove and perpendicular to component being screwed in.

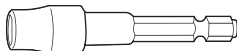

## Safety Steps

1. Never switch on the drill without holding the attachment otherwise the Angle Screwdriver Attachment body rotates dangerously.
2. When changing bits make sure the drill is switched off.
3. Make sure Angle Screwdriver Attachment is securely attached to drill.
4. Secure that the bit is in the chuck properly before operation.
5. Never mis-use the Angle Screwdriver Attachment.
6. Do not over-load the Angle Screwdriver Attachment as it may result in serious injury or breakage.
7. Place the bit securely in the screw head groove and perpendicular to component being screwed in.

All Trend tooling is guaranteed against any defects in either workmanship or material, except tools that have been damaged due to improper use or maintenance.

Our policy of continuous improvements mean that specifications may change without notice. Trend Machinery & Cutting Tools Ltd. cannot be held liable for any material rendered unusable, or for any form of consequential loss.

More instructions inside

# Snappy

## Angle Attachment 90° MK2

Patent Pending

For Direct Drive and Insert Bits.

GB Accessories

ES Accesorios

DK Tihjør

DE Zubehörteile

SE Tillbehör

NO Tilleggsutstyr

FR Accessoires

IT Accessori

FI Tarvikkeet

NL Accessoires

PT Acessórios

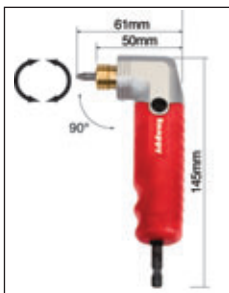
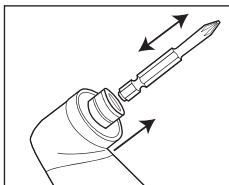
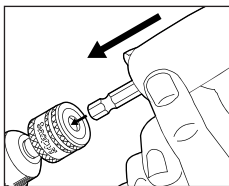

Can be used with Impact Drivers

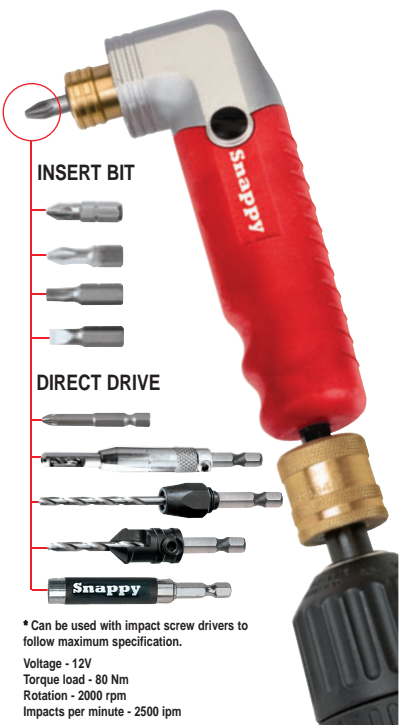

\* Can be used with impact screw drivers to follow maximum specification.

Voltage - 12V

Torque load - 80 Nm

Rotation - 2000 rpm

Impacts per minute - 2500 ipm

Not suitable for use with nutsetters or sockets

# Snappy

The Quick Release Drill System



Trend Machinery & Cutting Tools Ltd.

Tel: 0044(0)1923 249911

technical@trendm.co.uk

www.trend-uk.com/snappy

**trend**<sup>®</sup>  
routing technology

SNAP/ASA/2



5 027654 549148 >

PP C/SN/ASA/2 v1.0