

Item	Part No.	Description
1	SAC3020521000	Pump Unit
2	SAC5155360008	Tank 150ltr
3	SAC7011030000	Screw (M6x10)
4	SAC7011080000	Screw (M8x16)
5	SS1045.S	Hex Head Set Screw M10 X 45 Zinc
6	HHB845.S	Hex Head Bolt M8 x 45mm
7	MSP512.S	Machine Screw Pan Head Phillips M5 X 12mm
8	SN10.S	Steel Nut M10 Zinc
9	SN6.S	Steel Nut M6 Zinc

Item	Part No.	Description
10	SN8.S	Steel Nut M8 Zinc / Steel Nut M8 Zinc
11	SAC7030120000	Washer (8x24x2)
12	RW619.S	Repair Washer M6 X 19 Zinc
13	SAC7031010000	Toothed Washer
14	SAC7031030000	Washer
15	SAC7038080000	Washer
16	SAC7080140000	Elbow 10mm Male- od:6mm Pipe
17	SAC7080160000	Elbow 1/2"bsp Male x2
18	SAC7085190000	Fitting 3/8"-1/4" M/F

**NOTE:** It is our policy to continually improve products and as such we reserve the right to alter data, specifications and component parts without prior notice. There may be alternative versions of this product, please contact us should you require this information.

**IMPORTANT:** No liability is accepted for incorrect use of product. Spare parts must be fitted by a competent person

**WARRANTY:** Guarantee is 12 months from purchase date, proof of which will be required for any claim.

## Parts Information: Compressor 150L Belt Drive Petrol Engine 6.5hp Model No: SA1565

Item	Part No.	Description
19	SAC7090030000	Plug 1/2
20	SAC7110140000	Gauge 230psi, 65mm od, Rear Mounting
21	SAC7130150000	Ball Valve 1/2" BSP Female-1/2"BSP Male
22	SAC7130160000	Drain Valve 3/8"BSP Male
23	SAC7192090000	Safety Valve 10bar 3/8"BSP Male
24	SAC7195170000	Pressure Regulator Valve
25	SAC7230010000	Rislan Hose (Sold Per 1 Meter)
26	SAC7237810000	Delivery Pipe
27	SAC4170270000	Belt Guard Kit

Item	Part No.	Description
28	SAC7364180000	Shock Absorber
29	SAC7371290000	Belt, Ribbed (1d-1500)
30	SAC7385440000	Engine
31	SAC7406340000	Motor Pulley C/w Centre Boss And Screw
32	SAC7456410000	Belt Guard Support
33	SAC7456420000	Belt Guard Support
34	SAC9102360000	Pneumatic Accelerator
--	PCM2500.01	Recoil Starter Complete (Not Shown)

### Breakdown Of Pump

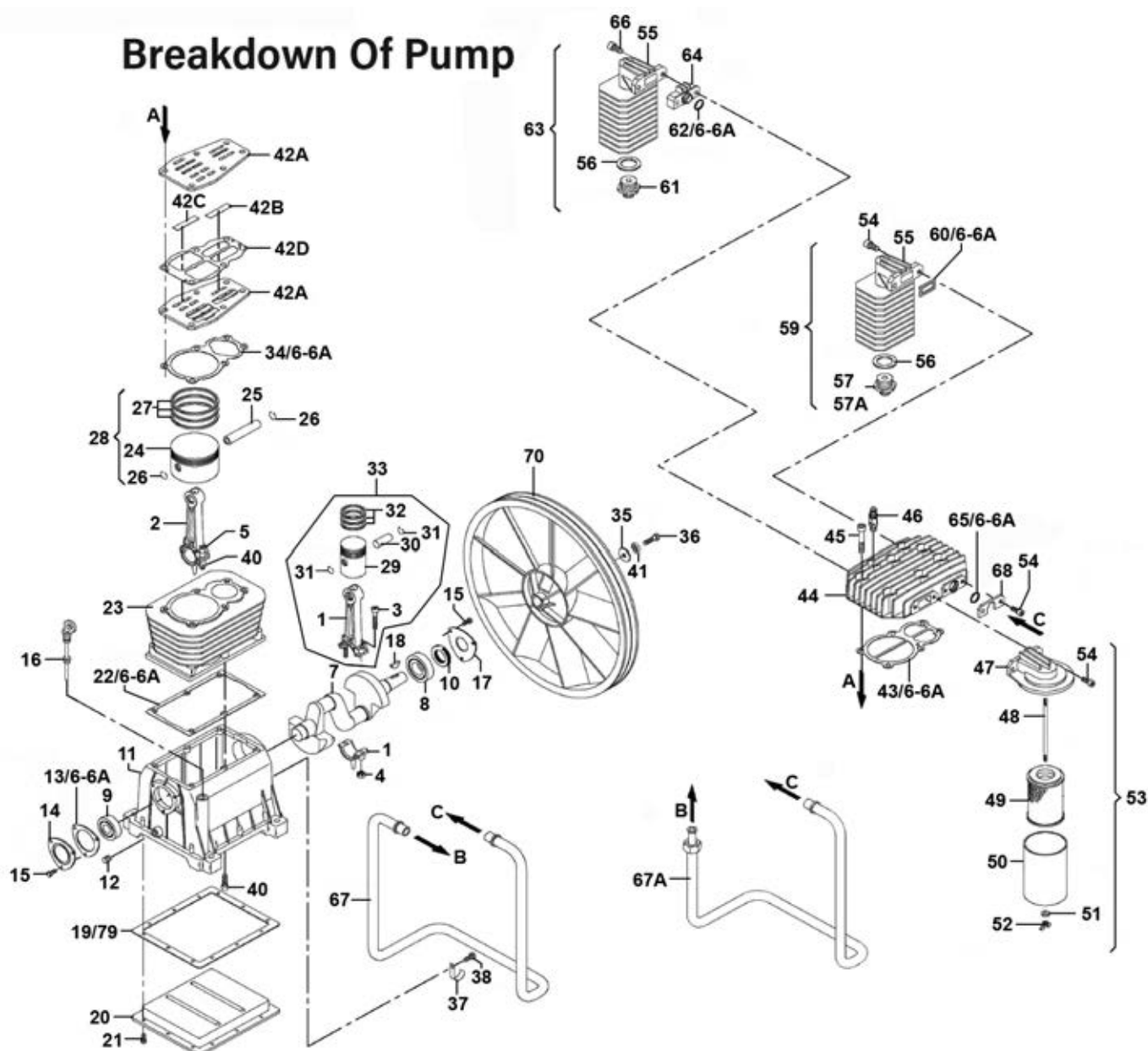

**NOTE:** It is our policy to continually improve products and as such we reserve the right to alter data, specifications and component parts without prior notice. There may be alternative versions of this product, please contact us should you require this information.

**IMPORTANT:** No liability is accepted for incorrect use of product. Spare parts must be fitted by a competent person

**WARRANTY:** Guarantee is 12 months from purchase date, proof of which will be required for any claim.

**Sealey Group**, Kempson Way, Suffolk Business Park, Bury St Edmunds, Suffolk. IP32 7AR



01284 757500



01284 703534



sales@sealey.co.uk



www.sealey.co.uk



Parts Information:  
**Compressor 150L Belt Drive Petrol Engine  
6.5hp  
Model No: SA1565**

Item	Part No.	Description
1	SAC4190190008	Connecting Rod (High)
2	SAC4190200008	Connecting Rod (Low)
3	HHB845.S	Hex Head Bolt M8 x 45mm
4	SAC7022040000	Lock Nut
5	SS640.S	Hex Head Set Screw M6 X 40 Zinc
6-6A	SAC4082550000	Gasket Set
7	SAC5041030008	Crankshaft
8	B/6206	Bearing 6206
9	B/6205	Bearing 6205
10	SAC7071060000	Oil Seal
11	SAC5071020008	Crankcase
12	SAC7090090000	Plug 1/4"
13	SAC7079160000	Gasket
14	SAC7650070000	Front Cover
15	SS616.S	Hex Head Set Screw M6 X 16 Zinc
16	SAC7181100000	Dipstick
17	SAC7650080000	Rear Cover
18	SAC7051520000	Key
19	SAC7079190000	Base Gasket
20	SAC7650090000	Crankcase Base
21	SAC7011440000	Screw (5x15)
22	SAC7079150000	Cylinder Gasket
23	SAC7575260000	Cylinder
24	SAC7220110000	Piston (Low)
25	SAC7050120000	Piston Pin
26	SAC7040130000	Seeger Ring
27	SAC4080100000	Piston Ring Set (Low)
28	SAC4291080000	Piston Group (Low)
29	SAC7220120000	Piston (High)
30	SAC7050130000	Piston Pin
31	SAC7040140000	Seeger Ring
32	SAC4080080000	Piston Ring Set (High)
33	SAC4291090000	Piston Group (High)
34	SAC7079170000	Head Gasket
35	RW825.S	Repair Washer M8 X 25 Zinc
36	SS825.S	Hex Head Set Screw M8 X 25 Zinc

Item	Part No.	Description
37	SAC7043050000	Clamp
38	SAC7012280000	Screw (5x10)
40	SAC7010090000	Screw (M8x25)
41	SAC7030360000	Ext Tooth Washer
42A	SAC1124230123	Valve Plate Kit
42B	SAC9106600020	Valve Reed (High)
42C	SAC7199130000	Valve Reed
42D	SAC7079780000	Valve Plate Gasket
43	SAC7079180000	Head Gasket
44	SAC5030530008	Head
45	SAC7010430000	Head Bolt M10x50
46	SAC7192350000	Safety Valve 1/4"BSP Male 6 Bar
47	SAC5130020008	Filter Cover
48	SAC7015150000	Tension Rod
49	SAC7210240000	Filter Cartridge
50	SAC7210250000	Filter Casing
51	SAC7031030000	Washer
52	SN6.S	Steel Nut M6 Zinc
53	SAC4250020000	Filter Group
54	SAC7010050000	Screw (M8x20)
55	SAC5130010008	Aftercooler
56	SAC7079090000	Washer Large, Thin Rim
57	SAC5131000008	Adaptor 1" BSP Male-1/2"BSP Male
59	SAC4251080000	After Cooler Group
60	SAC7079100000	Gasket
61	SAC7081220000	Adaptor
62	SAC7070120000	O-Ring
63	SAC4251060000	After Cooler Group
64	SAC7458430000	Adaptor
65	SA29.V3-41	O-Ring, (Ex: 22.36 In: 17.12 Cs: 2.62)
66	SAC7010070000	Screw (M8x40)
67	SAC7230700000	Delivery Tube
68	SAC7458420000	Stop Plate
70	SAC7201050000	Flywheel
--	SAC7458460000	Stop Plate (Not Shown)
--	SAC7031010000	Toothed Washer (Not Shown)

**NOTE:** It is our policy to continually improve products and as such we reserve the right to alter data, specifications and component parts without prior notice. There may be alternative versions of this product, please contact us should you require this information.

**IMPORTANT:** No liability is accepted for incorrect use of product. Spare parts must be fitted by a competent person

**WARRANTY:** Guarantee is 12 months from purchase date, proof of which will be required for any claim.

**Sealey Group**, Kempson Way, Suffolk Business Park, Bury St Edmunds, Suffolk. IP32 7AR



01284 757500



01284 703534



sales@sealey.co.uk



www.sealey.co.uk