



# EXTENSION CABLE CUBE 1.4m 4x230V + 2xUSB SOCKETS - WHITE

MODEL NO: **EL144USB**

Thank you for purchasing a Sealey product. Manufactured to a high standard, this product will, if used according to these instructions, and properly maintained, give you years of trouble free performance.

**IMPORTANT:** PLEASE READ THESE INSTRUCTIONS CAREFULLY. NOTE THE SAFE OPERATIONAL REQUIREMENTS, WARNINGS & CAUTIONS. USE THE PRODUCT CORRECTLY AND WITH CARE FOR THE PURPOSE FOR WHICH IT IS INTENDED. FAILURE TO DO SO MAY CAUSE DAMAGE AND/OR PERSONAL INJURY AND WILL INVALIDATE THE WARRANTY. KEEP THESE INSTRUCTIONS SAFE FOR FUTURE USE.



Read before first use



Indoor Use Only

## 1. SAFETY

### 1.1. ELECTRICAL SAFETY

- ❑ **WARNING!** It is the user's responsibility to check the following:
    - Check all electrical equipment and appliances to ensure that they are safe before using. Inspect power supply leads, plugs and all electrical connections for wear and damage. Sealey recommend that an RCD (Residual Current Device) is used with all electrical products. You may obtain an RCD by contacting your local Sealey stockist.
    - If used in the course of business duties, it must be maintained in a safe condition and routinely PAT (Portable Appliance Test) tested. Electrical safety information, it is important that the following information is read and understood.
  - ✓ Ensure that the insulation on all cables and on the appliance is safe before connecting it to the power supply.
  - ✓ Regularly inspect power supply cables and plugs for wear or damage and check all connections to ensure that they are secure.
  - ✓ Ensure that the voltage rating on the appliance suits the power supply to be used and that the plug is fitted with the correct fuse - see fuse rating in these instructions.
  - ✗ **DO NOT** pull or carry the appliance by the power cable.
  - ✗ **DO NOT** pull the plug from the socket by the cable.
  - ✗ **DO NOT** use worn or damaged cables, plugs or connectors. Ensure that any faulty item is repaired or replaced immediately by a qualified electrician.
  - ✓ This product is fitted with a BS1363/A 13 Amp 3 pin plug.
    - If the cable or plug is damaged during use, switch off the electricity supply and remove from use. Ensure that repairs are carried out by a qualified electrician.
    - Replace a damaged plug with a BS1363/A 13 Amp 3 pin plug. If in doubt contact a qualified electrician.
    - a) Connect the GREEN/YELLOW earth wire to the earth terminal 'E'.
    - b) Connect the BROWN live wire to the live terminal 'L'.
    - c) Connect the BLUE neutral wire to the neutral terminal 'N'.
- Ensure that the cable outer sheath extends inside the cable restraint and that the restraint is tight. Sealey recommend that repairs are carried out by a qualified electrician.

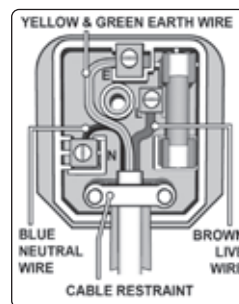

Recommended fuse rating  
13 Amp

## 2. INTRODUCTION

Space-saving cube design. Suitable for garage, workshop and office applications. Features 2 x 5V (2.1A) USB sockets and 4 x 230V sockets. Fitted with 3-pin heavy-duty plug. Supplied with bracket, suitable for mounting under desks (covers one socket).

## 3. SPECIFICATION

Model No:..... EL144USB  
 Colour: .....White  
 USB Output:.....5.0V - 2.1A Total 10.5W  
 Supply:.....250 ~ 50Hz  
 Max: .....3120W  
 Total Max Load:..... 13A  
 Sockets: ..... 4 x 230V, 2 x USB 5V 2.1A  
 Cable Section:..... 3 x 1.25mm<sup>2</sup>  
 Cable Length:..... 1.4m

## 4. OPERATION

- 4.1. The cube can be used as a stand alone or fixed item (using the bracket supplied).
- 4.2. **TO FIX THE CUBE TO A DESK**
  - 4.2.1. Peel off one side of the self adhesive pads and position on the bracket ( the pad will fit in the recess on the back of the bracket, leaving the holes free to receive the screws).
  - 4.2.2. Position the bracket and stick to surface making sure there is access around cube for sockets to be used.
  - 4.2.3. Use screws provided to fix to desk. ( Dependant on the surface to be fixed to alternative fixings may be required).

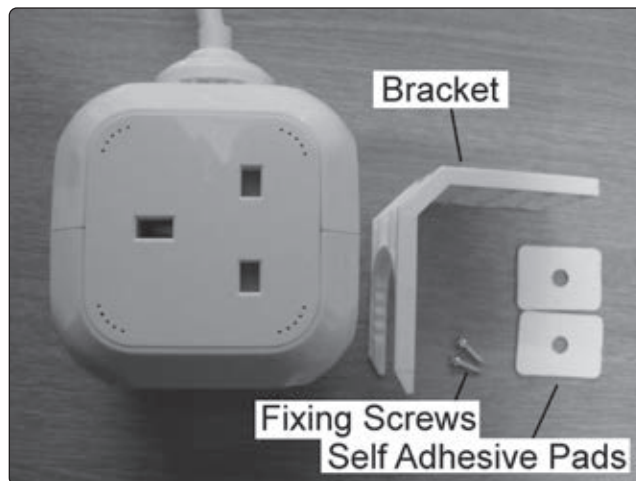

- 4.3. Push the Cube into the bracket.
- 4.4. Connect items to the cube.
- 4.5. Connect Cube to main power supply.
- 4.6. Always disconnect when not in use.



#### ENVIRONMENT PROTECTION

Recycle unwanted materials instead of disposing of them as waste. All tools, accessories and packaging should be sorted, taken to a recycling centre and disposed of in a manner which is compatible with the environment. When the product becomes completely unserviceable and requires disposal, drain any fluids (if applicable) into approved containers and dispose of the product and fluids according to local regulations.



#### WEEE REGULATIONS

Dispose of this product at the end of its working life in compliance with the EU Directive on Waste Electrical and Electronic Equipment (WEEE). When the product is no longer required, it must be disposed of in an environmentally protective way. Contact your local solid waste authority for recycling information.

**Note:** It is our policy to continually improve products and as such we reserve the right to alter data, specifications and component parts without prior notice.

**Important:** No Liability is accepted for incorrect use of this product.

**Warranty:** Guarantee is 12 months from purchase date, proof of which is required for any claim.

Sealey Group, Kempson Way, Suffolk Business Park, Bury St Edmunds, Suffolk. IP32 7AR



01284 757500



01284 703534



sales@sealey.co.uk



www.sealey.co.uk