

2.1 CONTENTS	1. TITLE PAGE
2. CONTENTS	1.1 INTRODUCTION
	USEN MANUAL FOR
	RECHARGEABLE POCKET SLIM LIGHT
	Stock no. 64499
	Part no. RIL/MSL100
	Date first published: March 2021.
1.2 REVISION HISTORY	
2.1 CONTENTS	
3. WARRANTY	
4. INTRODUCTION	
4.1 SCOPE	
4.2 SPECIFICATION	
4.3 HANDLING AND STORAGE	
4.4 INTRODUCTION	
4.1 SCOPE	
4.2 SPECIFICATION	
4.3 HANDLING AND STORAGE	
4.4 INTRODUCTION	
5. HEALTH AND SAFETY INFORMATION	
5.1 GENERAL SAFETY INSTRUCTIONS	
5.2 CONNECTION TO THE POWER SUPPLY (CHARGER)	
5.3 UNDERSTANDING THIS MANUAL'S SAFETY CONTENT	
5.4 DISPOSAL	
5.5 EXPLANATION OF SYMBOLS	
5.6 MAINTENANCE	
5.7 PACKAGING	
5.8 PREPARING THE POCKET SLIM LIGHT	
5.9 OPERATING THE POCKET SLIM LIGHT	
5.10 MAINTENANCE	
5.11 EXPLANATION OF SYMBOLS	
5.12 DISPOSAL	

CONTACTS

Draper Tools Limited, Hursley Road,
Chandler's Ford, Eastleigh, Hampshire, SO53 1YF, U.K.

Help line: +44 (0) 23 8049 4344

Sales desk: +44 (0) 23 8049 4333

Internet: www.drapertools.com

E-mail: sales@drapertools.com

General enquiries: (023) 8026 6355

Service/Warranty Repair Agent:
For aftersales servicing or warranty repairs, please contact the
Draper Tools Helpline for details of an agent in your local area.

YOUR DRAPER STOCKIST

©Published by Draper Tools Limited.
No part of this publication may be reproduced, stored in a retrieval system or transmitted in any form or by any means,
electronic, mechanical, photocopying, recording or otherwise without prior permission in writing from Draper Tools Ltd.

DBTL0521

In all cases this copyright notice must remain intact.
Copyright © Draper Tools Limited.
No part of this publication may be stored in a retrieval system or transmitted in any other
form or means without written permission from Draper Tools Limited.
Commercial copying, redistribution, hiring or lending is prohibited.
Permission is granted to reproduce, in whole or in part, this publication for personal & educational use only.
All rights reserved.

1.4 COPYRIGHT @ NOTICE

CAUTION! Information that draws attention to the risk of damage to the product or surroundings.

WARNING! Information that draws attention to the risk of injury or death.

1.3 UNDERSTANDING THIS MANUAL'S SAFETY CONTENT

UK
SO53 1YF
HAMPSHIRE
EASTLEIGH
CHANDLER'S FORD
HURSFLEY ROAD
DRAPER TOOLS LIMITED
WEBSITE: drapertools.com
PRODUCT HELP LINE: +44 (0) 23 8049 4344
GENERAL FAX: +44 (0) 23 8026 0784

Downloads are available from: <http://www.drapertools.com/manuals>
Very latest version.

As our user manuals are continually updated, users should make sure that they use the

latest version.

HEALTH AND SAFETY INFORMATION

5.1 GENERAL SAFETY INSTRUCTIONS

5.2 CONNECTION TO THE POWER SUPPLY (CHARGER)

5.3 UNDERSTANDING THIS MANUAL'S SAFETY CONTENT

5.4 DISPOSAL

5.5 EXPLANATION OF SYMBOLS

5.6 MAINTENANCE

5.7 PACKAGING

5.8 PREPARING THE POCKET SLIM LIGHT

5.9 OPERATING THE POCKET SLIM LIGHT

5.10 MAINTENANCE

5.11 EXPLANATION OF SYMBOLS

5.12 DISPOSAL



RECHARGEABLE POCKET SLIM LIGHT

64499



IMPORTANT: Please read these instructions carefully to ensure the safe and effective use of this product and save these instructions for future reference. This manual has been compiled by Draper Tools and is an integrated part of the product with which it is enclosed and should be kept with it for future reference.
This manual describes the purpose for which the product has been designed and contains all the necessary information to ensure its correct and safe use. We recommend that this manual is read before any operation or, before performing any kind of adjustment to the product and prior to any maintenance tasks. By following all the general safety instructions contained in this manual, it will ensure both product and operator safety, together with longer life of the product itself.
All photographs and drawings in this manual are supplied by Draper Tools to help illustrate the operation of the product. Whilst every effort has been made to ensure accuracy of information contained in this manual, the Draper Tools policy of continuous improvement determines the right to make modifications without prior warning.

3. WARRANTY

3.1 WARRANTY

Draper tools have been carefully tested and inspected before shipment and are guaranteed to be free from defective materials and workmanship.

Should the tool develop a fault, please return the complete tool to your nearest distributor or contact

Draper Tools Limited, Chandler's Ford, Eastleigh, Hampshire, SO53 1YF, England, Telephone Sales Desk: (023) 8049 4333 or Product Help Line (023) 8049 4344.

A proof of purchase must be provided with the tool.

If upon inspection it is found that the fault occurring is due to defective materials or workmanship, repairs will be carried out free of charge. This warranty period covers parts/labour is 12 months from the date of purchase except where tools are hired out when

the warranty period is 90 days from the date of purchase. This warranty does not apply to any consumable parts, any type of battery or normal wear and tear, nor does it cover any damage caused by misuse, careless or unsafe handling, alterations, accidents, or repairs attempted or made by any personnel other than the authorised Draper warranty repair agent.

Note: If the tool is found not to be within the terms of warranty, repairs and damage charges will be quoted and made accordingly.

This warranty applies in lieu of any other warranty expressed or implied and variations of its terms are not authorised.
Your Draper warranty is not effective unless you can produce upon request a dated receipt or invoice to verify your proof of purchase within the warranty period.
Please note that this warranty is an additional benefit and does not affect your statutory rights.
Draper Tools Limited.

4. INTRODUCTION

4.1 SCOPE

Part of our Expert range, this product is intended for trade use with the quality & features to meet and exceed the expectations of the most demanding user. The ultra-compact 3-in-1 design offers maximum versatility and application coverage. The 180° flexible head is ideal for illuminating restricted areas. The strong rear and base magnets can be used to hold the pocket slim light anywhere. It has durable aluminium housing, an integrated pocket clip and is of lightweight design.

4.2 SPECIFICATION

Stock no.....	64499
Part no.....	RIL/MSL100
SMD LED.....	1W
COB LED x 2.....	1W
Lumens:	
High.....	100 lumens
Low.....	50 lumens
Top spotlight.....	50 lumens
Back light.....	100 lumens
Light operating time:	
High.....	3 hrs
Low.....	6 hrs
Top spotlight.....	3 hrs
Back light.....	3 hrs
Pocket slim light size:	
Unfolded.....	225 x 23.5 x 19.2 mm
Folded.....	120 x 30 x 19.2 mm
Battery:	
Type.....	Li-Ion
Rated voltage.....	3.7V
Rating.....	0.35Ah
Charging time.....	2.5 hrs

4.3 HANDLING AND STORAGE

Do not drop the pocket slim light as this can damage and shorten the life span of the unit.

Store in a dry location as damp conditions can damage the pocket slim light.

Charging on a regular basis is advised to prolong the life of the battery cells.

5. HEALTH AND SAFETY INFORMATION

5.1 GENERAL SAFETY INSTRUCTIONS

General Power Tools Safety Warnings
WARNING: Read all instructions. Failure to follow all instructions listed below may result in electric shock, fire and/or serious injury.
Save all warnings and instructions for future reference.
The term "power tool" in the warnings refers to your mains operated (corded) power tool or battery operated (cordless) power tool.

- Work area safety**
 - Power tool plugs must match the outlet. Never modify the plug in any way. Do not use any adapter plugs with earthed (grounded) power tools. Unmodified plugs and matching outlets will reduce risk of electrical shock.
 - Do not operate power tools in explosive atmospheres, such as in the presence of flammable liquids, gases or dust. Power tools create sparks which may ignite the dust or fumes.
 - Keep children and bystanders away while operating a power tool. Distractions can cause you to lose control.
 - Electrical Safety
 - Power tool plugs must match the outlet. Never modify the plug in any way. Do not use any adapter plugs with earthed (grounded) power tools. Unmodified plugs and matching outlets will reduce risk of electrical shock.
 - Avoid body contact with earthed or grounded surfaces such as pipes, radiators, ranges and refrigerators. There is an increased risk of electric shock if your body is earthed or grounded.
 - Do not expose power tools to rain or wet conditions. Water entering a power tool will increase the risk of electric shock.
 - Do not abuse the cord. Never use the cord for carrying, pulling or unplugging the power tool. Keep cord away from heat, oil, sharp edges or moving parts. Damaged or entangled cords increase the risk of electric shock.
 - When operating a power tool outdoors, use an extension cord suitable for outdoor use. Use of a cord suitable for outdoor use reduces the risk of electric shock.
 - If operating a power tool in a damp location is unavoidable, use a residual current device (RCD) protected supply. Use of an RCD reduces the risk of electric shock.
- Personal Safety**
 - Stay alert, watch what you are doing and use common sense when operating a power tool. Do not use a power tool while you are tired or under the influence of drugs, alcohol or medication. A moment of inattention while operating power tools may result in serious personal injury.
 - Use personal protective equipment. Always wear eye protection. Protective equipment such as dust mask, non-skid safety shoes, hand hat, or hearing protection used for appropriate conditions will reduce personal injuries.
 - Prevent unintentional starting. Ensure the switch is in the off position before connecting to power source and/or battery pack, picking up or carrying the tool. Carrying power tools with your finger on the switch or energising power tools that have the switch on invites accidents.
 - Remove any adjusting key or wrench before turning the power tool on. A wrench or a key left attached to a rotating part of the power tool may result in personal injury.
- Do not overreach.** Keep proper footing and balance at all times. This enables better control of the power tool in unexpected situations.
- Dress properly.** Do not wear loose clothing or jewellery. Keep your hair, clothing and gloves away from moving parts. Loose clothes, jewellery or long hair can be caught in moving parts.
- If devices are provided for the connection of dust extraction and collection facilities, ensure these are connected and properly used.** Use of dust collection can reduce dust related hazards.
- Power Tool Use and Care**
 - Do not force the power tool. Use the correct power tool for your application. The correct power tool will do the job better and safer at the rate for which it was designed.
 - Do not use the power tool if the switch does not turn it on and off. Any power tool that cannot be controlled with the switch is dangerous and must be repaired.
 - Disconnect the plug from the power source and/or the battery pack from the power tool before making any adjustments, changing accessories, or storing power tools. Such preventive safety measures reduce the risk of starting the power tool accidentally.
 - Store idle power tools out of the reach of children and do not allow persons unfamiliar with the power tool or these instructions to operate the power tool. Power tools are dangerous in the hands of untrained users.
 - Maintain power tools. Check for misalignment or binding of moving parts, breakage of parts and any other condition that may affect the power tools operation. If damaged, have the power tool repaired before use. Many accidents are caused by poorly maintained power tools.
 - Keep cutting tools sharp and clean. Properly maintained cutting tools with sharp cutting edges are less likely to bind and are easier to control.
 - Use the power tool, accessories and tool bits etc., in accordance with these instructions, taking into account the working conditions and the work to be performed. Use of the power tool for operations different from intended could result in a hazardous situation.
- Battery tool use and care**
 - Recharge only with the charger specified by the manufacturer. A charger that is suitable for one type of battery pack may create a risk of fire when used with another battery pack.
 - Use power tools only with specifically designated battery packs. Use of any other battery packs may create a risk of injury and fire.
 - When battery pack is not in use, keep it away from other metal objects, like paper clips, coins, keys, nails, screws or other small metal objects, that can make a connection from one terminal to another. Shorting the battery terminals together may cause burns or a fire.
 - Under abusive conditions, liquid may be ejected from the battery. Avoid contact. If contact accidentally occurs, flush with water. If liquid contacts eyes, additionally seek medical help. Liquid ejected from the battery may cause irritation or burns.
- Service**
 - Have your power tool serviced by a qualified repair person using only identical replacement parts. This will ensure that the safety of the power tool is maintained.

5.2 CONNECTION TO THE POWER SUPPLY (CHARGER)

Make sure the power supply information on the machine's rating plate are compatible with the power supply you intend to connect it to.

It is Class 3 (SELV); is designed for connection to a power supply matching that detailed on the rating label and compatible with the plug fitted.

If an extension lead is required, use an approved and compatible lead rated for this appliance. Follow all the instruction supplied with the extension lead.

This product requires no earth connection as supplementary insulation is applied to the basic insulation to protect against electric shock in the event of failure of the basic insulation.

6. TECHNICAL DESCRIPTION

6.1 IDENTIFICATION

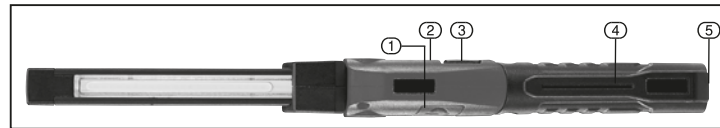

- ① On/off switch
② Battery indicator
③ Charger socket
④ Pocket clip
⑤ Magnet

6.2 WHAT'S IN THE BOX?

Carefully remove the pocket slim light from the packaging and examine it for any sign of damage that may have happened during shipping. If any part is damaged or missing, please contact the Draper Helpline (the telephone number appears on the Title page) and do not attempt to use the light.

- ⑥ Type-C USB cable

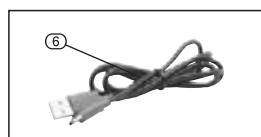

7. UNPACKING & CHECKING

7.1 PACKAGING

Carefully remove the pocket slim light from the packaging and examine it for any sign of damage that may have happened during shipping. If any part is damaged or missing, please contact the Draper Helpline (the telephone number appears on the Title page) and do not attempt to use the light.

Warning! Some of the packaging materials used may be harmful to children. Do not leave any of these materials in the reach of children. If any of the packaging is to be thrown away, make sure they are disposed of correctly, according to local regulations.

8. PREPARING THE POCKET SLIM LIGHT

8.1 CHARGING

Important: Fully charge for at least 8 hours before first use.

Make sure the light is switched off before commencing charging.

To charge it, connect the cable into the socket under the dust cover, then connect it to either a mains power supply or a USB power source.

The battery indicator will start flashing a green LED to indicate that it is charging. Once it is fully charged, the battery indicator will go solid green.

Note: Disconnect from the mains as soon as the charge is complete. Unplug the charging lead from the light.
Note: Do not leave the battery in a fully discharged condition. Recharge it at least once every 30 days and always fully charge it.

9. OPERATING THE POCKET SLIM LIGHT

9.1 USING THE ON/OFF SWITCH – FIG. 1

The first press of the on/off switch (1) will operate the top light.

The second press will operate the low mode of the main light.

The third press will operate the high mode of the main light.

The fourth press will operate the back light.

The fifth press will turn the light off.

Direct the lens away from eyes before switching on.

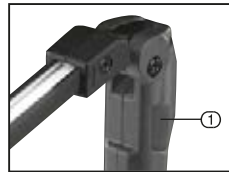

FIG. 1

10. MAINTENANCE

10.1 MAINTENANCE

Keep light clean and check for damage before every use. If damage is observed remove from use until it is repaired.

Note: There are no user serviceable parts on this light. For battery replacement etc, please return to your nearest Draper authorised dealer for repair.

Important: LED arrays are designed to allow individual LEDs to cease functioning without causing the entire array to fail. This could be as a result of shock or impact. Shock or impact with invalidate warranty.

11. EXPLANATION OF SYMBOLS

11.1 EXPLANATION OF SYMBOLS

	Class III construction (separated extra-low voltage (SELV)).		Protected against water splashing from any angle.
	WEEE Do not dispose of Waste Electrical & Electronic Equipment in with domestic rubbish.		Non-Self-Resetting protective device.
	For indoor use only. Do not expose to rain.		Short-circuit-proof safety isolating transformer.

12. DISPOSAL

12.1 DISPOSAL

- At the end of the product's working life, or when it can no longer be repaired, ensure that it is disposed of according to national regulations.

- Contact your local authority for details of collection schemes in your area.

- Waste Electrical & Electronic Equipment.

In all circumstances:

- Do not dispose of power tools with domestic waste.
- Do not incinerate.
- Do not abandon in the environment.
- Do not dispose of WEEE as unsorted municipal waste.