



OPERATOR'S MANUAL AND PARTS LIST
80lb Spreader - THS80

Spares & Support: 01793 333212

www.thehandy.co.uk

Before use please read & understand this manual, paying particular attention to the safety instructions.

23/05/2011

1. HELPFUL HINTS:

READ THE DIRECTIONS BEFORE ASSEMBLY

WHEN ALL ELSE FAILS, READ THE DIRECTIONS AGAIN

- If your spreader does not spread evenly, be sure the FRONT on the gear box points to the front of the spreader. The impeller must turn clockwise. Reversing the gear box will cause the impeller to turn counter clockwise. Clean the impeller plate after each use. Fertilizer stuck on the impeller blades will cause uneven spreading.
- Your spreader is designed to be pushed at three miles per hour, which is a brisk walking speed. Slower or faster speeds will change the spread patterns. Wet fertilizer will also change the spread pattern and flow rate. Clean your spreader thoroughly after each use. Wash between the shut off plate and bottom of the hopper.
- Gears are permanently lubricated at the factory. Do not open the gear box or dirt may enter.

2. Remove and identify loose parts from carton and bag.

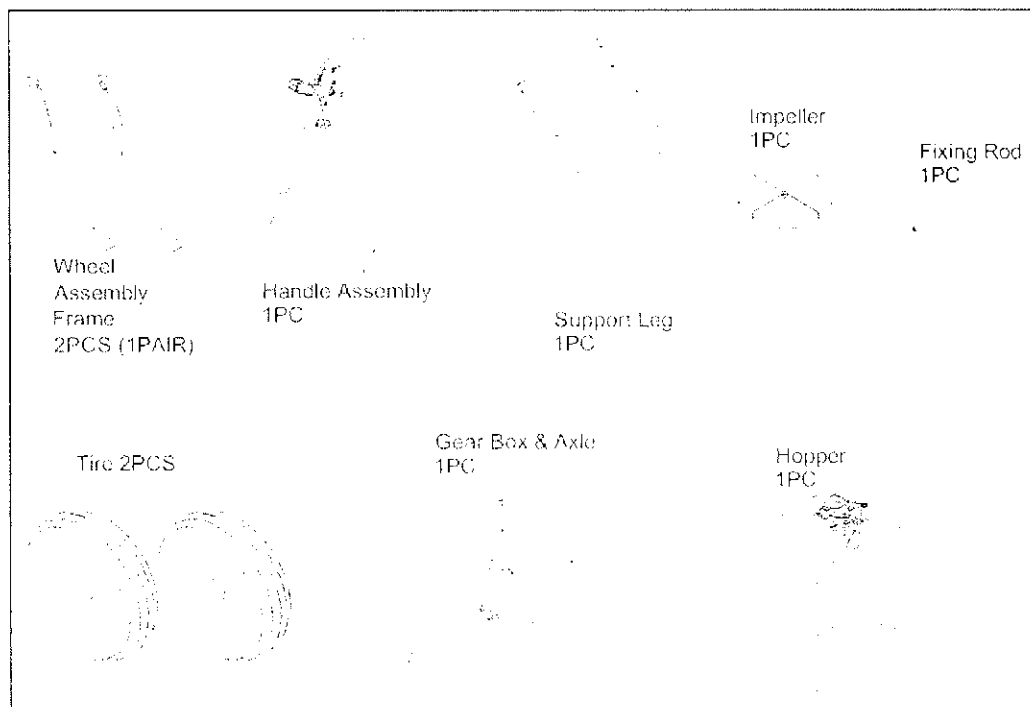
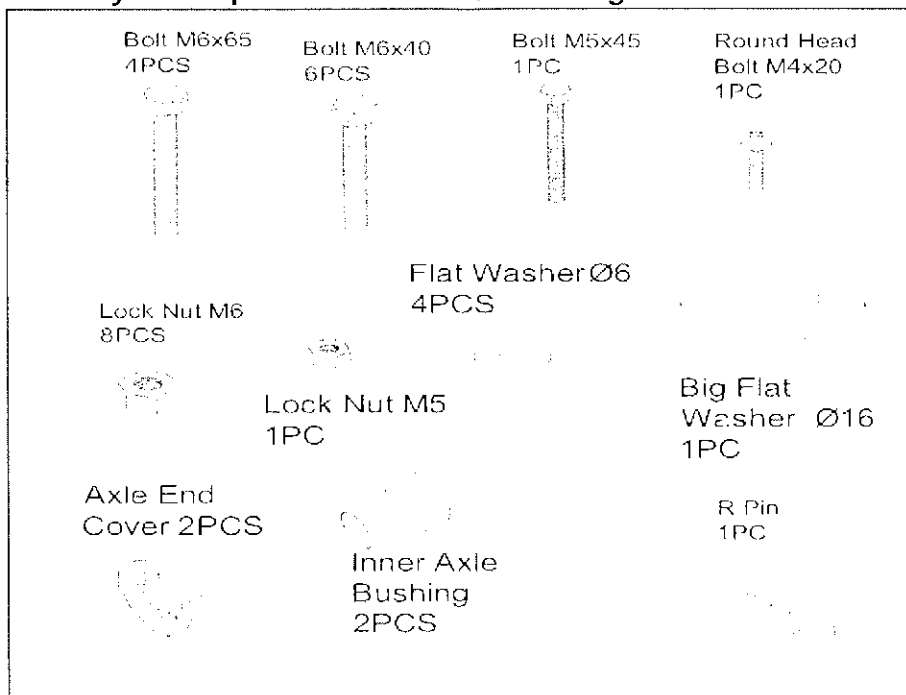

STEP 1: Install impeller onto the Gear Box & Axle Assembly. Insert Screw M4x20 through impeller then through Gear Box Axle.

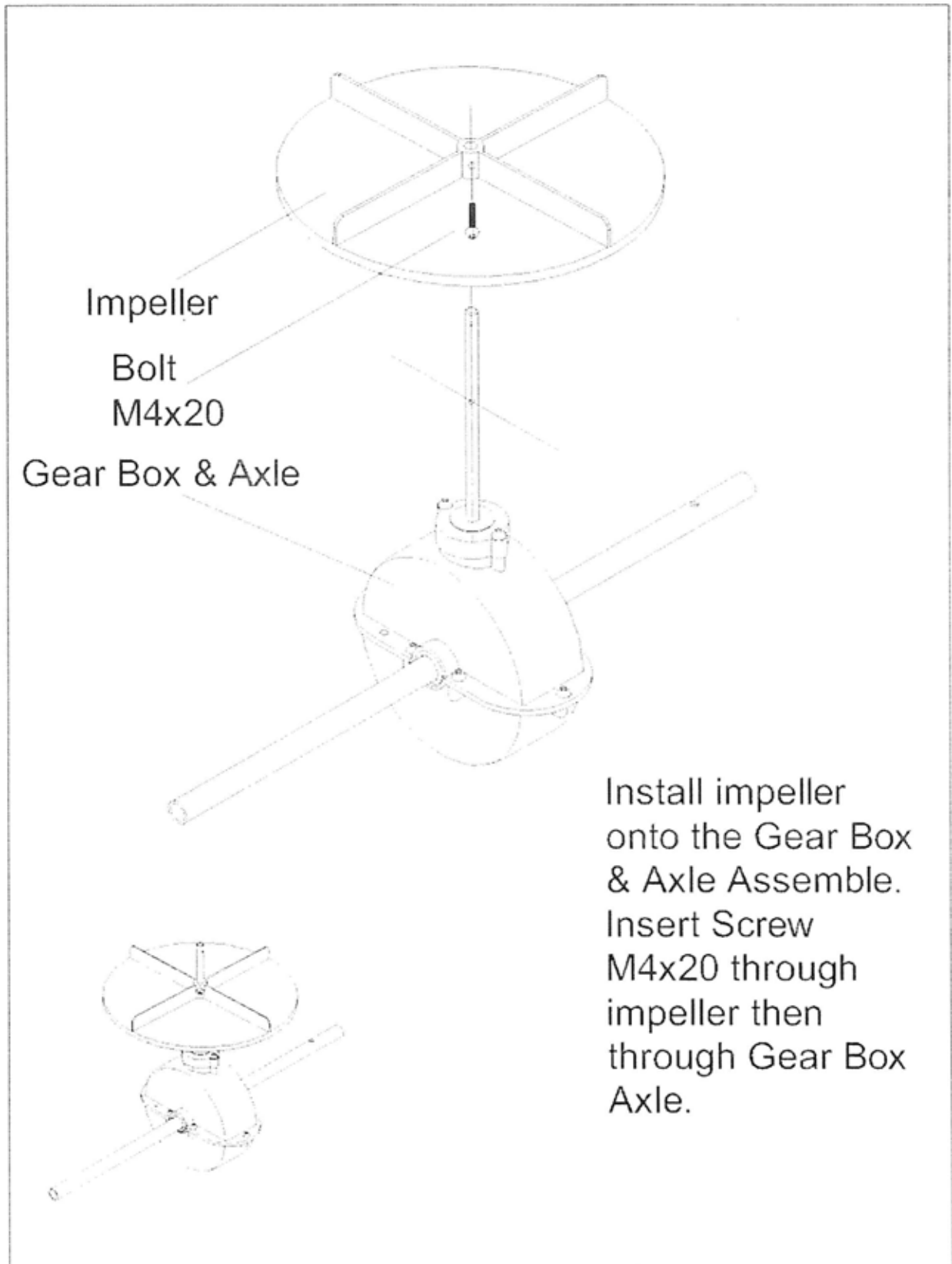

STEP 2: Attach the Wheel Assembly Frame on each side of the Gear Box Axle and Fixing Connecting Rod, insert two bolts M6x40 into the Fixing Connecting Rod through Wheel Assembly Frame. Make sure the hole on Axle of Gear Box is on the right side when assembly as shown. Attach Wheel Assembly Frames and Support Leg onto Hopper using bolts M6x65, nuts M6 and Flat Washers Ø6. Note: The bolts and nuts needn't be tightened yet.

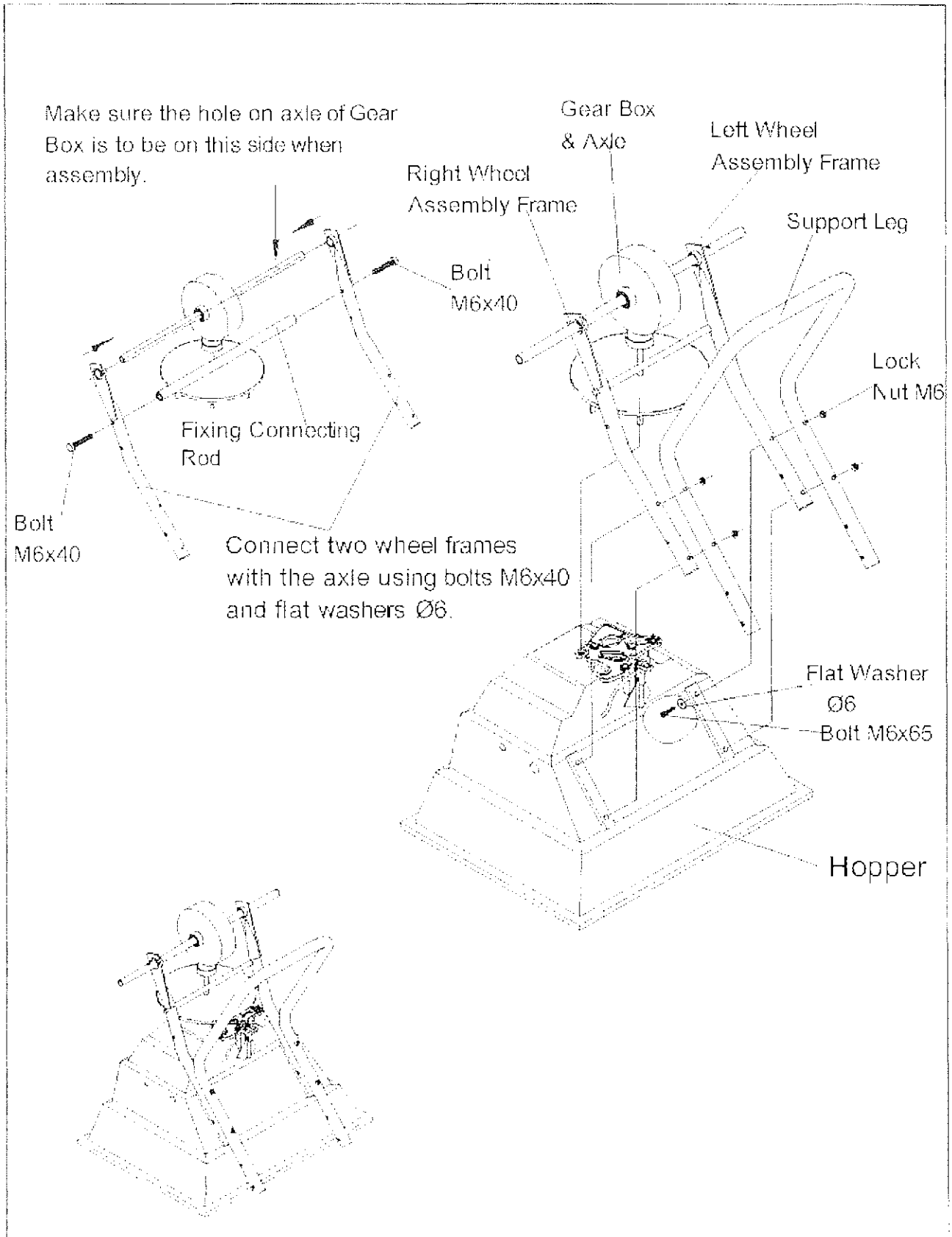

STEP 3: Insert Inner Axle Bushing into Outer Axle Bushing and make sure they are tight neatly. Install right Tire Assembly to right Axle using bolt M5x45 and lock nut M5, and then install the Cap onto right Axle using a wooden or rubber hammer. Now install left Tire Assembly to left Axle, put a flat washer Ø16 and install the Cap onto left Axle using a wooden or rubber hammer.

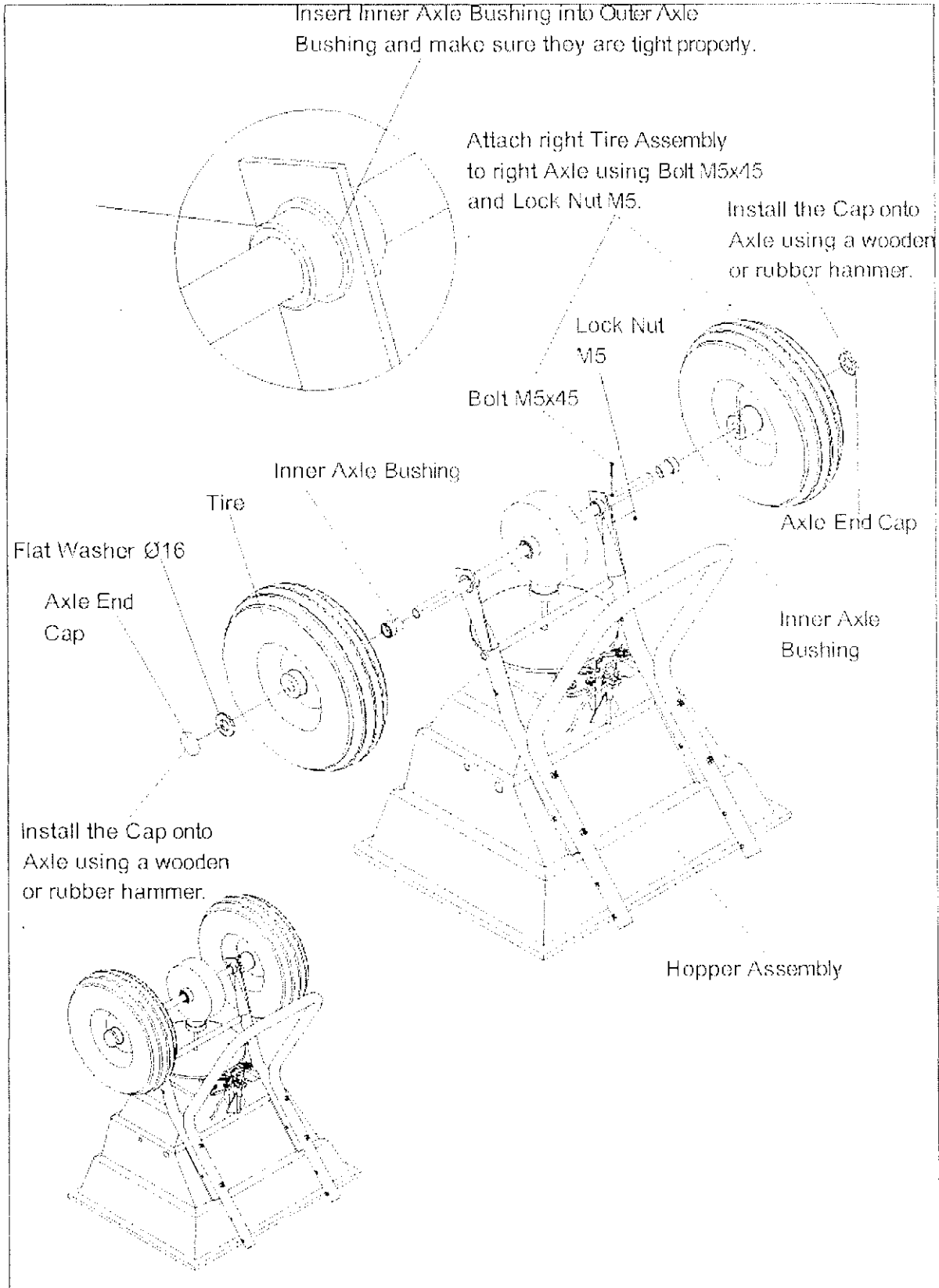

STEP 4: Insert Upper Handle into the Support Leg and tighten using bolts M6x40 and Lock Nuts M6. **NOW GO BACK AND TIGHTEN ALL NUTS AND BOLTS STARTING WITH FIRST STEP. DO NOT OVER TIGHTEN.**

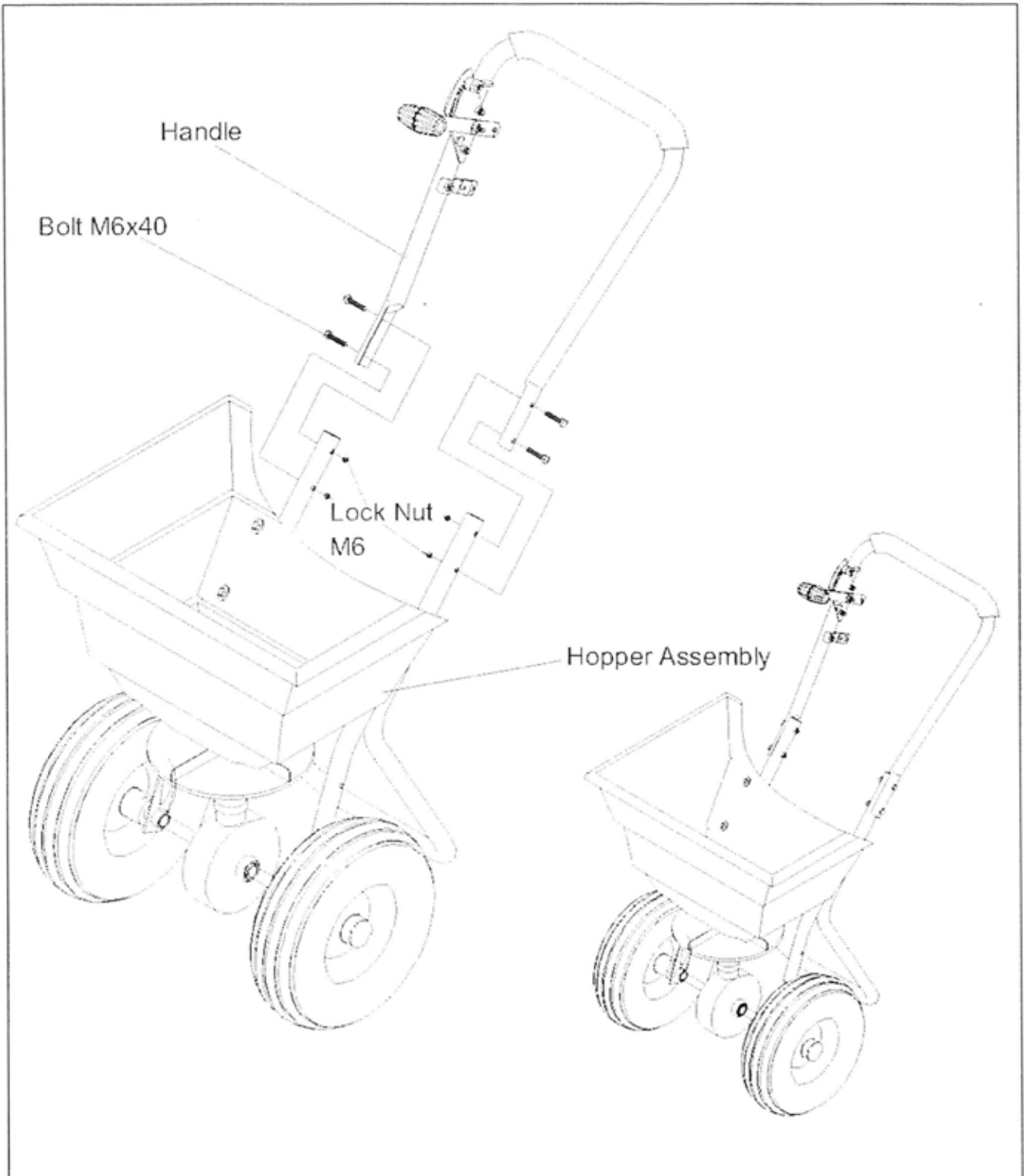

STEP 5: (1) Insert the Steel Wire head of control cable into the small hole on Gauge and Lever Assembly. (2) Release two bolts M5x10 and nuts on Press Plate. (3) Put the Plastic Tube into the slot of Press Plate. (4). Tighten two bolts M5x10 and nuts again.

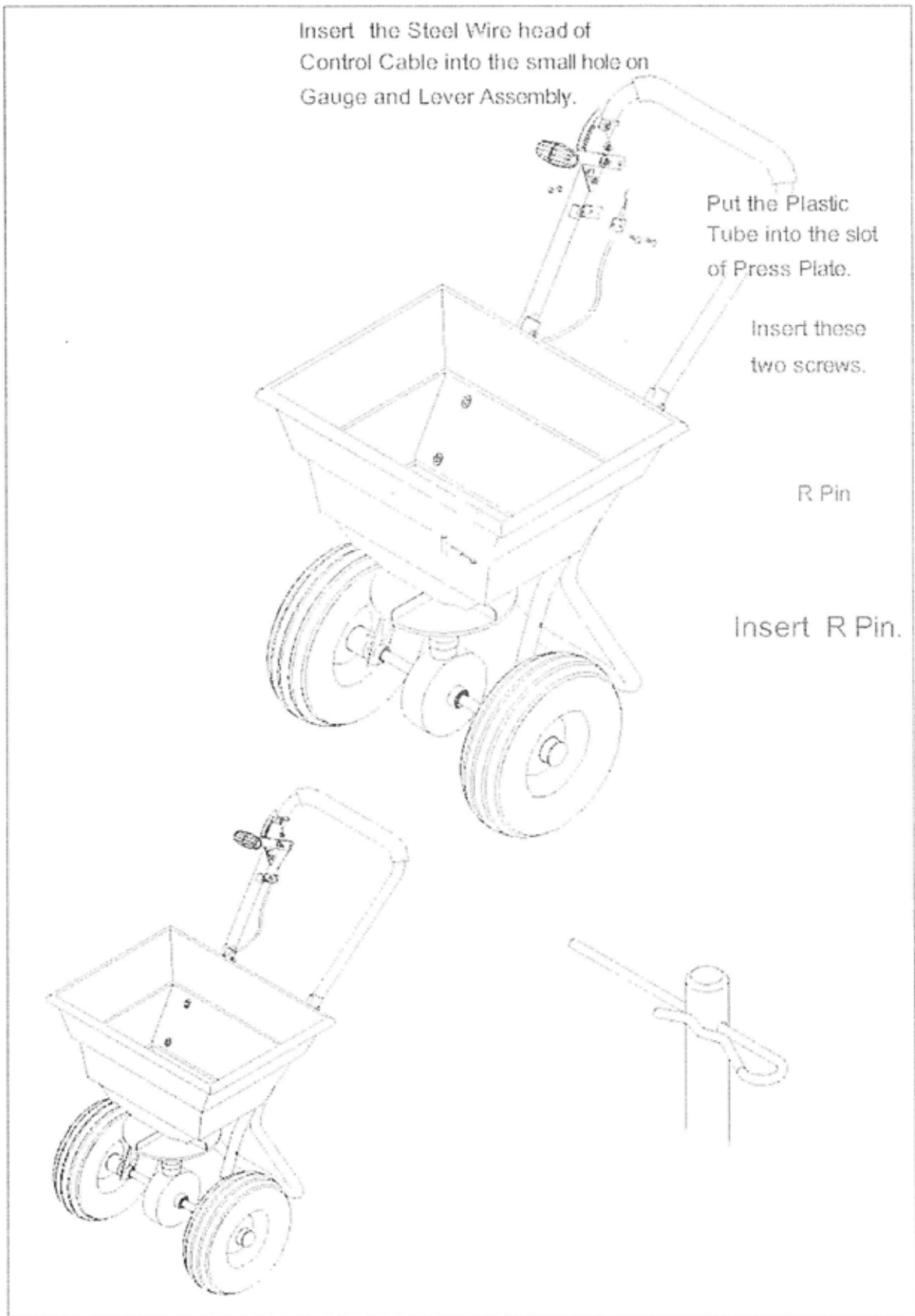

STEP 6: ADJUSTMENTS. When you have finished all above steps, and if you find the three big holes at the bottom of hopper just match the three holes of adjustable plate. You don't need to do the following steps. If they do not match neatly, you may need to do the following steps. (1)Release two bolts M5x10 on clamp as shown. (2). Push the handle to the lowest position <downwards>, use your hand to adjust the adjustable plate so as to make sure three big holes at the bottom of hopper just match the threes holes of adjustable plate neatly. (3). And then tighten the bolts and nuts on clamp again.

To operate this spreader, push the handle to the top position (upwards). You may move the position of Wing nut on Gauge & Lever to adjust the spacer on the three holes between the hopper and the adjustable plate as per your requirements when spreading.

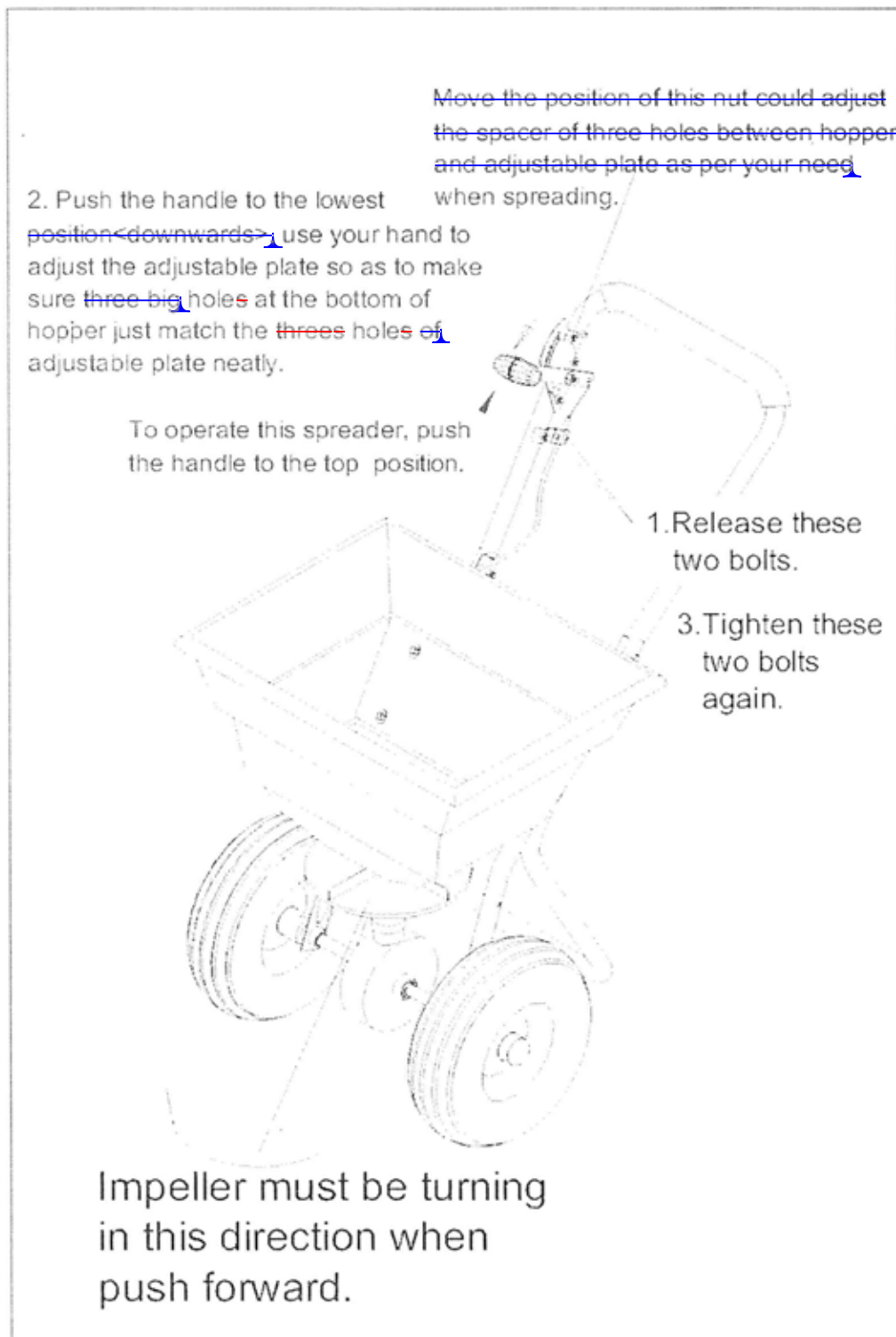

OPERATING INSTRUCTIONS

Before filling the hopper, become familiar with the operation of this spreader.

- Check the proper setting for the material to be used in the RATE SETTING CHART included with this spreader.
- Move the stop bolt on the rate gauge assembly to the proper setting.
- While pushing the spreader forward, pull the control lever back to the stop bolt.
- Before you stop moving, push the lever forwards to close the flow holes.
- When finished, empty any remaining material from the hopper.
- Thoroughly wash the spreader and allow it to dry before storing. No oiling is necessary.
- Remove the agitator when using Rock Salt to prevent gearbox damage.

SUGGESTED WALKING PATTERN

FULL RATE SETTINGS

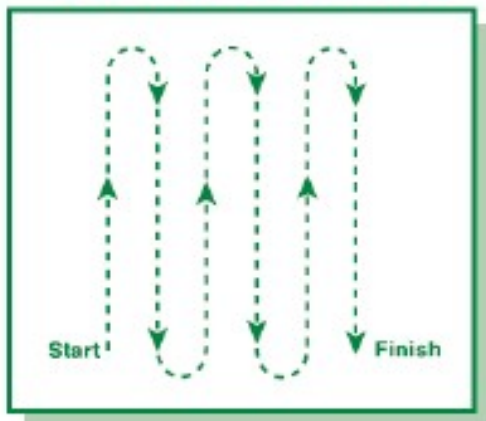

HALF RATE SETTINGS

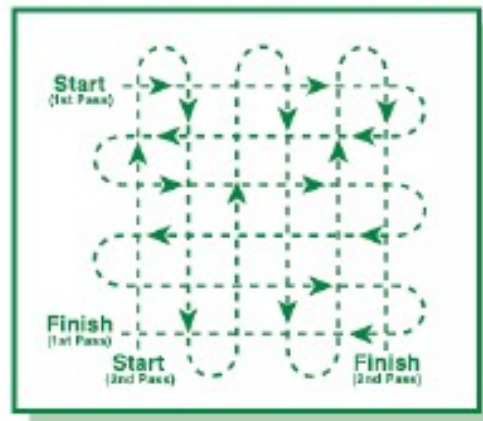

PRECISION SPREADERS SUPPLEMENTARY INSTRUCTIONS FOR UK MATERIALS

USING YOUR SPREADER

Precision spreaders are designed to spread dry, powdered or granulated, materials thinly and evenly over any reasonably smooth surface.

Proceed as follows

1. Make certain that the material is dry and "free running". If in doubt pass it through a sieve with 3mm (1/8") mesh to remove lumps.
2. Set rate-setting dial to No2.
3. Fill the hopper approximately $\frac{3}{4}$ full.
4. Push the spreader forward and open feed gate (push knob down) whilst in motion. If spread is uneven or inadequate pull up lever and re-set micro-dial to a higher number. Repeat until satisfactory distribution is obtained.

N.B. ALWAYS MOVE OFF BEFORE OPENING FEED-GATE.ALWAYS CLOSE FEED-GATE BEFORE STOPPING.

SUGGESTED SETTINGS FOR POPULAR TURF DRESSINGS:

MANUFACTURER	PRODUCT NAME OR ANALYSIS	SEASON OF USE	RECOMM ENDED APPLICAT ION RATE		GUIDE SETTING
			G/M2	OZ'S/YD2	
FISONS	EVERGREEN 90		35	1	18
	EXTRA		35	1	16
	LAWNFOOD		35	1	16
	MOSSKILL		35	1	16
EIGBY TAILOR	9.7.7/7.7.7./3.12.12	Spring & Autumn	70	2	28
PROFESSIONAL	10.15.10/12.6.6.	Spring & Autumn	35	1	24
	ORGANIC N	Spring	35	1	16
	MINIGRAN	All Seasons	35	1	20
	MICRO FINE	All seasons	35	1	16
J A BOWERS	FEED & WEED		70	2	24
	MOSSKILLER		70	2	24
	LAWNSAND		140	4	20
	LAWNFOOD	Spring & Autumn	70	2	28
	LAWNFOOD	Autumn	70	2	28
PEACOCK	ICE MELTER	Winter (Paths)	150	4	20
P.B.I.	TOPLAWN	Autumn & Winter	60	2	20

O.M.SCOTT	WINTERIZER	Autumn & Winter	20	½	12
	MOSS CONTROL	Autumn	20	½	12
	LAWN BUILDER	Spring & Summer	20	½	12
ICI PROFESSIONAL	SPORTSFIELD	Spring & Summer	35	1	16
	(RANGE)	Autumn Feed	35	1	16
		Nitro Green Plus	35	1	16
	FINE TURF	Spring & Summer	35	1	16
	(RANGE)	Autumn Feed	35	1	16
		Fine Green N.K.	35	1	16
		Nitro with Iron	35	1	16
	STANDARD	Spring & Summer	35	1	16
	(RANGE)	Autumn Feed	35	1	16
ICI HOMEOWNER	GRASSHOPPER	Apr, May, June, Sept	52	1.5	12
	LAWNFEED	Apr-Aug Inclusive	70	2	16
	MOSSKILLER	Mar-Oct Inclusive	70	2	16
VITAX	WEED & FEED	Spring & Summer	35	1	8
	WEED & MOSSKILL	Spring	70	2	12
	Q4 RANGE		35	1	8
	KEY N	Spring & Summer	35	1	16
GROWERS RANGE	FINE X	Mar-Aug Inclusive	35	1	16
	FINE X	Mar-Aug Inclusive	70	2	20
	LAWNSAND	Spring & Summer	35	1	12
	LAWNSAND	Spring & Summer	140	4	24
	TURF TONIC	Any Time	35	1	12
	TURF TONIC	Any Time	70	2	16
	WEED & FEED EXTRA	Apr-Sept Inclusive	35	1	16
	WEED & FEED EATRA	Apr-Sept Inclusive	70	2	12
	CF GRAN 1&4	Spring & Summer	35	1	24
	CF GRAN 2	Autumn & Winter	35	1	24
	MICRO GRAN 1,3&4	Spring & Summer	35	2	8
	MICRO GRAN 2	Autumn & Winter	70	2	12
PARKER	No.1	Spring & Summer	35	1	12
	No.2	Spring & Summer	35	1	12
	No.4	Autumn & Winter	35	1	12
	No.5	Spring & Summer	35	1	8
	No.6	Spring & Summer	35	1	8
	No.7	Autumn & Winter	35	1	8
VARIOUS	GROMORE (Granules)	Spring & Summer	35	1	24

N.B. the above settings are suggestions only. Even branded materials may vary in grain size, humidity, Density etc. If you are in doubt either (1) Choose a lower setting than that suggested above or (2) Start at dial setting No.2 and progressively dial higher numbers until an even spread is achieved. Lock the dial clamp and apply material. This will, give rather less than the manufacturers of the material recommends.

PARTS DRAWING

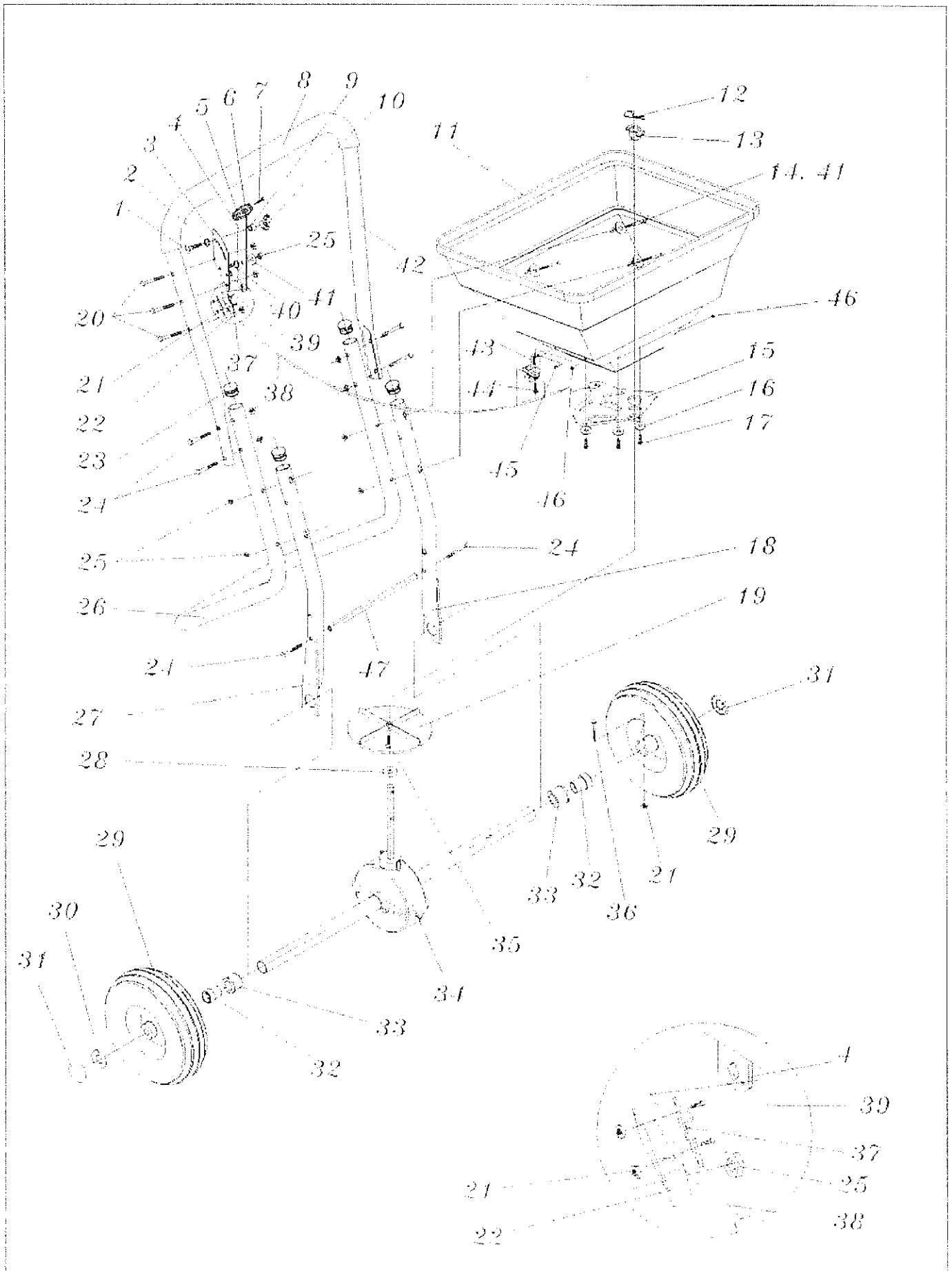

PARTS LIST

Ref#	Description	Qty	Ref#	Description	Qty
1	Bolt M6x25	1	25	Lock Nut M6	12
2	Lock Washer Ø8	1	26	Support Leg	1
3	Gauge and Lever Assembly	1	27	Wheel Assembly Frame(Right)	1
4	Adjust Handle Pole	1	28	Thin Washer	1
5	Adjust Handle A	1	29	Pneumatic Wheel	2
6	Adjust Handle B	1	30	Flat Washer Ø16	1
7	Screw Ø4x18	1	31	Axle End Cover	2
8	Handle Grip	1	32	Inner Axle Bushing	2
9	Spacer	1	33	Outer Axle Bushing	2
10	Wing Nut	1	34	Gear Box & Axle Assemble	1
11	Hopper	1	35	Screw M4x20	1
12	R Pin Ø2x60	1	36	Bolt M5x45	1
13	Center Cover	1	37	Line Clamp Press Plate	1
14	Bolt M6x65	4	38	Control Rod	1
15	Adjustable Plate	1	39	Screw M5x10	2
16	Big Flat Washer Ø4	3	40	Nylon Washer	1
17	Screw Ø4x12	3	41	Big Flat Washer Ø6	5
18	Wheel Assembly Frame(Left)	1	42	Handle	1
19	Impeller	1	43	Line Clamp	1
20	Bolt M6x35	3	44	Screw Ø5x15	1
21	Lock Nut M5	2	45	Big End Cap	1
22	Line Clamp Bottom Plate	1	46	Small End Cap	2
23	Tube End Cap	4	47	Fixing Connection Rod	1
24	Bolt M6x40	4			

To order spare parts and see the complete range of garden machinery and garden equipment from Handy, visit:

www.thehandy.co.uk

Spares & Support: 01793 333212

