



**THTPDC  
650LB TOWED POLY DUMP CART**



**OPERATOR'S MANUAL AND PARTS LIST  
650lb Towed Poly Dump Cart - THTPDC**

Spares & Support: 01793 333212

**[www.thehandy.co.uk](http://www.thehandy.co.uk)**

**Before use please read & understand this manual, paying particular  
attention to the safety instructions.**



# SAFETY INSTRUCTIONS

Remember, any power equipment can cause injury if operated improperly or if the user does not understand how to operate the equipment. Exercise caution at all times when using power equipment with this product.

1. Read this owner's manual before attempting to assemble or operate the cart.
2. Read the vehicle owner's manual and know how to operate your vehicle before using the cart attachment.
3. Do not at any time carry passengers in this cart. It has not been designed to carry passengers.
4. Never allow children to operate the tractor or the cart attachment.
5. Do not allow anyone who has not read these instructions to operate the tractor or cart attachment.
6. Always begin operation with the transmission in first (low) gear and gradually increase speed as conditions permit.
7. When towing the cart over rough terrain, hillsides or near creeks and ditches reduce your speed to avoid losing control of the cart or tipping it over. Do not drive too close to a creek or ditch.
8. Vehicle braking and stability may be affected with the attachment of this cart. Do not fill cart to the maximum weight capacity without checking the capability of the towing vehicle to safely pull and stop with the cart attached.
9. Before operating a vehicle on any gradient (hill) refer to the safety rules in the vehicle owner's manual concerning safe operation on slopes. Refer also to the slope guide on page 9 of this manual. **Stay off steep slopes!**
10. Do not tow this cart on public roads or thoroughfares.
11. The maximum towing speed is 10m.p.h.
12. Follow the maintenance and lubrication instructions as outlined in this manual.

## WARNING

The warnings, cautions, and instructions outlined in this instruction manual cannot cover all possible conditions or situations that may occur. The operator must use their own common sense and be cautious.

### **Assembly Is Required**

This product requires assembly before use. See the "Assembly" section for instructions. Because of the weight and size of the cart, it is recommended that another adult be present to assist with the assembly. **INSPECT ALL COMPONENTS** closely upon receipt to make sure no components are missing or damaged.

## ASSEMBLY INSTRUCTIONS

1. Remove the hardware pack and all loose parts from the carton. Be sure the carton is empty before discarding.
2. Insert the latch lock between the latch mount brackets and connect them using an M6x20 hex bolt and a M6 lock nut. Tighten so that the latch lock can still pivot. Attach the extension spring to the latch lock and the latch mount bracket as shown in figure 1.
3. Insert the  $\text{\O}13 \times 28$  clevis pin through the holes in the latch mount brackets and secure with an  $\text{\O}3 \text{ R}$  pin.

Figure 1

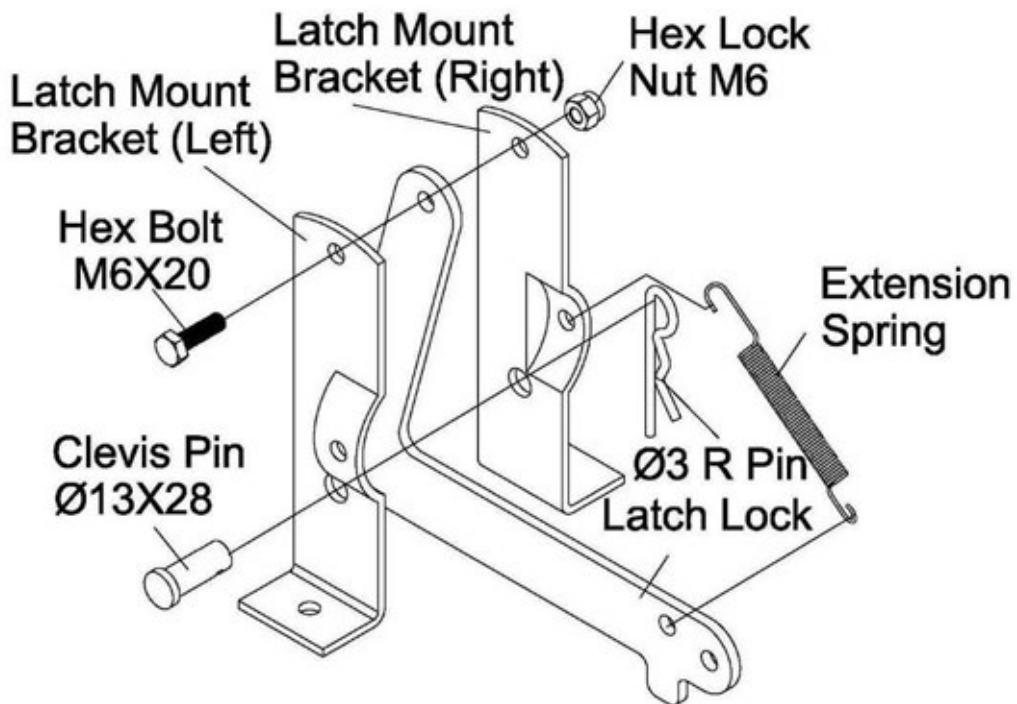

4. Attach the latch lock subassembly to draw bar B using two M6x16 hex bolts and M6 lock nuts. Tighten.

Figure 2

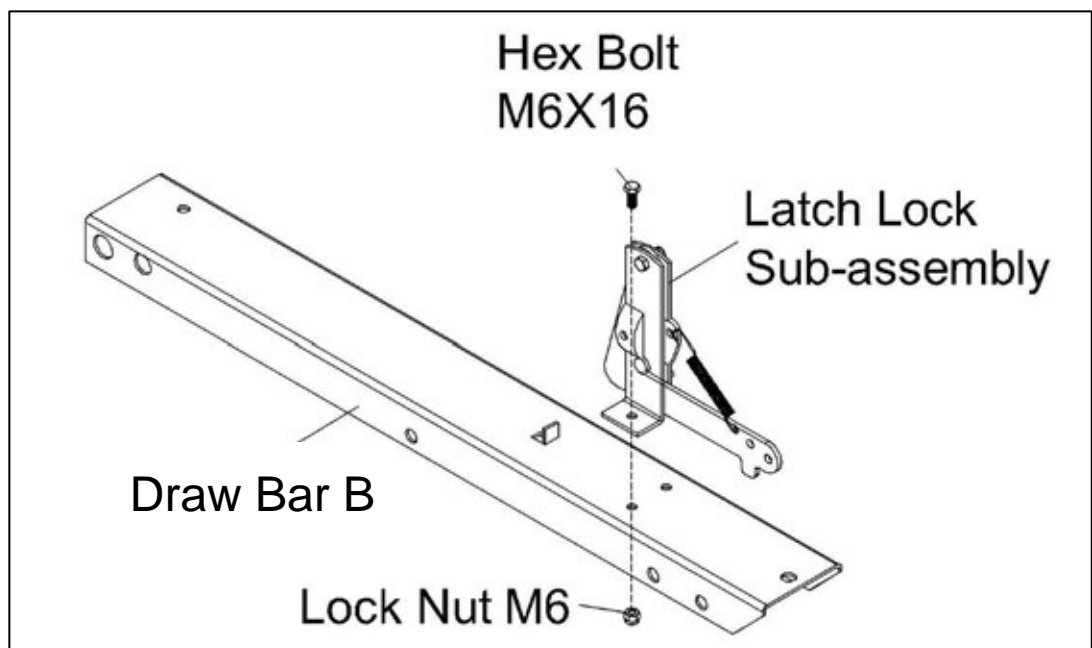

5. Lay draw bar B (open side facing up) onto the Wheel Support. Insert the axle through the wheel support and draw bar B. See figure 3.

**Figure 3**

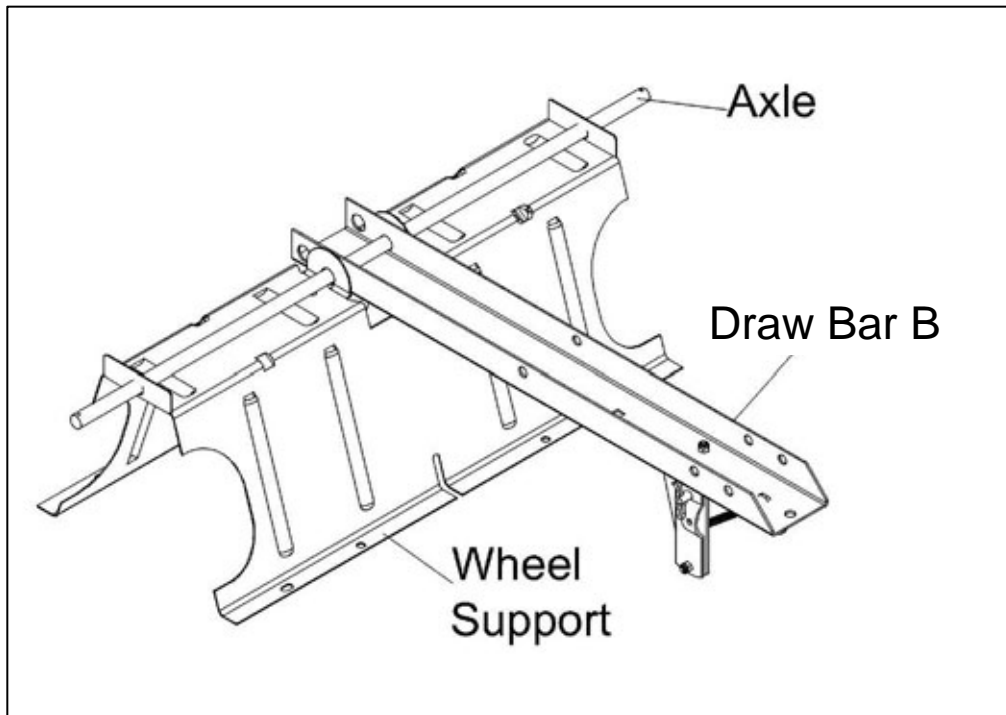

6. Connect the hitch bracket to draw bar A using two M8 lock nuts. Tighten. See figure 4.
7. Attach the leg stand bracket to draw bar A using two M8x20 hex bolts and M8 lock nuts. Tighten.

**Figure 4**

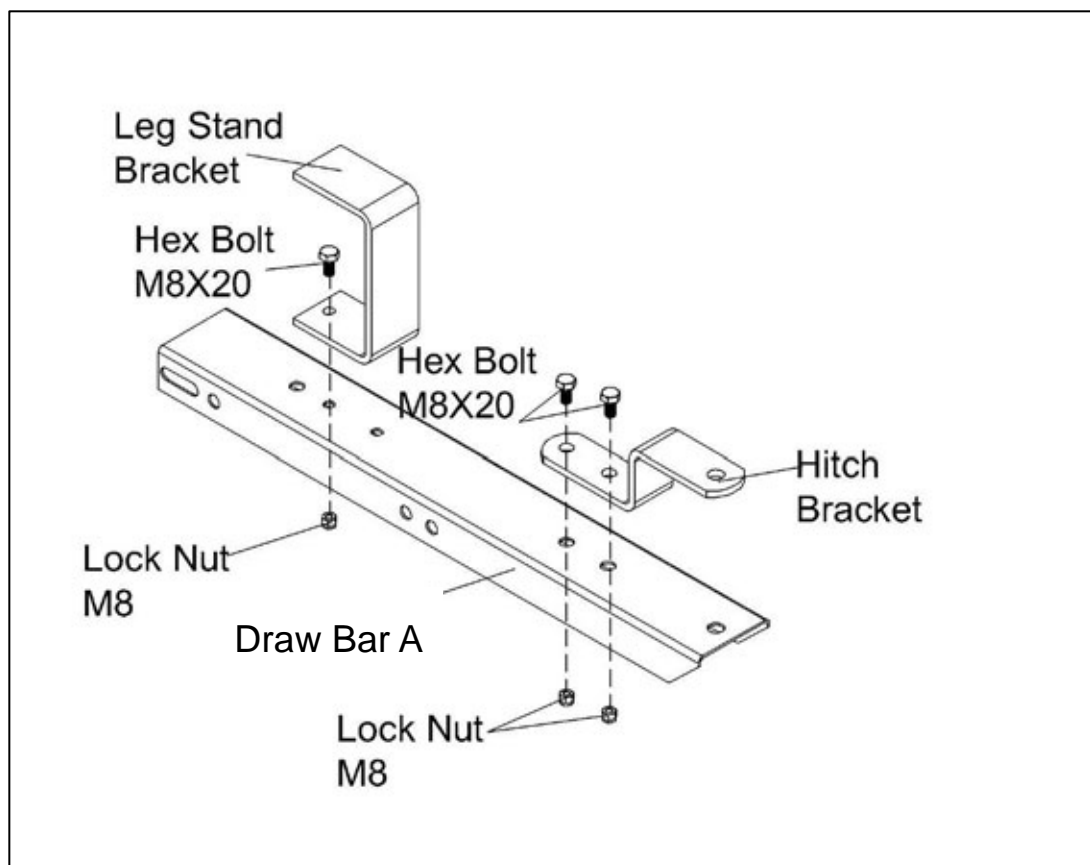

- Place draw bar A inside draw bar B as shown in figure 5. Fasten the draw bar sections together using an M10x95 hex bolt and a M10 lock nut. Tighten, leaving the nut just loose enough that the sections of the draw bar can pivot freely. See figure 5.
- Insert the clevis pin  $\text{\O}13 \times 98$  through both parts of the draw bar and secure with an R Pin  $\text{\O}3$ , as shown in figure 5.

**Figure 5**

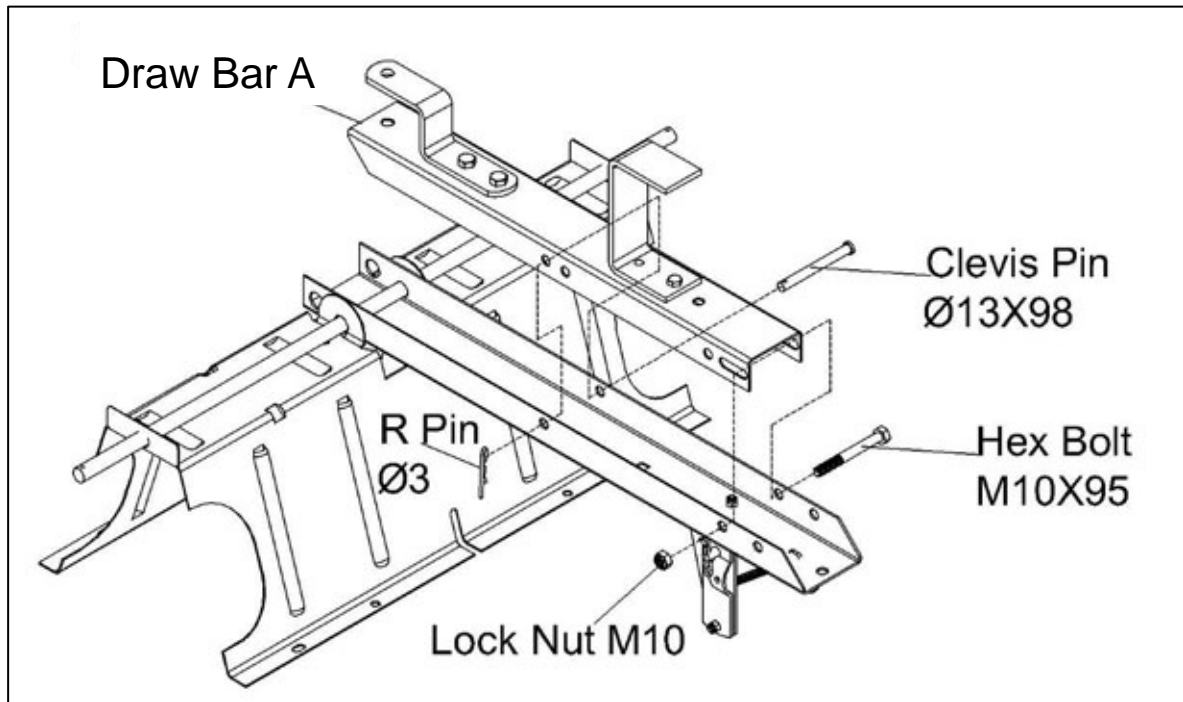

- Insert a wheel onto the axle with the valve stem facing out. Insert a Cotter Pin  $\text{\O}3 \times 25$  through the axle. See figure 6.

**Figure 6**

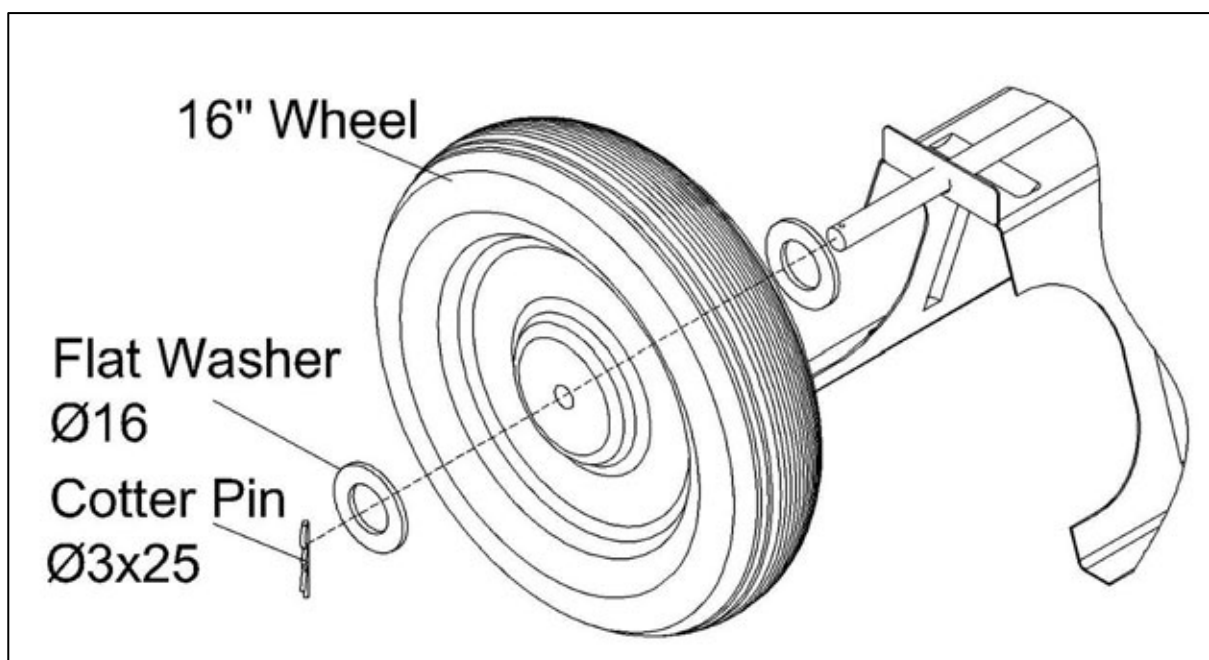

11. Turn the wheel support over to rest on the wheels. Place the latch stand bracket onto the draw bar, sliding it underneath the latch lock. Place the latch stand plate on top of the latch stand bracket as shown in figure 7. The tabs at the ends of the channels must face the rear.

**Figure 7**

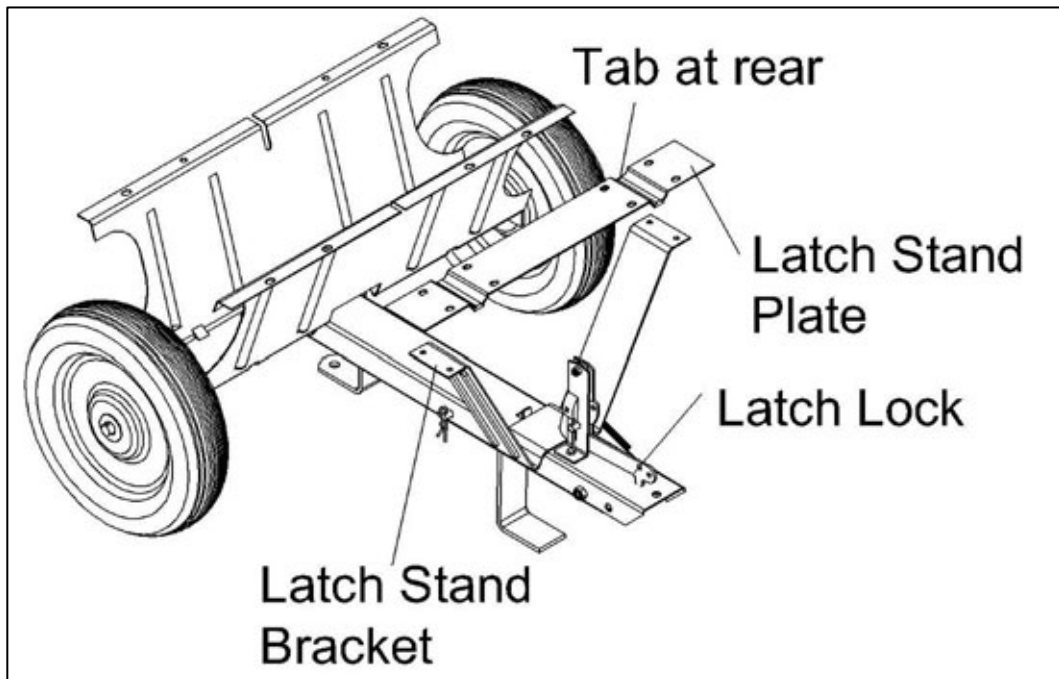

12. Place the poly tray down onto the wheel support and the latch stand plate. Fasten the tray to the wheel support using eight M8x16 flat head bolts and M8 lock nuts. Fasten the tray to the latch stand plate and latch stand bracket using four M6x16 Flat head bolts and M6 lock nuts. Do not tighten yet.

**Figure 8**

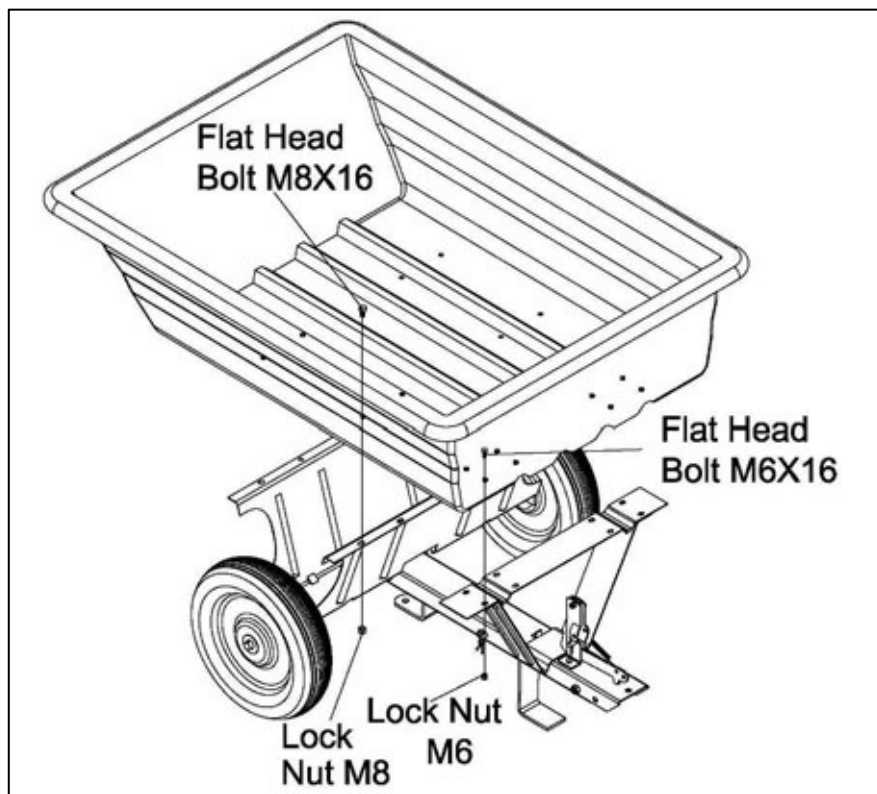

13. Insert four flat head bolts M6x16 down through the tray and the inner holes in the latch stand plate.  
Secure the bolts with four  $\text{\O}6$  big flat washers and M6 lock nuts. Do not tighten yet. See figure 9.
14. Now tighten all bolts.

**Figure 9**

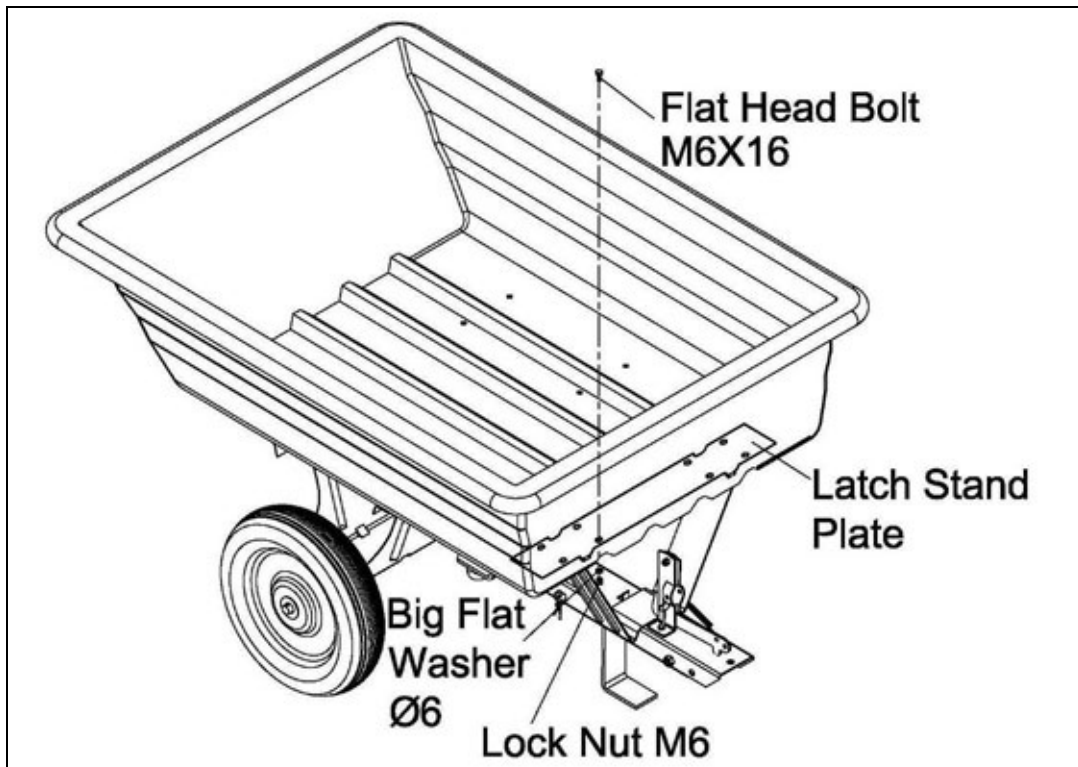

15. Slide the handle into the channels in the latch stand plate. Push the handle in all the way against the front of the tray depressing buttons in the bottom of the handle. See figure 10.
16. Place a  $\text{\O}6$  lock washer and then a  $\text{\O}6$  flat washer onto each of the two ST6.3x13 flange screws. Insert the screws into the small holes at each end of the handle. See figure 10.

**Figure 10**

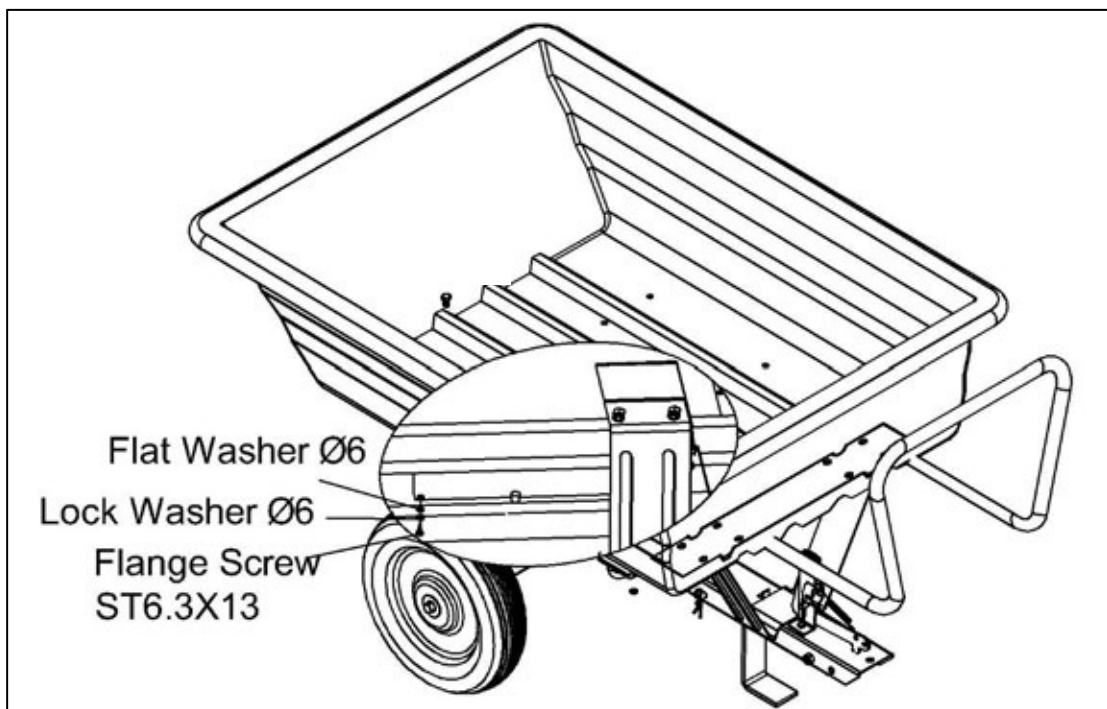
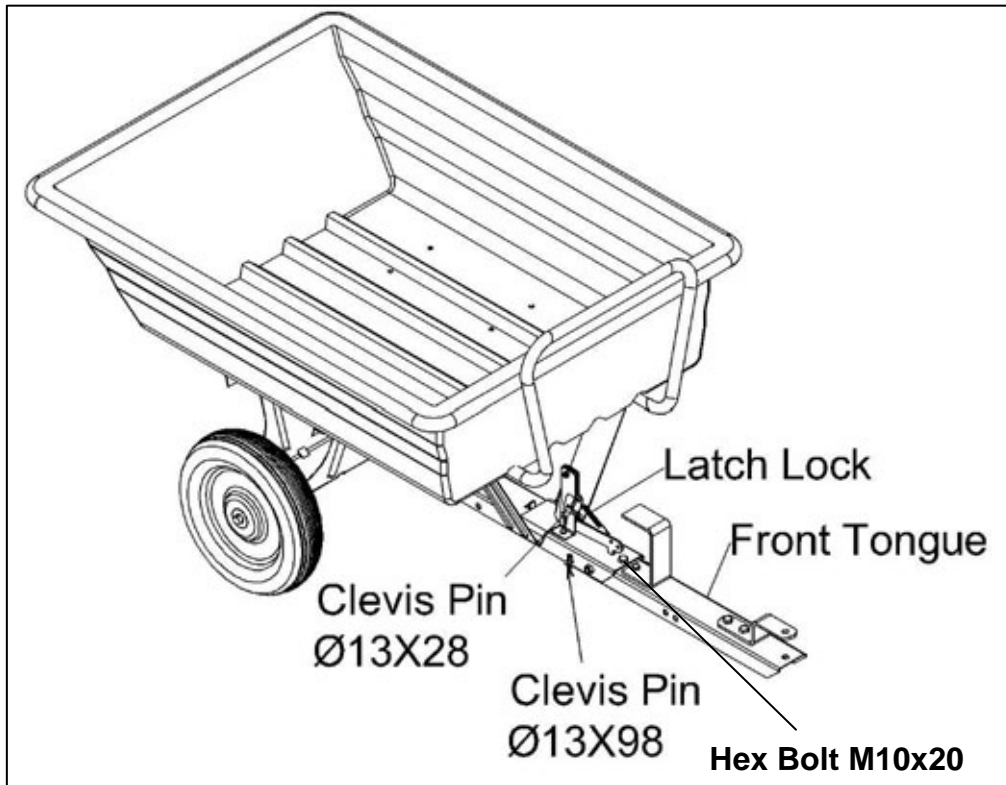

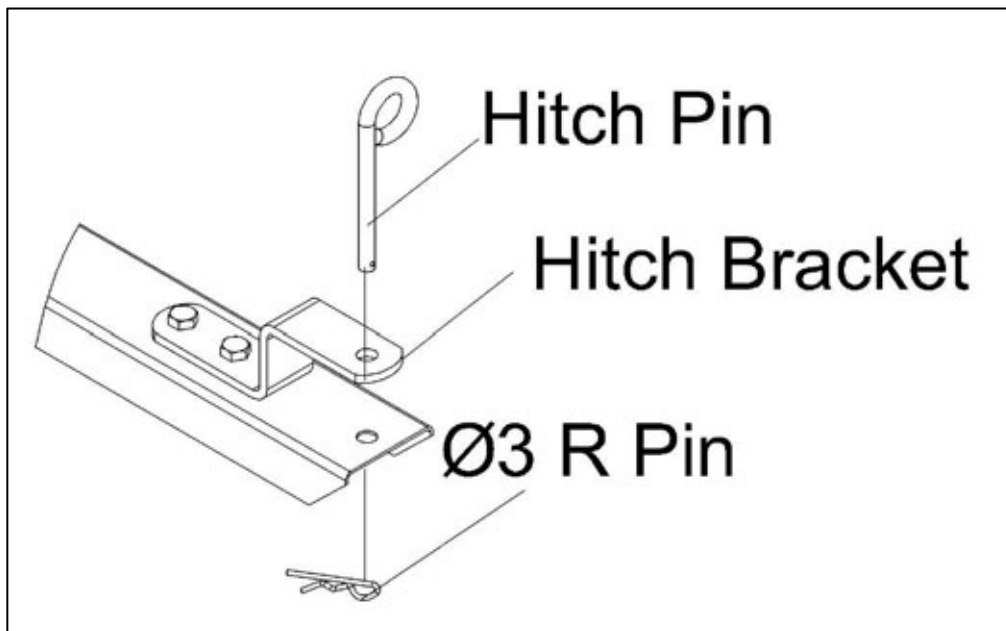

Figure 11



17. Insert the hitch pin through the draw bar and hitch bracket and secure it with the Ø3 R Pin. See figure 12.

Figure 12



# OPERATION



**CAUTION: TO AVOID POSSIBLE INJURY BE SURE THAT NO ONE IS NEAR THE CART BEFORE RELEASING THE LATCH.**

## TOW CART

1. To convert the cart for towing, remove the plastic cap from the draw bar. Remove the Ø13x98 clevis pin and R Pin which secure draw bar A in the storage position underneath draw bar B. Pivot draw bar A outward and secure it in the towing position using the same clevis pin and hairpin cotter. Push the handle in all the way against the front of the tray depressing the buttons in the bottom of the handle. Refer to figure 11 on page 8.
2. Refer to the vehicle owner's manual for instructions on safe operation on slopes.
3. Use the slope guide provided on page 9 of this manual to determine whether a slope angle is too steep for safe operation.
4. Always test to make sure your tractor has adequate towing and braking capabilities whenever hauling a substantial amount of weight in your cart. Use extra caution when operating on slopes.

## IMPORTANT!

Do Not Exceed the 650 LB. (295kg) Weight Capacity of the Cart.



**CAUTION: VEHICLE BRAKING AND STABILITY MAY BE AFFECTED BY THE CART. BE AWARE OF CHANGING CONDITIONS ON SLOPES.**

5. Distribute the weight of the load evenly in the cart to improve handling and traction.
6. To dump material from the cart, remove the clevis pin Ø13x28 from the latch on the draw bar and release the latch. The cart bed will then tilt backwards to empty its contents. After emptying, pull the front of the bed down toward the cart draw bar until the latch snaps into place. Reinstall the clevis pin in the latch to prevent accidental release of the latch.
7. The maximum towing speed for this cart is 10 m.p.h.

## PUSH CART

**Important:** Leave the latch lock clevis pin in place at all times while using the cart as a push cart. The clevis pin is shown in figure 1 on page 3.

1. To convert the cart for push operation, remove the Ø13x98 long clevis pin and R Pin Ø3 which secure the draw bar in the towing position. (See figure 11 on page 8.) Pivot draw bar A into the storage position underneath draw bar B and secure it using the Ø13x98 long clevis pin and R Pin Ø3. (Refer to figure 5 on page 5.)
2. Distribute the weight of the load evenly in the cart to improve handling and help prevent accidental tipping.

3. Do not load more weight into the push cart than you can handle and control comfortably.
4. To dump material from the push cart, lift up on the handle and tilt the cart forward. Be sure that the latch mechanism on the draw bar is locked and secured with the clevis pin to prevent accidental release of the latch.

## **MAINTENANCE**

1. At the beginning of each season, use a light machine oil to lubricate the latch, the latch pivot bolt, and the area of the axle where the draw bar pivots.
2. Grease or oil the wheel bearings periodically. Use automotive wheel bearing grease or 20 weight oil.
3. Check periodically for loose bolts.
4. Keep the tyres adequately filled. Do not exceed the tyres' recommended pressure of 12-14 PSI.

# PARTS DRAWING

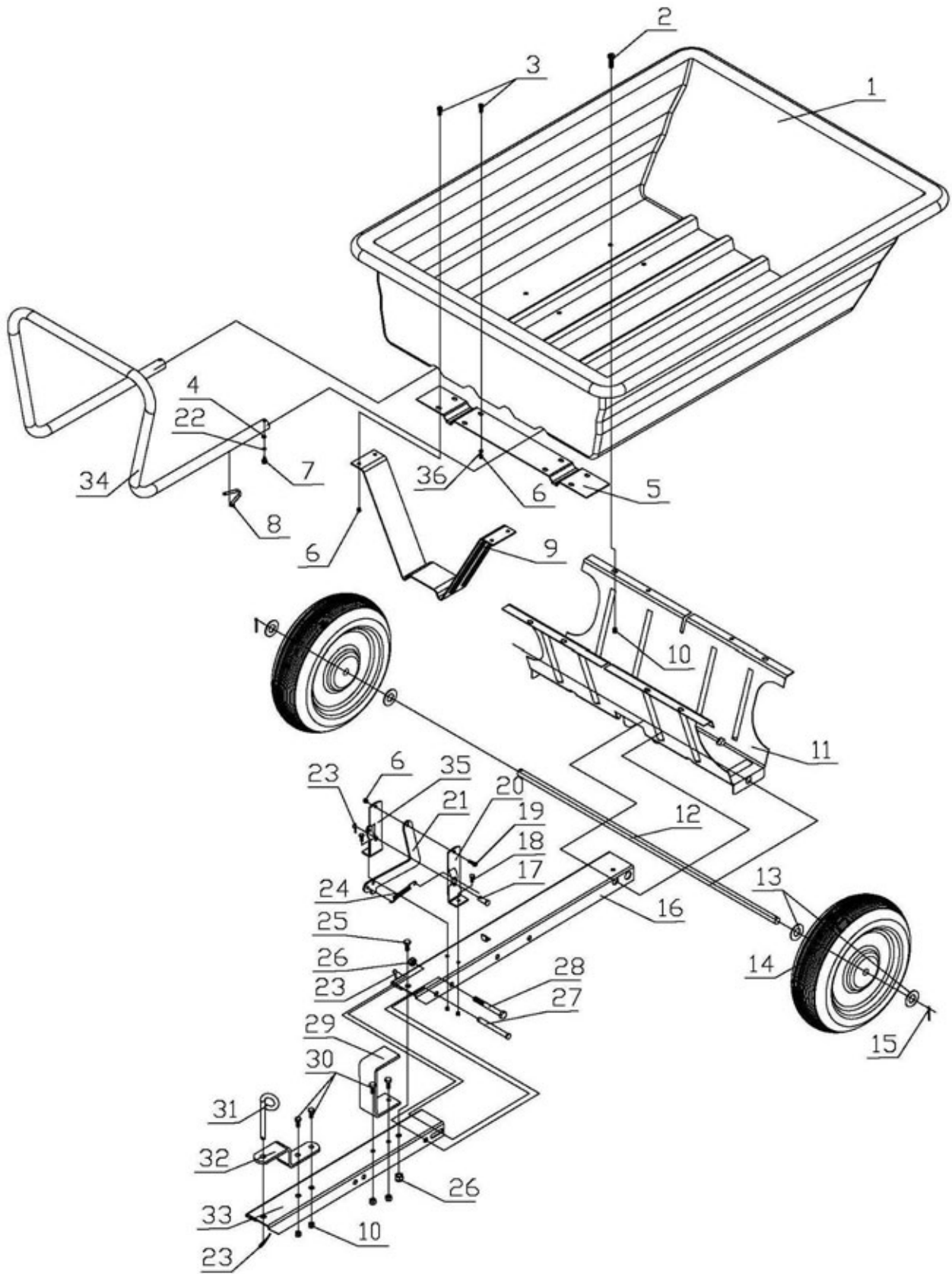

## PARTS LIST

REF #	PART NO	DESCRIPTION	QTY	REF #	PART NO	DESCRIPTION	QTY
1	TH180-1	Poly Tray	1	19	TH180-19	Hex Bolt M6x20	1
2	TH180-2	Flat Head Bolt M8x16	8	20	TH180-20	Latch Mount Bracket (Right)	1
3	TH180-3	Flat Head Bolt M6x16	8	21	TH180-21	Latch Lock	1
4	TH180-4	Flat Washer Ø6	2	22	TH180-22	Lock Washer Ø6	2
5	TH180-5	Latch Stand Plate	1	23	TH180-23	R Pin Ø3	3
6	TH180-6	Lock Nut M6	11	24	TH180-24	Extension Spring	1
7	TH180-7	Flange Screw ST6.3x13	2	25	TH180-25	Hex Bolt M10x20	1
8	TH180-8	Pin	2	26	TH180-26	Lock Nut M10	2
9	TH180-9	Latch Stand Bracket	1	27	TH180-27	Clevis Pin Ø13x98	1
10	TH180-10	Lock Nut M8	12	28	TH180-28	Hex Bolt M10x95	1
11	TH180-11	Wheel Support	1	29	TH180-29	Leg Stand Bracket	1
12	TH180-12	Axle	1	30	TH180-30	Hex Bolt M8x20	4
13	TH180-13	Flat Washer Ø16	4	31	TH180-31	Hitch Pin	1
14	TH180-14	Wheel	2	32	TH180-32	Hitch Bracket	1
15	TH180-15	Cotter Pin Ø3x25	2	33	TH180-33	Draw Bar A	1
16	TH180-16	Draw Bar B	1	34	TH180-34	Handle	1
17	TH180-17	Clevis Pin Ø13x28	1	35	TH180-35	Latch Mount Bracket (Left)	1
18	TH180-18	Hex Bolt M6x16	2	36	TH180-36	Big flat Washer Ø6	4





To order spare parts and see the complete range of garden machinery  
and garden equipment from Handy, visit:

**[www.thehandy.co.uk](http://www.thehandy.co.uk)**

Spares & Support: 01793 333212

