

## HANDLE ASSEMBLY INSTRUCTIONS

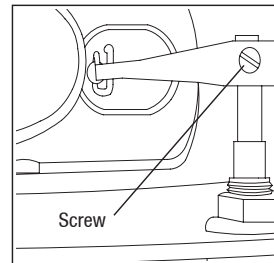

A. Lever set at 2 o'clock on right hand side of cistern (shown) or 10 o'clock on left hand side.

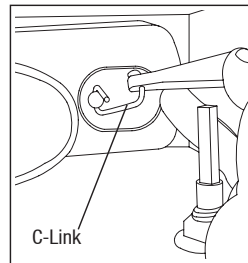
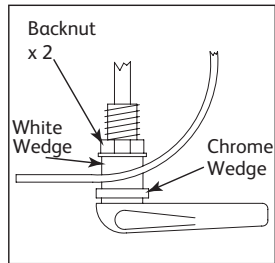

B. Overhead shot of complete cistern fittings set up – note inlet valve settings.

E. Inlet valve: Adjust the height of the telescopic inlet valve so the water fills to the waterline of 6 litres - failure to fill to this line restricts the flush and puts operating strain on the lever assembly.

### C. COMPONENTS OF LEVER LINK ARM AND WEDGES

N.B. wedges are not in lever bag but in main cistern fittings

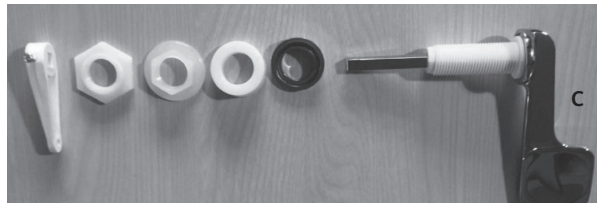

**Assembly order:**  
Lever, CP wedge, cistern shell, cream wedge, deeper back nut shallower back nut then lift arm.

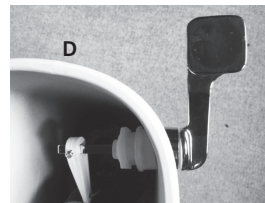

D. Lever and wedges in position with both Back Nuts Link Arm and directly above the C-Link. Ensure C Link is lifting vertically not at an angle.



## CLOSE COUPLED AND LOW LEVEL CISTERN COMPONENT PACK FITTING INSTRUCTIONS

### CONTENTS

#### CLOSE COUPLED

- Siphon
- Inlet Valve
- Bolted Close Coupling Kit
- Lever
- Fitting Pack 1 (Chrome/White wedge - Lift Arm - Backnut)
- Fitting Pack 2 (1 x White Blanking Off Plug 1 x Siphon Washer 1 x Siphon Backnut 1 x Chrome Blanking off Plug 1 x Filter)
- Basin Waste (1 x Chrome Blanking off Plug)
- Instruction Leaflet
- Close coupling washer

#### LOW LEVEL

- Siphon
- Inlet Valve
- Lever
- Cistern Support Brackets x 2
- Fitting Pack 1 (Chrome/White wedge - Lift Arm - Backnut )
- Fitting Pack 3 (1 x White Blanking Off Plug 1 x Flushpipe Bung 1 x Chrome Blanking off Plug 1 x Filter)
- Low Level Siphon Pack (Backnut, Siphon Washer, Coupling Nut, Flushpipe Sealing Washer)
- Basin Waste (1 x Chrome Blanking off Plug)
- Instruction Leaflet

## FINAL COMMISSIONING

- Before turning on the water supply, check all components are free moving and all joints are correctly made.
- Fill the cistern with water and carefully check for leaks.
- Test the overflow by holding the float down, ensure that incoming water is completely discharged, if not partially close the isolation valve (not supplied) and try again, repeat until all incoming water is discharged.
- Check that the inlet valve shuts off on the water line indicated inside the cistern.

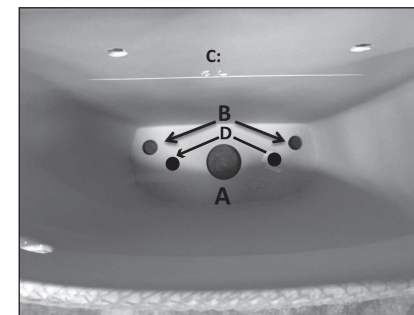

- A Siphon/Valve Outlet
- B Holes for Bottom Inlet Valve (left or right)
- C Low level waterline 160mm  
Close coupled waterline 200mm
- D Bolted Close Coupling Kit



Billingham, TS23 4BX  
T: 01642 710719 F: 01642 710720  
E: sales@nymas.co.uk  
www.nymas.co.uk

Code	240467
Issue No.	4
Date	31/01/19

## Close Coupled - Bolted Kit

Assemble the 2 bolts (diagram 4). Feed both bolts through the respective holes and secure using the metal washer and nut (diagram 1).

The complete assembly of the bolted kit is shown in diagram 4. Place the rubber washer over the threads of the siphon (diagram 2). Feed siphon through hole in cistern. Secure hand tight using back-nut provided (diagram 3). Tighten a further half turn using a suitable spanner.

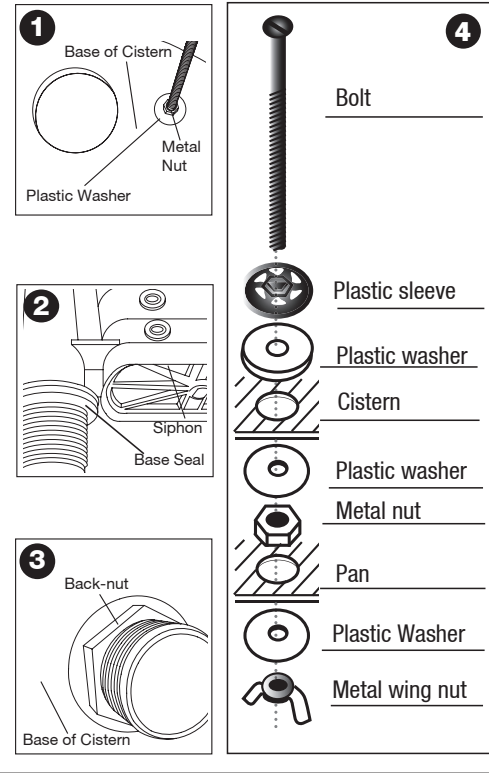

## LOW LEVEL

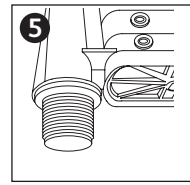

For low level packs, place the rubber washer over the threads of the siphon (diagram 5). Feed through the hole in cistern. Secure hand tight using back-nut provided (diagram 6). Tighten a further half turn using a suitable spanner. The flushpipe assembly is shown below.

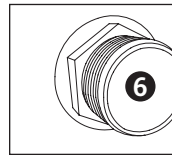

When fitting either seal, ensure that the rounded edge on the low level seal is pointing towards the end of the flushpipe that is to be inserted into the threads of the siphon (do not insert more than 40mm into the tail of the siphon).

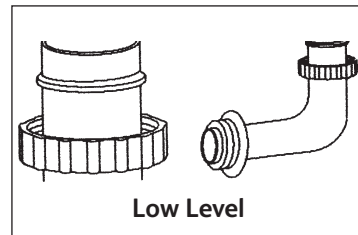

## JOLLYFILL TELESCOPIC BOTTOM ENTRY INLET VALVE

### A : PRE-INSTALLATION

- 1 Turn off water supply to cistern and remove cistern lid.
- 2 Flush the cistern and remove any loose dirt from inside the tank.
- 3 Disconnect and remove the existing inlet valve.

### B : INSTALLATION

- 1 Insert correct filter restrictor into threaded tail.

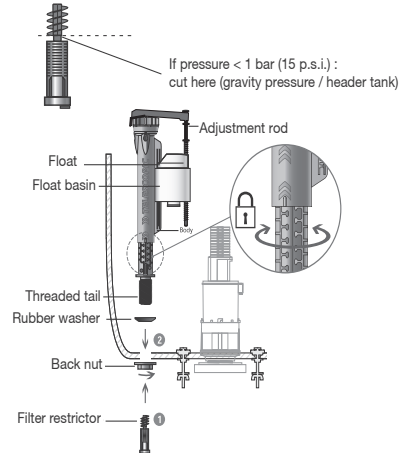

- 2 Fit the filling valve. Ensure that the valve does not obstruct the flush mechanism. Do not overtighten the back nut

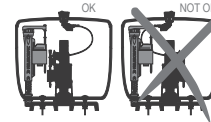

- 3 Important for new installations : before turning water on, ensure that one cold water tap is open so that dirt and loose particles in the pipe work are flushed through the tap (we also recommend to flush through the water supply pipe to the cistern before connection is made).

- 4 Connect water supply.
- 5 Turn on the water supply and allow the cistern to fill.

- A Adjust the water level.

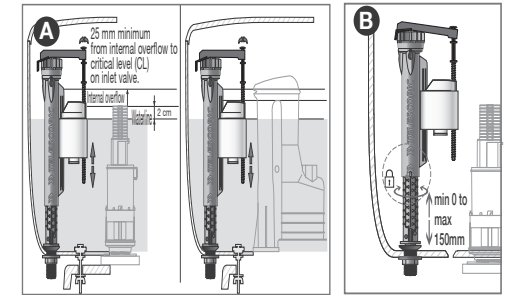

- B If the water level is not correct, turn off water supply. Adjust the water level by : Turning slowly right or left to open. Pulling up the body of the telescopic part, (see pic B). Turning slowly right or left to lock. Turn on water supply.

- C You can precisely adjust the float basin with the red rod. Unclip the red rod. Adjust the float basin. Clip the red rod.

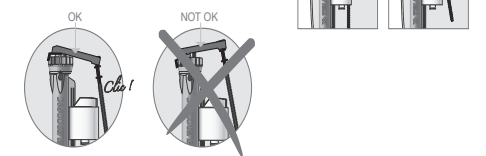

## TROUBLE SHOOTING MAINTENANCE FOR JOLLYFILL SIDE AND BOTTOM ENTRY VALVES

Turn off water supply before any maintenance is carried out.

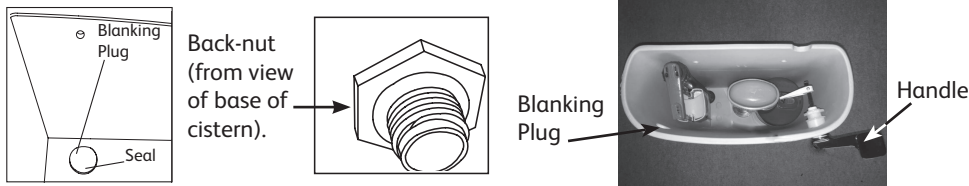
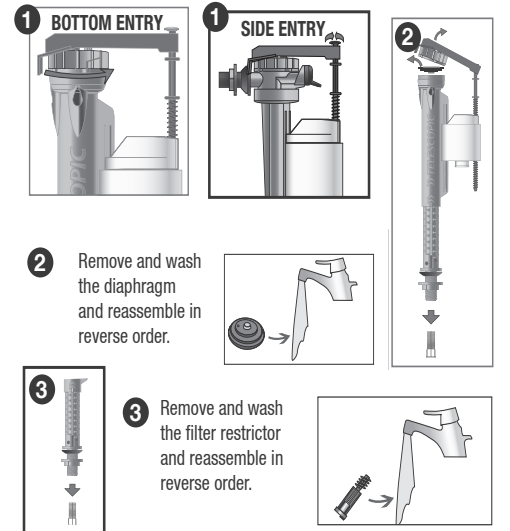

### PLEASE NOTE:

Blanking plug must be fitted in handle hole not being used.

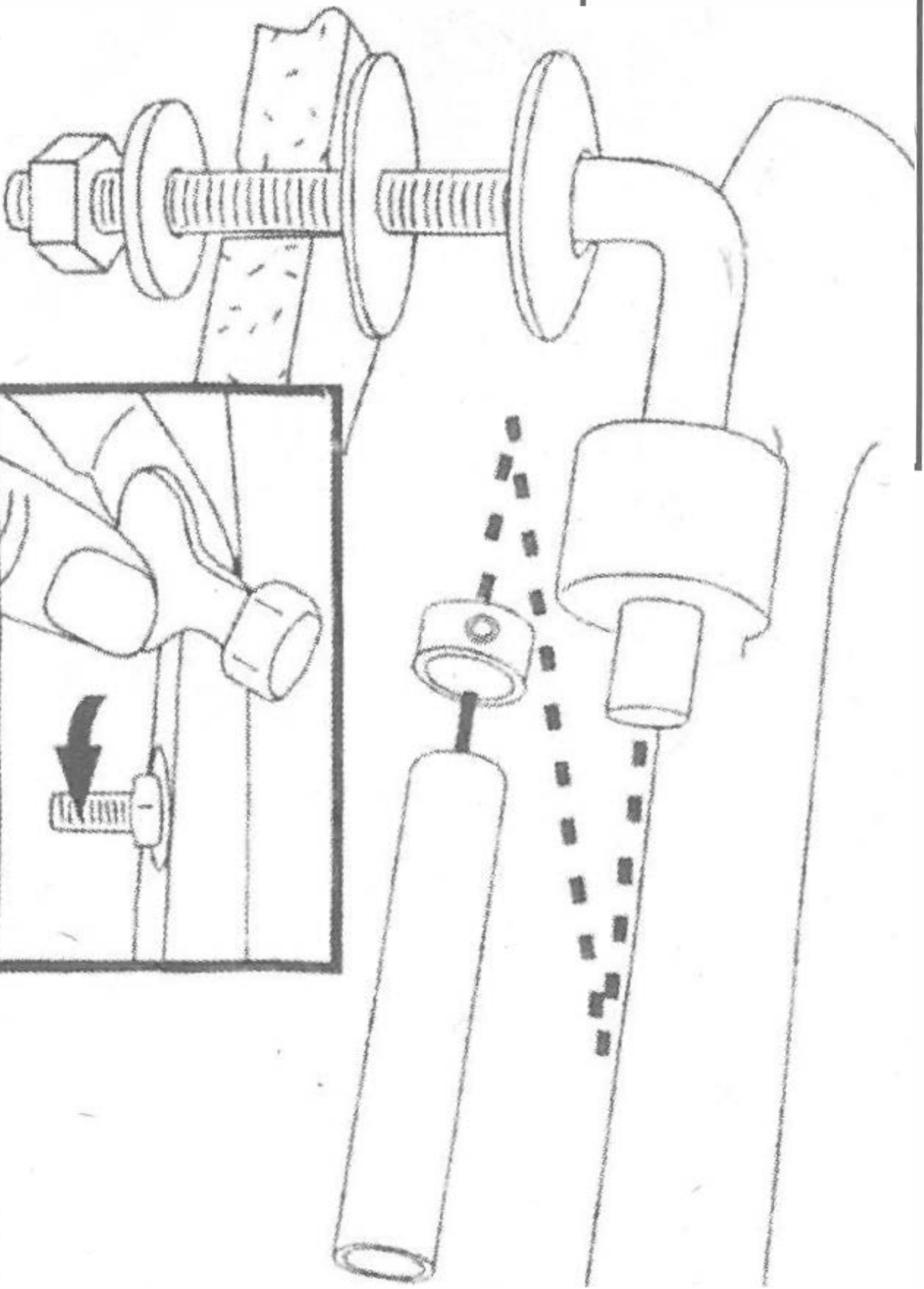
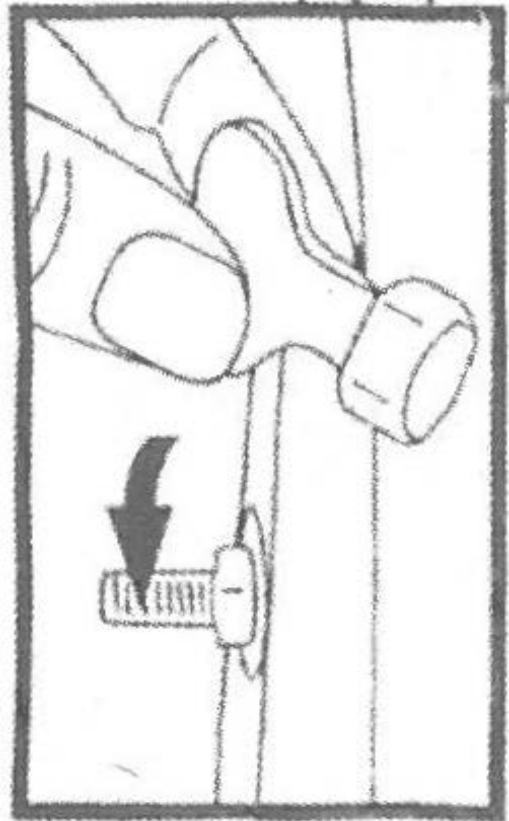

FSS13SS

## **Check out our full range of Bathroom Suites**

Bathroom Suites By Range

Cloakroom Suites

Toilets

Bathroom Sinks / Wash Basins

Bidets

Baths

## **Wide variety of toilets**

Close Coupled Toilets

Wall Hung Toilets

Back To Wall Toilets

Furniture unit toilets

## **Huge Selection of Baths**

Acrylic Baths

Steel Baths

Shower baths

Freestanding baths

Small baths

Corner baths

Whirlpool baths

## **Don't forget the important bathroom suite extras**

Bath panels

Toilet seats

**plumbworld**  
**Big brands, small prices.**